

BUYERS GUIDE

Public Auction Sale

Complete Closure of North America's Largest PCB Manufacturer



31 Sea Cliff Avenue
Glen Cove, NY

Sale Date – Day Two

Thurs. ~ June 7, 2007 ~ 9:00 a.m. (EST)

Preview

Mon. ~ June 4, 2007 ~ 9:00 a.m. ~ 4:00 p.m.

Tue. ~ June 5, 2007 ~ 9:00 a.m. ~ 4:00 p.m.

Auction Managed And Conducted By:

 **The
BRANFORD Group™**
Trusted Auctioneers and Appraisers

896 Main Street, Branford, CT 06405
Phone: (203) 488-7020 Fax: (203) 488-4577
www.TheBranfordGroup.com

Set forth below are the terms and conditions (the "Terms") that shall apply to any purchase by any party (a "Buyer") either directly Branford Auctions, LLC ("TBG") or in a transaction (a "Transaction") in which TBG serves as broker, agent, liquidator or auctioneer for any third party owner. The Terms apply to all Transactions, including without limitation, public auctions conducted by TBG and direct purchases by Buyer of any item either before, after or independent of any public auction.

1. All machinery, equipment, merchandise and other items (the "Goods") are sold on an "AS IS/WHERE IS" basis with no warranties or representations whatsoever either expressed or implied. WITHOUT LIMITING THE GENERALITY OF THE FOREGOING, THE WARRANTIES OF FITNESS FOR A PARTICULAR PURPOSE AND MERCHANTABILITY are expressly disclaimed.
2. Buyer must register and pay a deposit prior to any auction sale. The deposit will be returned to Buyer in its original form if Buyer is not the successful bidder at the auction. If Buyer is the successful bidder, TBG will (so long as the deposit complies with the requirements of this paragraph) apply the deposit toward the purchase price due from Buyer. TBG must receive a deposit of not less than twenty five percent (25%) of the MAXIMUM AMOUNT YOU WILL SPEND AT AUCTION and must receive the balance of the total purchase price no later than the close of business on the day following the auction (the "Final Payment Date"). All payments must be in cash, cashier's or certified check, federal wire transfer of immediately available funds or a corporate check accompanied with a bank letter of guarantee, and all of the foregoing must be in form, scope and substance acceptable to TBG. WE DO NOT ACCEPT CREDIT CARDS. Without limiting TBG'S discretion, no corporate checks without a bank guarantee and no personal checks will be accepted. No title shall pass to Buyer until the total purchase price and all Taxes have been paid to TBG in collected funds.
3. Buyer must also pay to TBG on or before the Final Payment Date, all sales, export, use and other taxes due to any federal, state or local taxing authority (the "Taxes") as a result of Buyer's purchase, including without limitation, any taxes arising from any Buyer's Premium (as defined below). To receive the benefit of any tax exemption, Buyer must supply TBG with a sales tax exemption certificate acceptable in form, scope and substance to TBG in TBG'S sole discretion.
4. TBG in its sole discretion may impose a buyer's premium ("Buyer's Premium") on any Goods sold. The Buyer's Premium is a percentage that is added to the final purchase price of any item. TBG shall charge and collect from each successful bidder a 12.5% buyer's premium for each sale at the auction, in addition to the purchase price as bid. Webcast bidders will be charged a 15.0% Buyer's Premium.
5. Buyer must remove all Goods purchased before the final removal date and time (1) announced by TBG at the auction (the "Removal Date"). No Goods shall be removed until (2) the full purchase price and all applicable taxes thereon have been received by TBG in the form required herein. Any Goods not removed on or before the Removal Date shall be subject to storage charges that TBG may in its discretion impose. Any items not removed on or before the Removal Date shall be deemed abandoned and TBG shall have no further obligation to Buyer with respect to such items. (See also #7. SMALL LOT REMOVAL.)
6. Buyer shall be responsible for the safe and proper removal of any Goods purchased by Buyer. Goods weighing more than 100 pounds must be removed by a qualified, insured rigger. Before any removal, Buyer must provide TBG with a certificate of insurance from the rigger, which certificate must be in form, scope and content acceptable to TBG in TBG'S sole discretion. Without limiting TBG'S discretion, such certificate must show that the rigger carries comprehensive liability insurance written by an insurance carrier of national standing and in an amount of not less than two million dollars (\$2,000,000.00). Without limiting the generality of the foregoing, Buyer shall restore and repair all real and personal property that is altered or damaged as a result of Buyer's removal of the Goods. TBG shall have no responsibility to disconnect utilities to the sold asset, including electric, gas, waste and water lines. Buyer does hereby indemnify TBG, the owner of the Goods and the owner of the premises in which the Goods are located, from any and all claims, damages, and losses arising from Buyer's actions or actions with respect to the Goods and Buyer's presence on the premises in which the Goods are located, including without limitation, injuries to persons or property and environmental violations or contamination. Risk of loss on any Goods shall pass to the Buyer upon payment in full to TBG of all sums due from Buyer in respect to the Goods.
7. TBG shall have no responsibility whatsoever for any items that can be removed by hand if such items remain in the premises where the auction is conducted for more than forty-eight (48) hours after the auction.
8. After Buyer has removed any item from TBG'S possession, TBG shall have no obligation to make any adjustment or accommodation to Buyer because of any mistake in quantity or other defect or problem with

respect to such item. Buyer must make all requests for adjustments in writing to TBG before any item is removed from the premises where the auction is conducted.

9. TBG shall not be responsible for any damages, loss or theft of Goods except in the case of TBG'S willful misconduct. Without limiting the foregoing, TBG shall not be responsible for damages or losses caused by strikes, civil disorders, or acts of God.
10. If for any reason TBG is unable to deliver any Goods purchased by Buyer, TBG'S sole liability shall be to return all sums paid by Buyer to TBG in respect of such Goods.
11. TBG, in its sole discretion, reserves the right to establish a reserve or minimum price on any Goods without having to announce post or publish notice to attendees and buyers at any auction. TBG reserves the right to confirm or reject the final bid.
12. TBG, in its sole discretion, reserves the right to refuse the bid of any person without providing any notice or reason therefore.
13. TBG, in its sole discretion, shall control all bidding increments and advances at any auction. In the event of any dispute concerning the winning bid price for an asset, the record kept by TBG shall control.
14. TBG reserves the right, in its sole discretion, to sell items advertised as a public auction sale, on a piece by piece basis or as a complete lot. Without limiting the generality of the foregoing, TBG may accept a complete lot bid and then conduct an item by item auction which auction shall be effective only if the total proceeds therefrom exceed the amount of the complete bid.
15. All information provided by TBG to Buyers, including without limitation, any advertising, lot sales catalogs or otherwise, is subject to deletions, errors, additions, and changes without notice. Although information is gathered from sources thought to be reliable, TBG shall have no responsibility whatsoever for any information provided to any attendee or buyers. All buyers shall rely solely on their own investigation and inspection of any Goods.
16. The auctioneer may add other terms and conditions of sale, such additional terms and conditions to be announced prior to the auction. The headings contained herein are for convenience only and shall not limit or alter the Terms hereof.
17. If TBG is selling or auctioning any Goods on behalf of a third party owner, TBG shall act as an agent only and shall have no liability whatsoever for the acts of any owner/principal.
18. Buyers agree to comply will all US export control and related laws, and acknowledge that TBG is not the exporter of any purchased item. Certain items offered for sale at the auction may constitute "Restricted Technology." Under federal law, such items may not be shipped outside the United States. TBG makes no representation or warranty concerning, and has conducted no investigation to ascertain which items, if any, constitute Restricted Technology.
19. Buyers acknowledge that an auction site is a potentially dangerous place, Flammable, noxious, corrosive and pressurized substances may be present. Heavy equipment may be operated and electrical circuits may be live. Every person enters the auction site at his or her own risk with notice of the condition of the premises and the activities that will be or have been conducted on the premises. No person shall have any claim against TBG, the seller or their respective agents for any injuries sustained or for damages to or loss of property that may occur at the auction site.
20. If the Buyer fails to comply with any of the Terms, TBG shall have all rights and remedies available to it at law and in equity. Without limiting the generality of the foregoing, TBG may retain all deposits and partial payments received from Buyer and may resell any Goods that Buyer fails to purchase. Buyer shall be responsible for all costs, losses, and damages suffered by TBG (i) as a result of Buyer's breach of any of the Terms, including without limitation, lost profits and consequential damages, and (ii) incurred in connection with the enforcement of TBG'S rights, including, without limitation, legal fees and costs and expenses related to the resale of Goods, including storage and rigging fees.

Photocircuits Two Day Auction- Lot Legend & Schedule

Approximately 2900 Lots to be Offered

Auction Theater & Bidding Arena Location:
31 Sea Cliff Ave, Finance & Purchasing Building

**Attention Bidders: Please note that each building contains an assortment of general plant support lots such as; Forklifts, Pallet Jacks, Compressors, Pumps, Computers, Carts, Cabinets, Furniture, Racks, Lockers, Maintenance Machinery, Ladders, Shelving, Work Bench's, & More*

Day 1, June 6th, Starting @ 9:00am
Lots 1 to 1513 (estimated 1300 lots)

1. Building 45B, Building 45B Storage, Outside Areas of 45B

Testing, QC, Ovens, Air Compressors, Testing Supplies, Parts

- Lots 1 to 315

2. Hazel Street

CNC Drilling, Laser Drilling, X-Ray Drill, Scrubbers, Vacuums, Drill Bits, Air Compressor, Forklifts, Shears

- Lots 401 to 630

3. Building 7

Multilayer, Lamination, Bonding, DES Lines, Exposure Units, AOI, Photo, Forklifts, Air Compressors

- Lots 650 to 950

4. Main Building

CNC Routing & Scoring, Fabrication, Lab, Toolroom, Stamping Presses, Screening, Forklifts

- Lots 1000 to 1513

Day 2, June 7th, Starting @ 9:00am
Lots 1514 to 3678 (estimated 1500 lots)

1. Boiler Room, Chemical Recovery & Waste Treatment

Compressors, Filter Presses Lab, AA, Tanks, Generator, Cooling Tower, Stills, Pumps, Tanks

- Lots 1514 to 1596

2. Butler # 2 Building, Outside Butler 2

Soldermask, Screening, LPI, ENIG, Forklifts, Exposure Units

- Lots 1597 to 1749

3. Maintenance

Machine Tools, Welding, Power Tools, Tooling

- Lots 1750 to 1856

4. Spare Parts Crib

PCB Machine Replacement Parts, Motors, Pumps, Fasteners, Bearings & More

- Lots 1865 to 1899

5. Building 3 & 4

Artwork Generation, Photo Plotters, Exposure Units, Laminators, DES lines, Screen Coating, Forklifts, Air Compressors, Lab, HASL, Timesavers

- Lots 1900 to 2273

6. Building 45A

Tools, Supplies, Shipping, Forklifts, Golf Carts, Pallet Racking, Surplus Machinery, Material Handling

- Lots 2300 to 2540

7. Building 45A Toolroom

Milling Machines, Lathes, Grinders, Welding, Shears, Saws, Tooling

- Lots 2850 to 3000

8. Building 45A Supplies Crib

Misc. Consumables, Office Supplies, Pallet Racking, Forklifts

- Lots 3400 to 3432

9. 31 Sea Cliff-Building 45A Office & Computers

Furniture, Computers, Servers, Printers, Phone System, Conference Rooms, AV Gear

- Lots 3500 to 3678

Lot Legend

- 1 - 297 Building 45B Electrical Test
- 298 - 338 Building 45B Storage Shed
- 400 - 630 Hazel Street Drilling Room
- 660 - 756 Building 7 First Floor (Mass Lamination and Bonding)
- 757 - 908 Building 7 Second Floor (DES, Clean Room Exposure and Inspection)
- 910 - 967 Building 7 Sub-Floor 1 (AOI Room)
- 1000 - 1041 Main Building (Routing, Scoring -Punch Presses) Sub Level 1
- 1042 - 1427 Main Building (Routing, Scoring -Punch Presses) First Floor
- 1428 - 1498 Main Building (Routing, Scoring -Punch Presses) Second Floor
- 1499 - 1513 Main Building (Outside and Tank Farm)
- 1514 - 1565 Chemical Recovery and Boiler Buildings
- 1566 - 1854 Waste Treatment/ Maintenance Shop/ Butler 2 Buildings
- 1855 - 1864 Behind Butler 2 and Maintenance Buildings
- 1865 - 1891 Parts Department
- 1900 - 1979 Building 3 Sub-Level (Artwork Generation)
- 1980 - 2242 Building 4 Second and Third Floors
- 2243 - 2272 Building 3 First Floor
- 2300 - 2484 Building 45A First Floor
- 2500 - 2540 Rolling Stock and Vehicles Located Around Campus
- 2850 - 2997 Building 45A Tool Room
- 3400 - 3432 Building 45A Commodities Room
- 3450 - 3465 Storage Shed Outside of Building 2
- 3600 - 3683 Office Area - IT Equipment Located in Building 45A

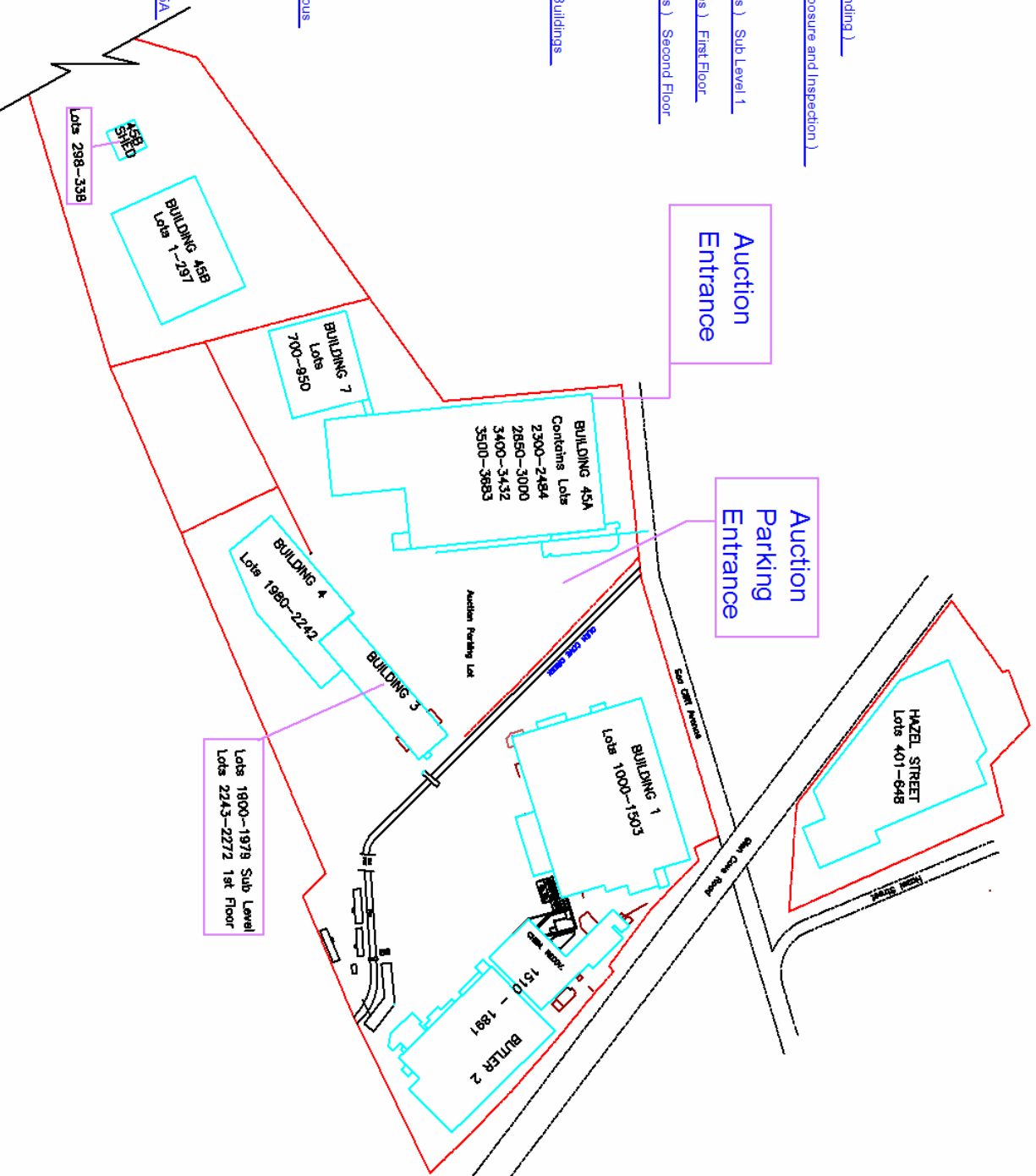

PAYMENT TERMS & CONDITIONS

1. A deposit to The Branford Group is required prior to the auction sale. The deposit will be returned in its original form if Buyer is not the successful bidder at the auction. If Buyer is the successful bidder, THE BRANFORD GROUP will apply the deposit to the purchase price.
2. All deposits and payments must be in cash, cashiers check, certified funds, or wire transfer. Company checks will only be accepted with a bank letter of accommodation guaranteeing THE BRANFORD GROUP unqualified payment. No personal checks or credit cards will be accepted. NO EXCEPTIONS!
3. A 25% deposit on all purchases is due on the day of the auction.
4. **Payment must be paid in full by Monday June 11, 2007 no later than 4:00 p.m. All payments are collected in U. S. Dollars only.**
5. No items can be removed unless your invoice is paid in full.
6. State sales tax will be added to your purchase unless we are provided with a valid sales tax exemption certificate.

BUYER'S PREMIUM

A 12.5% Buyer's Premium will apply to your purchases at this sale if you are an onsite buyer and a 15.0% Buyer's Premium will apply to all buyers over the Internet.

REMOVAL HOURS AND DATES

Removal will be from Friday, June 8, 2007 until Friday, June 22, 2007 for small lots. Machinery and Equipment Removal will be from Friday June 8, 2007 until Friday July 13, 2007. Removal hours will be from 8:00 a.m. until 4:00 p.m., Monday Through Friday. **There will be no removal on Saturday and Sunday.**

RIGGERS AND MOVERS

MTI Worldwide Logistics. 6308 Benjamin Road, Tampa FL 33634. Phone:813-880-8878, Fax:813-880-8869 Cell:813-943-6195 Email:Mark.Perez@MTI-Worldwide.com Web Site:www.mti-worldwide.com

All contracted riggers and movers must have an insurance certificate on file with THE BRANFORD GROUP with a minimum of \$2,000,000 in liability and damage coverage.

REMOVAL PROCEDURE

1. Pay your invoice in full. Once you do, you will be given a “paid in full” copy of your invoice. Invoice must be paid in full prior to removing any items. NO EXCEPTIONS.
2. Return to the auction site during removal hours with the “paid in full” copy of your invoice, or make sure a company representative has the paid copy.
3. You will then be paired up with a representative from THE BRANFORD GROUP, who will proceed to check out and allow you to remove all of the items you purchased at the auction.
4. If you are unable to remove all of your items in one day, be sure to bring the “paid in full” copy of your invoice with you when you return. This is the only way THE BRANFORD GROUP can be sure of which items you have already removed.
5. NO MERCHANDISE WILL BE RELEASED DURING THE AUCTION SALE.
6. NO EXCEPTIONS! NO MERCHANDISE WILL BE RELEASED UNLESS BUYER, RIGGER, OR BUYER’S AGENT PROVIDES THE BRANFORD GROUP WITH THE “PAID IN FULL” OF BUYER’S INVOICE, SIGNIFYING PAYMENT IN FULL.

ADDITIONAL CHECK-OUT PROCEDURES

1. Buyer is responsible for providing his own forklifts and material handling equipment to be used in the removal of Buyer's lots. Material handling equipment sold at this auction may not be used in the removal of lots unless you were the successful Buyer of said material handling equipment.
2. Small Lot Removal: THE BRANFORD GROUP is not responsible for any missing or lost small lots if they have not been removed within 48 hours of the close of the auction. There is NO removal of any lots until the auction is complete.
3. It is solely the Buyer's responsibility to properly remove all fluids, oils, hazardous chemicals, etc., from machinery purchased at this auction. All oils should be properly stored in the appropriate containers (sealed drums).
4. All lots must be removed no later than Friday, June 8, 2007 until Friday, June 22, 2007 for small lots. Machinery and Equipment Removal will be from Friday June 8, 2007 until Friday July 13, 2007. Failure to remove all lots by this date results in Buyer's violation of the terms of the auction sale, providing THE BRANFORD GROUP with the right to exercise any options. Buyer will be solely responsible for all costs of these options, including but not limited to, a late charge of \$500.00 per day and expenses incurred by THE BRANFORD GROUP personnel if it is necessary to return to the sale site after the removal deadline.
5. Each buyer or agent should inspect his purchases before the product leaves the premises. The Branford Group takes no responsibility for shortages or differences in counts or any liability resulting from claims for loss of and/or missing product upon arrival at buyer's destination.

WIRE TRANSFER INSTRUCTIONS

IMPORTANT: INDICATE THE "AUCTION NAME" IN THE WIRE TRANSFER DETAILS

Date: _____

Account Name: The Branford Group Client Account
The Branford Industrial Group, LLC
Account Number 9522973767
Bank Name Bank of America, 157 Church Street, New Haven, CT 06510
Routing Number 026009593
Swift Number BOFAUS3N

Special Instructions:

Auction Name: _____

Buyer Name: _____

Buyer Number: _____

IMPORTANT: INDICATE THE "AUCTION NAME" IN THE WIRE TRANSFER DETAILS

AUCTION NAME:	
----------------------	--

PROXY BID FORM

DATE		BUYER #	
COMPANY			
ADDRESS			
E-MAIL ADDRESS			
TELEPHONE			
FAX			

LOT #	ITEM DESCRIPTION	QTY	AMOUNT
			USD
			USD
			USD
			USD
			USD
			USD
			USD
			USD
			USD
		TOTAL	USD

The undersigned, hereby appoints The Branford Group to be my agent and proxy for the sole purpose of purchasing the above items listed on my behalf, in my absence. I/we acknowledge that I/we have read and are familiar and agree to comply with the terms and conditions pertaining to this auction.

SIGNATURE

DATE

AGENT RELEASE AUTHORIZATION

If someone other than the registered bidder will be removing equipment, please complete this form to designate an Authorized Agent. Please indicate an Authorized Agent for each location from which you purchased equipment.

I hereby authorize The Branford Group, LLC. to release any items purchased by me (as enumerated on my invoice, which is available by contacting The Branford Group at 203-488-7020) to the person(s) or companies listed below.

I do hereby authorize each Authorized Agent to act as my attorney-in-fact with the limited power of attorney to execute on my behalf any and all documents, including but not necessarily limited to, invoices, bills of lading, terms and conditions, and shipping manifests, with respect to the purchase, dismantling and removal of the above referenced assets from sale conducted by The Branford Group.

Sale Name: _____ Date: _____
 Bidder Name _____ Bidder# _____
 Title _____
 Company _____

Location 1 (Building/ Street/ City/ State/ Country) _____ Authorized Agent Company/ Name _____	Location 2 (Building/ Street/ City/ State/ Country) _____ Authorized Agent Company/ Name _____
Location 3 (Building/ Street/ City/ State/ Country) _____ Authorized Agent Company/ Name _____	Location 4 (Building/ Street/ City/ State/ Country) _____ Authorized Agent Company/ Name _____

NOTE: Equipment will NOT be released to any party until:

- 1) The invoice, which lists the equipment purchased and corresponding lot numbers, is paid in full
- 2) The bidder or Authorized Agent legibly signs a copy of the invoice with the following stipulation. NOTE: The signatory must be the bidder or an Authorized Agent.
 "I acknowledge receipt of the above items, and agree that all purchases are made "AS IS," "WHERE IS" and "WITH ALL FAULTS" and subject to Auctioneer's Terms and Conditions. Positively no refunds or credits for shortages or claims will be considered after goods leave the premises. I acknowledge that I am duly authorized to sign this invoice as or on behalf of the stated purchaser."

Before allowing them to sign a copy of your invoice, please make sure your designated agent(s) are familiar with the equipment to be removed. They should collect all pieces and parts and confirm advertised features. Once the invoice is signed, The Branford Group is released of liability. No credits will be issued for incomplete lots.

SAMPLE BANK LETTER OF ACCOMMODATION

(TO BE PUT ON BANK STATIONARY)

Date: _____

To Whom It May Concern:

This Bank unconditionally guarantees payment in U.S. funds to The Branford Group, LLC from: _____

(Name of Customer)

**Drawn on Account # _____ Up to the amount of
\$ _____**

This letter is valid for purchases at the auction of: _____

Date of Auction: _____

These funds will be made available to The Branford Group, LLC for a time period of up to 10 business days or until the check clears.

(Name of Bank)

Its: _____

**Report of Cash Payments Over \$10,000
Received in a Trade or Business**

See instructions for definition of cash.

Use this form in transactions occurring after December 31, 2001. Do not use prior versions after this date.
For Privacy Act and Paperwork Reduction Act Notice, see page 4.

1 Check appropriate boxes if: a Amends prior report; b Suspicious transaction.

Part I Identity of Individual From Whom the Cash Was Received

2 If more than one individual is involved, check here and see instructions

3 Last name 4 First name 5 MI 6 Taxpayer identification number

7 Address (number, street, and apt. or suite no.) 8 Date of birth (see instructions)

9 City 10 State 11 ZIP code 12 Country (if not U.S.) 13 Occupation, profession, or business

14 Document used to verify identity: a Describe identification b Issued by c Number

Part II Person on Whose Behalf This Transaction Was Conducted

15 If this transaction was conducted on behalf of more than one person, check here and see instructions

16 Individual's last name or Organization's name 17 First name 18 MI 19 Taxpayer identification number

20 Doing business as (DBA) name (see instructions) Employer identification number

21 Address (number, street, and apt. or suite no.) 22 Occupation, profession, or business

23 City 24 State 25 ZIP code 26 Country (if not U.S.)

27 Alien identification: a Describe identification b Issued by c Number

Part III Description of Transaction and Method of Payment

28 Date cash received 29 Total cash received 30 If cash was received in more than one payment, check here 31 Total price if different from item 29

32 Amount of cash received in U.S. dollar equivalent must equal item 29 (see instructions):

- a U.S. currency \$.00 (Amount in \$100 bills or higher \$.00)
 - b Foreign currency \$.00 (Country is)
 - c Cashier's check(s) \$.00
 - d Money order(s) \$.00
 - e Bank draft(s) \$.00
 - f Traveler's check(s) \$.00
- Issuer's name(s) and serial number(s) of the monetary instrument(s) is

33 Type of transaction: a Personal property purchased, b Real property purchased, c Personal services provided, d Business services provided, e Intangible property purchased, f Debt obligations paid, g Exchange of cash, h Escrow or trust funds, i Bail received by court clerk, j Other (specify)

34 Specific description of property or service shown in 33. (Give serial or registration number, address, docket number, etc.)

Part IV Business That Received Cash

35 Name of business that received cash 36 Employer identification number

37 Address (number, street, and apt. or suite no.) 38 Social security number

39 City 39 State 40 ZIP code 41 Nature of your business

42 Under penalties of perjury, I declare that to the best of my knowledge the information I have furnished above is true, correct, and complete.

Signature Authorized official Title

43 Date of signature 44 Type or print name of contact person 45 Contact telephone number

CATALOG FOR PHOTOCIRCUITS

Lot	Description
1513A	_____ SALE NOW CONTINUES IN THE CHEMICAL RECOVERY & BOILER BUILDINGS (LOTS 1514 - 1565)
1514	_____ Little Still Model LS-55BV Steam and Vacuum Distillation Units
1515	_____ Little Still Model LS-55BV Steam and Vacuum Distillation Units
1516	_____ Little Still Model LS-55BV Steam and Vacuum Distillation Units
1517	_____ Little Still Model LS-55BV Steam and Vacuum Distillation Units
1518	_____ PRI Progressive Recovery Vacuum and Steam Distillation Unit, Semi Automatic, Bottom Discharge
1519	_____ (2) Diaphragm Pumps, (1) Serfilco Filter Unit, (3) Vacuum Pumps w/ Enclosure
1520	_____ 400 Amp Arc Welder
1521	_____ Justrite 2-Door Flammable Storage Cabinet, Banding Cart w/ Associated Tools
1522	_____ Gold Reclamation Tank System Consisting of (6) Polypropylene Tanks
1523	_____ CM Lodestar Electric Automatic Hoist, 1-Ton Cap.
1524	_____ (2) 2-Door Storage Cabinets w/ Applicable Contents, (1) 4-Drawer Vertical Fireproof File Cabinet, (1) 4-Drawer Vertical File Cabinet, (1) Wood Top Shop Workbench, (1) Diagraph Stenciling Unit
1525	_____ Labconco Laboratory Hood w/ Laboratory Cabinetry, (2) Cimarec Thermolyne Lab Stirrers, (1) Phipps & Bird Model DB700 Jartester, (1) Thermolyne Type 1000 Stir Plate
1526	_____ Harrington Fume Scrubber w/ Polypropylene Tank
1527	_____ Harrington Fume Scrubber w/ Approx. 500 Gallon Fiberglass Tank, (1) Polypropylene Tank w/ Stand
1528	_____ CM Lodestar Series 535 1-Ton Electric Chain Hoist, (1) CM Shop Star 1/4 Ton Electric Chain Hoist w/ Rail
1529	_____ Lot of (4) Polypropylene Tanks
1530	_____ Famco 36" Electric Shear, 16-Gauge Steel Cap.
1531	_____ (2) Sections of Medium Duty Pallet Racking Consisting of: (4) Uprights, (12) Crossmembers, Associated Decking w/ Applicable Contents, (1) 6-Step Roll About Staircase, (1) Barrel Cart, (1) Industrial Hand Truck
1532	_____ Contents of (2) Offices Including: (1) Dell Optiplex Model GX1 Tower Computer w/ 3.5" Floppy, CD Rom, Gateway Model VX700 17" Color Monitor, Keyboard, Mouse, (2) Desks, (1) Upholstered Swivel Arm Chair, (2) 4-Drawer Vertical File Cabinets, (1) GE Profile Sensor Microwave Oven, (1) Refrigerator
1533	_____ 6,000 Gallon Stainless Steel Tank
1534	_____ (2) 2,000 Gallon Fiberglass Tanks, (1) 2,000 Gallon Polypropylene Tanks, (1) Associated Scaffolding
1535	_____ Lanco Filter Press w/ (9) Filters
1536	_____ Lot of (11) Diaphragm Pumps Consisting of Mfgs by Wilden, etc, (1) Metpro Sethco Filter Unit

This catalog is a guide. The Auctioneers do not warrant the accuracy, genuineness, authenticity, description, weight, count or measure of any of the lots specified herein.

CATALOG FOR PHOTOCIRCUITS

Lot	Description
1537	_____ 200 Gallon Polypropylene Tank, (1) Wilden Diaphragm Pump, (1) Filter Unit
1538	_____ 4,300 Gallon Fiberglass Storage Tank, (1) 3,965 Gallon Fiberglass Storage Tank
1539	_____ 6,000 Gallon Polypropylene Storage Tank, (1) 4,300 Gallon Polypropylene Storage Tank
1540	_____ Heavy Duty Gang Box
1541	_____ Rol-Lift Hydraulic Pallet Jack
1542	_____ Hydraulic Pallet Jack
1543	_____ Louisville 12' Fiberglass Step Ladder, (1) Louisville 10' Fiberglass Step Ladder
1544	_____ Louisville 8' Fiberglass Folding Step Ladder, (1) Alco-Lite Type 1A 8' Aluminum Folding Step Ladder
1545	_____ 28' Fiberglass Extension Ladder, (1) Warner 20' Aluminum Extension Ladder
1546	_____ Approx. (5) Wilden Diaphragm Pumps, (2) 1/2 hp March Model TE-6KMD Vacuum Pumps, (LOCATED IN TANK FARM)
1547	_____ (2) 55-Gallon Pneumatic Vacuums, (1) Industrial Shop Vac
1548	_____ Ingersoll Rand Closed Loop Cooling System Model ACE 135A2, s/n 79811-D, w/ Ingersoll Rand (2) 20 HP Electric Motors, Control Panel Located Inside Boiler Room, s/n 92072A
1549	_____ Louisville 8' Folding Fiberglass Ladder, (1) Werner Ultra Pro Series 8' Folding Step Ladder, (1) Platform Manlift
1550	_____ Craftsman Professional Vertical Air Compressor, 6.5 hp/60-Gallon, 240 Volt
1551	_____ Ingersoll Rand 800 hp Air Compressor, Model 80-99, s/n AE12582-01-1
1552	_____ Atlas Copco Model VT245-125 60 hp Air Compressor, s/n 88.520/430-03, Type 1900-0430-03
1553	_____ Hankison Compressor Air Dryer, LCD Readout Model HD4000, s/n 1238950-04/05-1, Rated Cap. 4,000 SCFM @ 100 PSIG, 100 Degrees F
1554	_____ Empire Generator, s/n 340-102, 75 kw, 1800 RPM
1555	_____ 40 hp Spencer Air Blower
1556	_____ 40 hp Spencer Air Blower
1557	_____ Approx. 500 Gallon Air Expansion Storage Tank
1558	_____ (2) Culligan Water Softeners w/ Receiver Tank, Controls
1559	_____ Lot of (3) Polypropylene Chemical Water Purification Units w/ (4) LMI Metering Pumps
1560	_____ (3) 2-Door Vertical Storage Cabinets w/ Applicable Contents, (3) Portable Staircases, (1) Mechanics Roll About Tool Cart, Multi-Drawer, (1) Metal Foremans Desk, (1) 2-Door Metal Workbench w/ Hi-Duty Vise #4, (2) Roll About Metro Carts

This catalog is a guide. The Auctioneers do not warrant the accuracy, genuineness, authenticity, description, weight, count or measure of any of the lots specified herein.

CATALOG FOR PHOTOCIRCUITS

Lot	Description
1561	_____ 1966 Cleaver Brooks Dual Fuel Gas/Oil Fired Boiler, Model CBA28-350, 350 hp, 220 psi, s/n 1-39586
1562	_____ 1966 Cleaver Brooks Dual Fuel Gas/Oil Fired Boiler, Model n/a, 350 hp, 220 psi, s/n n/a
1563	_____ Approx. 500 Gallon Water Receiver Tank w/ (3) Motorized Pumps
1564	_____ (3) Motorized Fuel Oil Boiler Pumping System w/ Filters
1565	_____ 1986 Ace Buehler 460 Gallon Electric Hot Water Heater
1565A	_____ SALE WILL CONTINUE IN WASTE TREATMENT, BUILDING 2, PARTS & MAINTENANCE (LOTS 1566 - 1891)
1566	_____ (6) Equalization Surge Tanks, (4) @ 15,000 Gallon, (2) @ 10,000 Gallons, Associated Controls, Chart Readers, Foxborough and Signet LED Readout Controls, Gateway 2000 Computer w/ CD Rom, 3.5" Floppy, Dell 17" Color Monitor, Keyboard, Mouse, w/ Associated Wilden Vacuum Pumps
1567	_____ (2) Stripper Treatment Tanks, 8,000 Gallons Each, (1) Storage Tank 8,000 Gallons w/ Associated Wilden Vacuum Pumps
1568	_____ (3) Pre-treatment Tanks, (1) 6,000 Gallon, (2) 1,500 Gallon w/ Scaffolding w/ Associated Wilden Vacuum Pumps
1569	_____ (1) 900 Gallon Per Minute Clarifier w/ (4) Sludge Cones, Associated Wilden Diaphragm Filters
1570	_____ (1) 900 Gallon Per Minute Clarifier w/ (4) Sludge Cones, Associated Wilden Diaphragm Filters
1571	_____ (2) Large Sand Filters w/ Associated Wilden Diaphragm Pumps
1572	_____ (2) PH Adjustment Tanks, (1) 8,000 Gallon, (2) 5,000 Gallon
1573	_____ Sperry Filter Press, 19-Plate w/ Autoplate Shifter, Scaffolding
1574	_____ (2) Poly Mixing Tanks, (1) 250 Gallon, (1) 500 Gallon w/ Alsop Mixer, Lightning Mixer w/ Associated Wilden Diaphragm Pumps
1575	_____ (2) Polymer Mixing Tanks w/ Lightning Mixers, Pro Flow Controller w/ Allyn Bradley Micro Vu LCD Readout Controller w/ Associated Wilden Diaphragm Pumps
1576	_____ Sulfuric Acid Feed System w/ Sulfuric Pumps w/ Associated Wilden Diaphragm Pumps
1577	_____ Snyder Crown Polyethylene Tanks w/ Sumo Fittings, (1) 8,400 Gallon, (1) 4,500 Gallon w/ Associated Wilden Diaphragm Pumps
1578	_____ (2) Polypropylene Mixing Tanks w/ Lightning Mixers, (1) 300 Gallon, (1) 200 Gallon w/ Associated Wilden Diaphragm Pumps
1579	_____ (2) Fiberglass Chemical Mix Tanks, 1460 Gallon Each w/ Associated Wilden Diaphragm Pumps
1580	_____ (1) Fiberglass Sludge Tank, 6,000 Gallon w/ Associated Wilden Diaphragm Pumps

This catalog is a guide. The Auctioneers do not warrant the accuracy, genuineness, authenticity, description, weight, count or measure of any of the lots specified herein.

CATALOG FOR PHOTOCIRCUITS

Lot	Description
1581	_____ (3) Polypropylene Holding Tanks, (1) 500 Gallon, (2) 250 Gallon w/ Associated Wilden Diaphragm Pumps
1582	_____ Sperry Filter Press, Approx. (49) Plates
1583	_____ Sperry Filter Press, Approx. (50/60) Plates
1584	_____ Lot of (6) Assorted Size Wilden Diaphragm Pumps
1585	_____ Lot of (6) 55-Gallon Drum Carts, (3) 55-Gallon Drum Cart Cradles
1586	_____ (1) Lightning Mixer, (1) Pro-Minent Vario Model Vambo 7063PP1, s/n 9706082 Electric Pump/Vacuum Pump
1587	_____ ISCO Model 6700 Water Treatment/Sampling Unit
1588	_____ Cotterman Model Maxi-Lift Portable and Stationary Motorized Manlift w/ Outriggers
1589	_____ Perkin Elmer Model AAnalyst 200 Atomic Absorption Spectrophotometer
1590	_____ Perkin Elmer Atomic Absorption Spectrophotometer w/ Gateway Tower Computer w/ CD Rom, 3.5" Floppy, Gateway 15" Color Monitor, Keyboard, Mouse
1591	_____ Accumet Model 25 PH/Ion Meter, LCD Readout, (2) Cimarec II Thermolyne Stirrer/Hot Plates, APC Smart UPS 700 Uninterruptible Power Supply, (1) Chemical Store Station, Small Table Top Lab Hood/Light Unit
1592	_____ Fisher Scientific Table Top Lab Oven, (1) Sampia Desiccant Cabinet, (1) Fisher Scientific Stainless Steel Desiccant Cabinet, (1) CEM Model MDS 2100 Programmable Microwave Oven
1593	_____ Sartorius Model R200D Laboratory Gram Scale w/ LCD Readout
1594	_____ Thermolyne Cimarac Hot Plate/Stirrer, (1) Accumet Model 25 PH/Ion Meter w/ LCD Readout, (1) Labconco Protector Lab Hood, (1) Lab Exhaust Hood w/ Contents and Cabinetry
1595	_____ Hach Model VR-2000 Direct Reading Spectrophotometer, (1) Oakton PH/MV/ION/C-Meter, (1) Lurex Scientific Traube Stalagmometer, (1) Set of Probimers
1596	_____ Balance of Contents of Room Including: All Associated Lab Furniture, Counters, Hanging Shelving Units, Dell Optiplex GX1 Tower Computer w/ CD Rom, 3.5" Floppy, Dell 15" Color Monitor, Keyboard, Mouse, (1) Spectronic Model 20 Absorption Meter, (1) Gateway Pentium Computer w/ CD Rom, 3.5" Floppy, Dell 15" Color Monitor, Keyboard, Mouse, (1) HP Laserjet 6 MP Laser Printer, Lab Pipette Holders, Assorted Lab Glassware
1597	_____ Integrated Process Systems Enig-Electroless Nickel Gold Line, s/n DD00003 w/ Associated Racks, (3) Programmable Hoists
1598	_____ Amtech Model CON-48-28 Conveyor, s/n 3064
1599	_____ ACS 30" Board Washer w/ Exit Drying
1600	_____ Amtech Model APA-200-28 Panel Accumulator, s/n 745

This catalog is a guide. The Auctioneers do not warrant the accuracy, genuineness, authenticity, description, weight, count or measure of any of the lots specified herein.

CATALOG FOR PHOTOCIRCUITS

Lot	Description
1601	_____ One Lot of (5) Walk In Oven Circuit Board Baking Racks
1602	_____ Box Fan & Pedestal Fan
1603	_____ Gehnrich Single Door Gas Fired Oven, s/n 1052, 150 Degrees C. Max. Temperature
1604	_____ Veeco System XR SRF Coating Thickness Gauge, s/n LXR-0117
1605	_____ Contents of Office Including Gateway E-4200 Personal Computer w/ Monitor, Keyboard, Desk, Chair, File Cabinet & Air Conditioner
1606	_____ One Lot of Assorted Plant Support Through Out the Enig Room Including 2-Door Cabinets w/ Contents, Workbenches, Hot Plates, Pipettes, Racks & Pallet Racking
1607	_____ Heinrich Company C-Frame Punch, Light Table & Bench
1608	_____ (2) Fiberglass Folding Ladders
1609	_____ One Lot of Pneumatic Diaphragm Pumps, Polypropylene Chemical Storage Tank
1610	_____ CM Shopstar 300 Lb. 110 Volt Chain Hoist
1611	_____ (1) New 25 HP Centrifugal Pump 7 (2) Pneumatic Diaphragm Pumps
1612	_____ Lee Model 6T786 Electric Over Hydraulic Die Lift Table
1613	_____ Raymond Model 102T-5F45L Electric & Battery Operated Walk Behind Pallet Jack, s/n 102-04-01099, 4500 Lb. Capacity
1614	_____ (3) Probomer-Berkle LPI Curtain Coating Heads
1615	_____ One Lot of Miscellaneous Plant Support Including 2-Door Cabinets, Racks, Office w/ Contents, Loaders
1615A	_____ (1) Konica Minolta Bizhub Model 7222 Copier
1616	_____ Amtech Model APA-100 28-Panel Accumulator, s/n 1274
1617	_____ Thermomatic Dalfer Conveyorized Curing Oven
1618	_____ Eidschun Panel Rotator
1619	_____ Probomer Model 230S Buffer Curing Oven
1620	_____ Probomer Curtain Coating Head
1621	_____ Probomer 130 LPI Preheating Oven
1622	_____ Amtech 90 Degree Panel Turner, Model PD-90-28, s/n 3077
1623	_____ Thermomatic Dalfer Conveyorized Curing Oven
1624	_____ Amtech 90 Degree Panel Turner
1625	_____ Panel Conveyor
1626	_____ Probomer Model 230S LPI Curing Oven

This catalog is a guide. The Auctioneers do not warrant the accuracy, genuineness, authenticity, description, weight, count or measure of any of the lots specified herein.

CATALOG FOR PHOTOCIRCUITS

Lot	Description
1627	_____ Probomer LPI Curing Head
1628	_____ Probomer Model 130D Conveyorized Preheating Oven
1629	_____ Conveyor
1630	_____ IS 24" Model Pumex Pumis Scrubber
1631	_____ Amtech Model APAI-50-28 Panel Accumulator, s/n 3293
1632	_____ Thermomatic Dalfer Conveyorized Curing Oven
1633	_____ Eichein 180 Degree Panel Turner
1634	_____ Probomer Model 230S Conveyorized LPI Curing Oven
1635	_____ Probomer Berkel LPI Curtain Coating Head
1636	_____ One Lot of Amtech Conveyors
1637	_____ IS 24" Model Pumex Pumise Scrubber
1638	_____ Amtech Model APA-50 28-Panel Accumulator
1639	_____ Bassi Dalfer Model TMA2727 1.7 Conveyorized Curing Oven
1640	_____ IS 24" Model Pumix Pumise Scrubber
1641	_____ Amtech 90 Degree Panel Diverter
1642	_____ Mobin Spot Cool Cooling Unit
1643	_____ Red Devil 1-Gallon Paint Shaker
1644	_____ One Lot of LPI Pumps
1645	_____ 2-Door Flammable Storage Cabinet & Contents
1646	_____ Leibert System III Number 1 Room Conditioner
1647	_____ Mars Model 36 Air Curtain
1648	_____ ORC Model HMW680C7KW Double Door Exposure Printer, s/n 20756
1649	_____ ORC Model HMW680GW7K Double Drawer Exposure Unit Printer w/ Mylar Frames
1650	_____ ORC Model HMW680GW Double Drawer 7 KW Exposure Unit Printer w/ Mylar Frames
1651	_____ Nubal Model VIL/610 Panel Accumulator, s/n 2897
1652	_____ Adtec Model AC620 Fully Automatic UV Exposure System With Auto Alignment
1653	_____ Adtec Model AC620 Fully Automatic UV Exposure System With Auto Alignment
1654	_____ Amtech Model APA-50 28-Panel Accumulator, s/n 894
1655	_____ Amtech Model APA-150 28-Panel Accumulator, s/n 757
1656	_____ Amtech Model APA-150 28-Panel Accumulator

This catalog is a guide. The Auctioneers do not warrant the accuracy, genuineness, authenticity, description, weight, count or measure of any of the lots specified herein.

CATALOG FOR PHOTOCIRCUITS

Lot	Description
1657	_____ Stainless Steel Incline Substrate Panel Cleaner/Tacky Roller
1658	_____ Stainless Steel Incline Substrate Panel Cleaner/Tacky Roller
1661	_____ One Lot of Adtec UV Automated Exposure System Spare Parts, Current Cost - \$17,919.83
1662	_____ Air Flow Room Conditioning System
1663	_____ One Lot of Approx. (30) Stainless Steel Wire Metro Racks Fitted For Circuit Board Handling
1664	_____ Amtech Tote Loader, Model IF-75-32, s/n 648
1665	_____ Olec Model AP30 8000 Super 8 KW Double Drawer Exposure Unit Printer, Mylar Frames, Closed Loop Cooling System
1666	_____ Olec Model AP30 8000 Super 8 KW Double Drawer Exposure Printer w/ Mylar Frames, s/n 306001, Closed Loop Cooling System
1667	_____ Close Circuit Camera Video Inspection System w/ Monitor & Illuminator
1668	_____ Arbor Press
1669	_____ One Lot of Miscellaneous Plant Support Throughout Clean Room Including Benches, Light Tables, & Computer
1670	_____ Liebert Challenger 3000 Number 1 Room Conditioning System
1671	_____ 1993 ORC Model HMW680GW7KW Dual Drawer Exposure Unit Printer, w/ Mylar Frames, s/n 28723
1672	_____ ORC Model HMW680C7KW Double Drawer Exposure Unit Printer, w/ Mylar Frames, s/n 21146
1673	_____ 1998 ORC Model HMW680GW7KW Double Drawer Exposure Unit Printer, w/ Digital Microprocessor Operator Terminal w/ Mylar Frames, s/n 34668
1674	_____ Connetic Systems Model 5104H-3648-02 Inspection System, s/n 500-1795 w/ Video Inspection System, Chart Recorder, Acu-Rite 2-Axis Digital Readout
1675	_____ Liebert Challenger 3001 Room Conditioning System
1676	_____ One Lot of Miscellaneous Throughout Exposure Room Including Benches, Chairs & Computer
1677	_____ One Lot of ORC Model HMW-680GW Exposure Unit Spare Parts, New Cost is \$7308.57
1678	_____ Rack of Exposure Unit Glass Photo Tool Carriers
1679	_____ One Lot of Polypropylene Plating Tanks
1680	_____ CM Load Star Chain Hoist
1681	_____ One Lot of Hepa Filters, Pump Filters
1682	_____ Alpha Metals Model 600SMD Omega Meter Ionic Contamination Test System
1683	_____ Alpha Metals Model 600SMD Omega Meter Ionic Contamination Test System

This catalog is a guide. The Auctioneers do not warrant the accuracy, genuineness, authenticity, description, weight, count or measure of any of the lots specified herein.

CATALOG FOR PHOTOCIRCUITS

Lot	Description
1685	_____ Contents of Room Including Desk, Chair, Dell Optiplex GX1 Computer, Monitor, Gateway P5-120 Computer, File Cabinets
1686	_____ Great Lakes Air Products Air Dryer
1687	_____ Harlacher Model H41 Emulsion Screen Frame Coater
1688	_____ ORC Model HMW87 Vacuum Exposure Frame System, s/n 6154
1689	_____ One Lot of Screen Frame Stretching Pneumatic Clamps Table
1690	_____ One Lot of Screen Frame Stretching Pneumatic Clamps Table
1691	_____ One Lot of Pneumatic Screen Frame Stretching Clamps
1692	_____ One Lot of Assorted Silk Screen
1693	_____ Saati Screen Frame Drying Oven
1694	_____ Tokyo Process Model SK-1400AP Screen Frame Drying Oven, s/n 10809-3
1695	_____ One Lot of Aluminum Screen Frame Chases
1696	_____ One Lot of Aluminum Screen Frame Chases
1697	_____ Leibert System III Number 1 Room Conditioning System
1698	_____ One Lot of Graylab Timers
1699	_____ One Lot of Aluminum Screen Frame Chases
1700	_____ One Lot of Aluminum Screen Frame Chases
1701	_____ One Lot of Aluminum Screen Frame Chases
1702	_____ One Lot of Aluminum Screen Frame Chases
1703	_____ One Lot of Aluminum Screen Frame Chases
1704	_____ One Lot of Aluminum Screen Frame Chases
1705	_____ One Lot of Screen Frame Washout Booths w/ Pneumatic Pumps
1706	_____ Gehrlich Single Door Gas Fired Baking Oven, s/n 10007, 300 Degrees F. Max. Temperature
1707	_____ Gehrlich Single Door Gas Fired Baking Oven, s/n 9899, 300 Degrees F. Max. Temperature
1708	_____ One Lot of (21) Assorted Oven Circuit Board Baking Racks
1709	_____ Box Fan & Pedestal Fan
1710	_____ Water Softening System
1711	_____ One Lot of Numerous Central Vac Systems
1712	_____ 1997 IS 24" LPI Developer Model Devmaster, s/n .0757623
1713	_____ Amtech 90 Degrees Panel Diverter

This catalog is a guide. The Auctioneers do not warrant the accuracy, genuineness, authenticity, description, weight, count or measure of any of the lots specified herein.

CATALOG FOR PHOTOCIRCUITS

Lot	Description
1714	_____ Amtech Accumulator
1715	_____ 1997 IS 24" LPI Developer Model Devmaster, s/n .0757615, w/ Exit Drying
1716	_____ Amtech Model APA-150-28 Panel Accumulator
1717	_____ Probomer/B.Schmiedeskamp Model 470M2 High Pressure Rinse LPI Developer, s/n 002/901, 24"
1718	_____ Amtech Tote Loader
1719	_____ LPI Rack Stripping Line w/ Hoist & Tanks
1720	_____ 684KF Coulometer w/ Computer Controls
1721	_____ Cole Parmer Hot Plate Stirrer, Cart & Heinrich C-Frame Punch & Workbench
1722	_____ One Lot of Pneumatic Diaphragm Pumps
1723	_____ 1998 Argus International Model 9324 Double Sided LPI Sprayer, s/n 1001386 with IR ConveyORIZED Dryer Oven
1724	_____ One Lot of (9) Justrite & Eagle 2-Door Flammable Storage Cabinets
1725	_____ One Lot of Assorted Exposure Systems, (2) Automotech O Like Accu Print for Parts Only, Stainless Steel Circuit Board Trays
1726	_____ Numerous Amtech Divert-Rotators, Tote Loaders, Conveyors, Tacky Roller, Amtech Incline Receiver, (2) Presto Battery Operated Walk Behind Lifts, (2) Analog Readout Control Cabinets, Roll Around Carts
1727	_____ One Lot of (5) 2-Door Storage Cabinets Consisting of (3) Strong Hold 2-Door Storage Cabinets w/ Applicable Contents, (2) 2-Door Storage Cabinets w/ Contents, (1) Section of Medium Duty Pallet Racking w/ (2) Uprights, (6) Cross Members, Various Wall Hanging 2-Door Storage Cabinets
1728	_____ One Lot of (2) Multi-Drawer Roll Around Mechanics Tool Chests
1729	_____ Custom Fabricated Pressure Washer
1730	_____ Manhattan Heavy Duty Drill Press, Model 951210, 1/2 HP, Heavy Duty Wood Top Metal Workbench w/ 5" Wilton Vise
1731	_____ One Lot of (5) Werner Fiberglass Step Ladders Consisting of (1) 10' , (2) 8', (1) 6', (1) 4' Step Ladders
1732	_____ (1) 55-Gallon Drum Pneumatic Vacuum, (1) Industrial Shop Vac

This catalog is a guide. The Auctioneers do not warrant the accuracy, genuineness, authenticity, description, weight, count or measure of any of the lots specified herein.

CATALOG FOR PHOTOCIRCUITS

Lot	Description
1733	Contents of Upstairs Office Consisting of (8) 4-Drawer Vertical File Cabinets, (1) 3-Drawer Vertical File Cabinet, (2) 2-Drawer Vertical File Cabinets, (4) Office Desks w/ Applicable Chairs, (1) Computer Station, (1) 4-Shelf Metal Bookcase, (1) Single Door Vertical Cabinet w/ Applicable Contents, (1) Samsung 19" Color TV, (1) NEC Model HHR VHS 4-Head w/ Applicable Rolling Cart, (7) Upholstered Chairs, (1) HP Laser Jet Model 4000N Laser Jet Printer, (3) Room Air Conditioners, (1) Idesco Corporation Laminator Model 124844, s/n 6000ECR, (1) Key Master Key Holder
1734	Contents Of Upstairs Office Consisting of Numerous Office Desks, Partitions, HP Laser Jet 4000N Laser Jet Printer, 15" & 17" Color Monitors, Numerous Office Chairs Consisting of Upholstered Arm Chairs, Upholstered Swivel Arm Chairs, Upholstered Swivel Chairs, (2) Tower Computers, (2) Portable Small Light Tables
1735	(1) Large Lot of Employee Lockers
1736	Carrier Liquid Chiller
1737	Carrier Air Conditioner Model 50BA-016-640, s/n 2193F51153
1738	Contents of Upstairs Cafeteria Including But Not Limited to: (2) Portable Rolling Picnic Benches, (1) Amana Commercial Microwave Oven, (1) Admiral Single Refrigerator/Freezer, (2) 4-Shelf Stationary Metro Racks, (1) 2-Door Vertical Storage Cabinet, (1) Light Duty Section of Pallet Racking Consisting of (2) Uprights & (3) Cross Members, (2) Adjustable Shelving Units, (4) 4-Door Vertical File Cabinets
1739	Wesco Model ESPL-50-2424, s/n 97513 Heavy Duty Roll Around Die Lift Cart, 1000 Lb. Capacity
1740	(1) Stainless Medium Duty Roll Around Die Lift Cart
1741	(1) Wesco Heavy Duty Roll Around Die Lift Cart Model ESPL-60-2424, s/n 494294, 1000 Lb. Capacity
1742	(1) Medium Duty Die Lift Cart
1743	(1) Vestil Heavy Duty Die Lift Cart, s/n Hydra HD-023599FL, 1000 Lb. Capacity
1744	Hydraulic Pallet Jack
1745	Hydraulic Pallet Jack
1746	5500 Lb. Pallet Jack Model BS55E
1747	Bishmon 5000 Lb. Capacity Hydraulic Pallet Jack
1748	5000 Lb. Capacity Hydraulic Pallet Jack
1749	Contents of Small Changing Room Including (1) Laboratory Gown Rack, Various Small Employee Lockers, 2-Door Strong Hold Metal Storage Cabinet w/ Contents, Wood Gown Rack w/ Contents
1750	Approximately (11) Optima Over Current Modules

This catalog is a guide. The Auctioneers do not warrant the accuracy, genuineness, authenticity, description, weight, count or measure of any of the lots specified herein.

CATALOG FOR PHOTOCIRCUITS

Lot	Description
1751	_____ SPM Vibrometer Model VIB-11 w/ Owners Manual
1752	_____ Fluke 189 True RMS Digital Multimeter
1753	_____ BK Precision Model 350A Digital Clamp Meter w/ Case
1754	_____ Yokogawa Model 2426A Digital Insulation Tester w/ Case & Manual, Amp Probe Voltage Recorder w/ Case
1755	_____ Amp Probe Model DM1 Digital Amp Recorder w/ Case
1756	_____ TFI Incorporated Model 8360 Air Velocity Recorder w/ Case & Manual
1757	_____ TIF Model KW220-3 KW Hour Meter Watt Meter
1758	_____ Safety Scan Safety Screen Model SS950-06000
1759	_____ (2) Chemical Pumps Model OL50VPFC-2 and Agitator
1760	_____ Burndy Electrical Compression System Model Y2MR, Dayton Model 4X083A Bushing Set, Boehm Model JLB330US Hollow Punch Set, Brown & Sharp Block Set
1761	_____ Spear Head 760 Adjustable Gasket Cutter for (2), Helicoil Model 4934 Thread Repair Kit, Helicoil Model 540-5 Professional Thread Repair Kit, Alligator V-Belt Cutter
1762	_____ Erwin Model 26376 Tap & Die Set w/ Case, Erwin Tap & Die Set w/ Case, Ridgid Set #25 Extractor Set w/ Case, Walton Company Extractor Set w/ Case, Minuteman Broach Set w/ Case
1763	_____ One Lot of Bearing Sets Consisting of Marathon Bearings, Fafnir Bearings, Browning Bearings, FYH Bearings, Max Changer Model MX-05 Heat Exchanger
1766	_____ Dayton Model 5YH20, Hot Water Heater Unit, s/n P0670890404100
1767	_____ Dayton Model 5UT18, Steam Hot Water Heater Unit, s/n K05595029013001
1768	_____ Dayton Model 5UT20, Steam Hot Water Heater Unit, s/n K06679485042025 (New In Box)
1768A	_____ (1) CM Valu Star Model WL 1-Ton Electric Hoist, (1) Shop Vac w/ 10-Gallon Canister
1769	_____ Small Fire Proof Cabinet
1770	_____ Parker Valve #7131Z002N0C11P3 Pneumatic Valve Control, Clippard Cylinders, Approximately (4) Model UDR-20-4, Approximately (2) Model CDR-24-10
1771	_____ (2) Exair Model 110024 Air Knives, Nieco Pneumatic Actuator, Trinity Feeler Gauges Approx. (1) Boxes
1772	_____ Wen Solder Gun w/ Case
1773	_____ Fenner Drives, Butt Welder (New In Case)
1774	_____ Welding Torches, Gauges, Tips & Hoses
1775	_____ Proweld Kit 7120, Consisting of Torches, Tips, Gauge, Hose & Mask
1776	_____ Metal Power Welding Kit Including Gauges, Mask & Hoses

This catalog is a guide. The Auctioneers do not warrant the accuracy, genuineness, authenticity, description, weight, count or measure of any of the lots specified herein.

CATALOG FOR PHOTOCIRCUITS

Lot	Description
1777	_____ Larimy Poly Welder w/ Hoses & Tips
1778	_____ (2) Larimy Poly Welder Units, Consisting of Cases & Hoses
1779	_____ (3) Sets of Tie Downs
1780	_____ Porter & Cable Model 747 Tiger Saw Sawsall (New In Case)
1781	_____ Porter & Cable Tiger Saw Sawsall In Case
1782	_____ Milwaukee Model 0-2400 Sawsall in Case
1783	_____ Milwaukee 7-1/4" Circular Saw
1784	_____ Milwaukee 7-1/4" Circular Saw
1785	_____ Makita Model 2414B 10" Chop Saw
1786	_____ Chicago Electric Model 42203 Angle Grinder, Chicago Electric Angle Grinder, Milwaukee 1/2" Drill, Veritemp Model VT-750C Heat Gun
1787	_____ Thomas Model 905AA23-032A Air Pump, Chicago Pneumatic Model CP9311 Chisel
1788	_____ Williams (13) Piece 3/4" Drive Impact Set w/ Case, Ingersoll Rand Model A Impact Wrench, Ingersoll Rand Model 107XP Air Wrench, ST. Louis Pneumatic Model FLP83150 Pneumatic Angle Grinder, Die Grinder
1789	_____ Milwaukee Catalog #48-10-0070 Router, Makita Hand Drill, Master Heat Model HG757B Heat Gun
1790	_____ Bosch Model 1752G Angle Grinder, Smaller Angle Grinder Included As Well As Box of Grinding Wheels
1791	_____ Approximately (14) C-Clamps, (2) Bar Clamps, (2) Quick Grip Clamps, (2) Vise Clamps
1792	_____ (2) Ridgid Pipe Benders, (1) 1/2" EMT Bender (New In Box), (1) 3/4" EMT Bender (New In Box)
1793	_____ Assorted Hand Tools Consisting of (3) Pipe Wrenches Ranging from 48" - 24", Small Sledge Hammer, Crow-Bar, Hand Wrenches, Grip Fast Blind Rivet Set
1794	_____ (2) Compression Tool Crimpers, (1) is in Box
1795	_____ Assorted Hole Saws Consisting of Bahco Snap On Hole Saws up to 6", Morse Hole Saws, Hotsy Model 90115V-60HZ-15A Shark Power Washer
1796A	_____ (1) Greenlee Model 17-31 Knock Out Punch/Driver, (1) Greenlee Hydraulic Unit for Knock Out Punch/Driver
1797	_____ Lucker Plate Clamps for (2)
1798	_____ Material Handling Consisting of Duprbin Come-Along, Cyclone 1/2 Ton Chain Hoist, Hilman Wall Rigging Skates & Pivots, Chains & Straps
1799	_____ Gear Puller & Clamps in Case
1800	_____ Craftsman Model 919.167782 25-Gallon Air Compressor
1801	_____ Parks s/n 61045M Panel Saw w/ 14" Blade & Table

This catalog is a guide. The Auctioneers do not warrant the accuracy, genuineness, authenticity, description, weight, count or measure of any of the lots specified herein.

CATALOG FOR PHOTOCIRCUITS

Lot	Description
1802	_____ Delta Compound Sliding Saw w/ 14" Blade
1803	_____ Delta s/n 1124498 Table Saw w/ 10" Blade
1804	_____ Wilton 6" Belt Sander w/ Disk Grinder
1805	_____ MSC Industrial Supply Model 09514639 Continuous Band Saw w/ Extra Blades
1806	_____ 5' x 3' Welding Bench w/ Vise, Welding Helmets & Vapor Hood
1807	_____ Airco Model 3A-DDR-224HPA-B-D AC/DC Heliwelder
1808	_____ Triangle s/n PS427 Spot Welder
1809	_____ Welding Cart w/ Torches & Valves (Note - Tanks not included)
1810	_____ Drake H-Frame Press
1811	_____ Baldor Model G730530 Double End Grinder w/ Stand & Light
1812	_____ Delta 2-Head Drill Press w/ Bench & Vise
1813	_____ Clausing Model 6913 Lathe w/ Toolpost, (3) 4-Jaw Chucks, (1) 1-Jaw Chuck, s/n 602137
1814	_____ Oliver Model 2026 Deep Throat Reciprocating Saw
1815	_____ Clausing Model 1301 Engine Lathe, w/ Tool Post & 3-Jaw Chuck, Steady Rest, s/n 130618
1816	_____ Bridgeport Type J Milling Machine w/ Power Feed, (2) Vises & 48" Bed
1817	_____ Budgit 1/4-Ton Electric Chain Hoist
1818	_____ Finger Break
1819	_____ W.F. Wells & Son 9" Metal Saw
1820	_____ Ridgid Model 801 Type A Pipe Threader, s/n 8101262
1821	_____ Ridgid Tooling Consist of Pipe Stand, Threading Stock, Dies, Threading Teeth & Multipurpose Head
1822	_____ Standard Model 101 Double End Grinder w/ Stand
1823	_____ Walker Turner Model 80A33 10" Chop Saw w/ T-Stand
1824	_____ Zero Model B-600F Sand Blast Cabinet w/ Dust Collector, s/n 4867
1825	_____ Beverly Metal Cutter/Nibbler w/ Stand
1826	_____ Craftsman Rolling Tool Cart w/ Applicable Contents
1827	_____ Craftsman Rolling Tool Cart w/ Applicable Contents
1828	_____ Rolling Tool Cart w/ Applicable Contents
1829	_____ Waterloo Rolling Tool Cart w/ Applicable Contents
1830	_____ Craftsman Rolling Tool Cart w/ Applicable Contents
1831	_____ Kennedy Rolling Tool Cart w/ Applicable Contents

This catalog is a guide. The Auctioneers do not warrant the accuracy, genuineness, authenticity, description, weight, count or measure of any of the lots specified herein.

CATALOG FOR PHOTOCIRCUITS

Lot	Description
1832	_____ Craftsman Rolling Tool Cart w/ Applicable Contents
1833	_____ Rolling Tool Cart w/ Applicable Contents
1834	_____ Craftsman Rolling Tool Cart w/ Applicable Contents
1835	_____ Rolling Tool Cart w/ Bench Vise & Applicable Contents
1836	_____ (4) 2-Door Cabinets w/ Contents Consisting of: Pipe Fittings, Electrical Cords, Electrical Controllers & Belts
1837	_____ (7) 2-Door Cabinets Consisting of: Braided Hose, Pipe Fittings, Electrical Controllers, Belts & Chain
1838	_____ (6) Metal Cabinets Consisting of: Nuts & Bolts, Electric Fan Motors, Electrical Cord & Solder
1839	_____ (2) Cabinets w/ Plastic Pipe Fittings
1840	_____ 3-Shelved Rubbermaid Cart & New Inbox Bakers Rack
1841	_____ (5) Industrial Work Benches w/ Maple Tops
1842	_____ (5) Industrial Work Benches w/ Maple Tops
1843	_____ Bishamon Pallet Jack Model BS-55E w/ 5,500 Lb Capacity
1844	_____ Genie Load Lifter Die Lift Cart w/ 200 Lb Capacity, s/n 33003462, & Hand Truck
1845	_____ Craftsman Shop Vac 5.75-HP, 55 Gallon Drum Vac
1846	_____ (2) Pedestal Shop Fans
1847	_____ Approximately (18) Rolling Carts w/ Contents
1848	_____ Approximately (20) Sections of Lockers
1849	_____ Contents of Offices Consisting of: Approximately (4) Computers, (5) Desks, (2) File Cabinets, (3) 2-Door Cabinets, (3) Work Benches, (1) Rolling Tool Cart & Shelving
1850	_____ Scat Blast Sand Blaster, s/n 436116 w/ Dust Collector
1851	_____ Central Machinery Model 44006 Electric Hoist, 880 Lb Capacity w/ Jib
1852	_____ Dayton Model 4Z909C 8" Bench Grinder w/ Pedestal
1853	_____ (4) 4-Step Portable Stairs, (1) 5-Step Portable Staircase
1854	_____ (2) Skids of Allen-Bradley Controllers
1855	_____ Office Trailer & Contents Consisting of: Desks, Chairs, Cabinets, Computer, Sheets of Polypropylene & Storage Shelves
1856	_____ Steel Storage Trailer & Contents Consisting of: Storage Bins, Motors & Pumps

This catalog is a guide. The Auctioneers do not warrant the accuracy, genuineness, authenticity, description, weight, count or measure of any of the lots specified herein.

CATALOG FOR PHOTOCIRCUITS

Lot	Description
1857	Contents of Chemical Operations Room Consisting of Various Wilden Pumps, Assorted Marathon Electric Motors, Adjustable Metal Shelving w/ Contents, Small Parts Cabinet w/ Contents, Craftsman Multi-Drawer Mechanics Roll Around Tool Chest, 5" Wilton Vise, 4-Drawer Small Parts Compartments, Sears Die Hard 2/20/60 AMP Battery Charger, 6/12 Volts
1858	York Liquid Chiller Model YCARO150SC46, s/n RLJM0320AA w/ Associated Motors & Air Storage Receiver
1859	Airex Corp. Thermal Oxidizer w/ Quartech LED Readout Controls, Allen Bradley Model 1336 Plus II Control Panel, Honeywell Trueline Chart Recorder, w/ Associated Fluid Power Gas Valves, Meters etc., Number 2 Rectangular Fuel Oil Tank
1860	ABV Fume Scrubber Located Inside of Storage Trailer, s/n 0019601704, Max. RPM's 2050 w/ Associated Metal Storage Building
1861	Contents of Metal Storage Building Including But Not Limited to: Assorted PVC Schedule 40 Pipe, PVC Pipe, Assorted Sizes & Lengths, PVC Fittings, Elbows, T's, Assorted Stainless Steel Nuts, Bolts, Washers, Assorted Stainless Steel Fittings, Couplings, Hose Couplings, Assorted Clevis Hangers, Assorted Stainless Steel Nipples, T's, Reducers, Elbows, Flanges, Assorted Copper Tubing, Titanium, Stainless Steel, Square Bar, Stainless Steel Rod, Pipe Racks Located Along Side of Storage Container, Assorted Adjustable Shelving, PVC Sheet 4 x 8
1862	Storage Shed Approx. 9' Wide x 45' Long x 10' High, Metal Corrugated Construction
1863	One Lot of (2) Corrugated Metal Storage Containers, Approx. 20' High x 9' Wide x 45' Long w/ Individual Size Storage Containers, 7' Cubed x 8' High, 7 x 7 x 7 x 8' High
1864	United Scales Model R700 Digital Readout Platform Scale, 5000 Lb. Cap.
1865	(4) Sections of Medium Duty Pallet Racking Including (8) Uprights, (16) Cross Members, Contents of Pallet Racking Including But Not Limited To: Electric Pumps, Diaphragm Pumps, Vacuum Pumps, Pump Spare Parts, (3) Sections of Adjustable Pallet Racking w/ Contents Including: Assorted Electric Motor Parts Including Housing, Motor Bodies, Armatures, (5) Metro Racks w/ Assorted Electric Motors & Components, (1) Metal Roll About Shop Cart w/ (15)-HP Electric Motor
1866	(11) Roll About Metro Carts w/ Associated Allen-Bradley Components, Red Hat Component, Rockwell Allen-Bradley Components, 3/4" Non-Metallic One-Hole Conduit Snap Straps, Assorted Fittings, Bearings, Bearing Housings, Omron Parts, Tubing, Relays, Fittings
1867	(7) Burlap Packages Including But Not Limited To: TSHIS Pumice Brushes, (6) Per Box, (2) Boxes Per Burlap Package, Size D

This catalog is a guide. The Auctioneers do not warrant the accuracy, genuineness, authenticity, description, weight, count or measure of any of the lots specified herein.

CATALOG FOR PHOTOCIRCUITS

Lot	Description
1868	_____ Electric Motors, March Motors & Pumps, Comet Pump Parts, Penguin Pump Parts, Assorted O-Rings, Hoses, Circuit Breakers, Contacts, Blue Grease, Mobile DTE24 Lite Hydraulic Oil Gallon Containers
1869	_____ Contents of Shelving Unit Including: Various Electric Motors, March Parts, March Vacuum Pumps, Ansimag Pump Parts, O-Rings, Tubings, Assorted Allen-Bradley Controllers, Circuit Breakers, Light Hydraulic Oil, Ocean 7W Grease
1870	_____ (16) Sections of Adjustable Steel Shelving w/ Contents Including: (2) Small Parts Racks w/ Assorted Fuses, Thermal Units, Heater Relays, PVC Nozzles, Electrical Plugs, Assorted Filters, Titanium Heater Coils, Wilson Curtains, Assorted Metal Chain, Impellers, Worm Gears, Optic Sensors, Sprockets, Bronze Elbows, Motor Pump Impellers, Magnatrol Value Steam 3/4" 115-Volt Coils, Control Relays, Air Flow Switches, Limit Roller Switches, Brushes, Power Supplies, Magnetic Switches, Speed Controllers, Photo Electric Switch Entering Switches, Solenoid Valves, Amp Meters, Sprocket Keys & Set Screws, End Bushings, Grundfos Pump Parts
1871	_____ (10) Adjustable Metal Shelving w/ Contents Including: Roll-Coater Parts, Burkle Roll-Coater Parts, Lohr Herrmann Feeder Parts, Assorted Relays, Sew-Eurodrive Drive Motors, Steel Rollers, Needle Axial Rollers, Pressure Springs, Circuit Interrupters, Omron Type H5AN-4DM Timers, Photo Printer Cowlmeter Parts, Cibba Racker Parts, Eidschun Feeder Parts, Cibba SF Printer Parts, Copper Reduction Parts, Assorted Wide Belts, ORP Sensor Assemblies, Multi-Layer 2D DES Line Parts, Oven Parts
1872	_____ (11) Sections of Adjustable Steel Shelving w/ Contents Including: Assorted IS Scrubber Parts Including Drive Motors, Webster Pumps, ABB Motors, Loware Drive Motor, Assorted Titanium Sprayer Parts, Titanium Screen Baskets, Assorted Filters & Plastic Filter Holders, Assorted Small Motors & Rollers, Impellers, Motor Blowers, Twin Gears, Twin Sprockets, Gear Brush Drive Idlers, Door Seals, Viton Gaskets, Oil Seals, Pumps Seals, Seal Kits, Roller Chain Metric 12-Decimal 7mm Pitch, Omron Contacts, Chain Guides, Assorted Flow Meters, Flow Meter Nipple Regulators

This catalog is a guide. The Auctioneers do not warrant the accuracy, genuineness, authenticity, description, weight, count or measure of any of the lots specified herein.

CATALOG FOR PHOTOCIRCUITS

Lot	Description
1873	(14) Sections Adjustable Steel Shelving w/ Contents Including: Adara System Parts, Infrared Sensors, Contacts, Digital Amp Meter, Press Meter, Volt Meter, Krimep Motor Blower Assembly, Assorted Electric Motors, 4" Butterfly Valve, Assorted Ball Valves, Titanium Washers, Limit Switches, Circuit Breakers, Level Controllers, Photo Cells, Sensors, Assorted Sized Shafts, Assorted Halco Parts Including Mounting Blocks, Pillow Blocks, Bearing Guards, Solenoids, Upper Air Knives, Gaskets, Assorted Sparatanic Punch, Pot Face Parts Including Guards, Break Shoe Linings, Electric Breaks, Filter Diffusers, Assorted Amtech Parts Including Brass Pinions, Re-Settable Counters, Programmable Controllers, Actuator Pilots, Assorted Rollers, Manufacturers Allen Air Model ETX15BC OS #54, Allen Air Type C2X1 NT OS PUBB #45, #44, #106, #24, Assorted Rich Feeder Parts, 2-Way Valves, Potentiometer, Assorted Stump Feeder Parts Including, Limit Switches, Cyclinder Sensors, Vacuum Entry Parts, Assorted Electric Motors, Induction Motor Parts, Gear Head Parts, Assorted Brushes, Assorted Zellerbach Tacking Machine Motors
1874	(14) Sections Adjustable Steel Shelving w/ Contents Including: DEA Etcher Parts, Timing Belts, Resin Belts, Cables, Speed Controls, Surge Gears, Couplings, Assorted Electric Motors, DEA Etcher Reflow Parts, Pumps, Hydrometers, Bearing Brushes, Chain Link Cutler Hammer, Contact Blocks, Transport Rollers, Marsesco Parts Including Liquid Filled Gauges, Cooling Coils, Dog Clutches, March Model BC-4C-MD Magnetic Drive Fan Cool Pump, Air Cylinders, Assorted Electric Motors & Pumps, Hercules Laminator Parts Including Temperature Sensors, Bearings, Rotary Switches, Brass Blocks w/ Dove Tails, CSL 1500B Laminator Parts Including Sprockets, Gear Heads, Static Bars, Air Flow Controls, Power Sequencer Parts, Speed Controls, Timing Pulley for Motors, Assorted Fuses, Relays, Trolley Assembly, Assorted Punch Press Parts Including Assorted V-Belts, Large Square Nuts & Bolts, Assorted Sprockets, Relays, Block Contacts, Steel Studs, Fuses, Assorted Electric Motors, Hoses, Auto Roll Parts
1875	(16) Sections Adjustable Steel Shelving w/ Contents Including: 1-Way Sprocket Roller Bearings, Belt Connectors, DC Drive Controllers, Cylinders, Power Supplies, Anti-Static Units, Bodine Gear Motor, Relay Switches, Filter Caps, Burkert Fluid Control Sensors, Assorted Bearings, Electric Motors, Stainless Steel Belt Guide, Assorted V-Belts & Serpentine Belts, Paxton Blower Assembly, Waste Treatment Parts Including Sensors, Chart Recorder Paper, Square D Small Transformers, Assorted Flow Meters, Flow Window Indicators, Heater Elements, Assorted Roller Chain & Sprockets, Trap Seals, Assorted Oil Filters, Assorted Filter Bags, Assorted Titanium Heating Coils, Assorted Copper Heating Coils, Rollers

This catalog is a guide. The Auctioneers do not warrant the accuracy, genuineness, authenticity, description, weight, count or measure of any of the lots specified herein.

CATALOG FOR PHOTOCIRCUITS

Lot	Description
1876	(16) Sections Adjustable Steel Shelving w/ Contents Including: Bronze Bushings, Electric Motors, Electric Pumps, Bearings, Assorted Etcher Parts Including Spur Gears, Tygon Seals, Dual Thermometers, O-Ring Seals, Stainless Steel Shaft Assembly, Assorted Relays, Assorted PVC Block Assemblies w/ Brass Inserts, Digital Meter, Retaining Kits, Small Baldor Pump Motors, PVC Sprockets, Stainless Steel Sprockets, Assorted Dials, Red Lion Controller Counter, Spacer Bushings, Eccentric Cam Followers, Assorted Y Filters, O-Rings, Fuses, Glass Fuses, Omron Electrode Holders, Hot Tip Heaters, Reed Switches, Gear Reducers, Assorted Mounted Ball Bearings, Serpentine Belts, Assorted Sized Baldor Motors
1877	(1) Sections Adjustable Steel Shelving w/ Contents Including: Assorted Sized & Gauge Electrical Wire
1878	(33) Sections Adjustable Steel Shelving Inside of Tool Cage w/ Contents Including: PVC Long Sweeps, PVC Access Fittings, Assorted PVC Bushings, PVC T's, PVC Couplings, PVC Flanges, Plugs, Assorted Black Pipe Nipples, Elbows, Assorted Conduit Couplings, Female Adapters, Assorted Copper T's, Copper Couplings, Copper Elbows, Sweat to Screw Adapters, Stainless Steel T's, Stainless Steel Plugs, Stainless Steel Bushings, Stainless Steel Elbows, Stainless Steel Couplings, Stainless Steel Nipples, Stainless Steel Straps, Assorted Bearings, Galvanized 45 & 90 Degree Inch Sweeps, Conduit Parts, Coded Copper Wire, Red Hat Valves, Assorted Light Bulbs & Lighting
1879	(3) Sections Adjustable Steel Shelving w/ Assorted Wilden Diaphragm Pump Parts Including: Assorted Diaphragms, Outside Pump Covers, Impellers, Pump Balls, Assorted Stainless Steel Screws, Sliding Check Assembly, Pressure Relief Assembly, Air Chambers, Teflon Diaphragms, Air Chamber Diaphragms & Assorted Band Clamps
1880	(1) Parts Room/Maintenance Cage w/ Security Lock
1881	One Lot of Assorted Stainless Steel Pipe, Black Iron Pipe, Galvanized Pipe, Copper Pipe, PVC Pipe, Polypropylene Schedule 80 Pipe, 10' Sections & Assorted Lengths of Uni Strut, (1) Threaded Rod Holding Rack w/ Assorted Sized Threaded Rod
1881A	One Lot of Assorted Glasfloss Filters, One Lot of Assorted Shaft Rollers To Be Recovered, (2) Sections of Light Duty Pallet Racking Including (8) Uprights & (12) Cross Members
1882	(1) Section of Medium Duty Pallet Racking Including (2) Uprights & (4) Cross Members w/ Contents Including: Assorted Re-Covered Rollers, Tacky Rollers, Single & Dual Stage

This catalog is a guide. The Auctioneers do not warrant the accuracy, genuineness, authenticity, description, weight, count or measure of any of the lots specified herein.

CATALOG FOR PHOTOCIRCUITS

Lot	Description
1883	(4) Sections of Small Parts Components Cabinets Including But Not Limited To: Stainless Steel Hex Nuts, Hex Bolts, Pan Head Screws, Stove Bolts, Lock Washers, Zinc Nuts & Bolts, Steel Nuts & Bolts, Brass Bolts, Splicing Connectors, Allen Cap Screws, Stainless Locking Hex Nuts, Stainless Flat Washers, (1) Small Parts Cabinet w/ Associated Plastic Bins w/ Contents Including: Stainless Steel Screws, Pan Head Screws, Assorted Allen Cap Screws, Zinc Hex Bolts, Assorted Bearings
1884	(3) Sections of Small Compartmented Parts Cabinets Including But Not Limited To: Assorted Stainless Steel Hex Bolts-Assorted Sizes, Assorted Stainless Steel Allen Cap Screws-Assorted Lengths, Assorted Stainless Steel Nuts, Assorted Stainless Steel Lock Nuts, Assorted Zinc Flag Screws
1885	(8) Sections of Small Parts Cabinets Consisting of 32-Drawers w/ Contents Including But Not Limited To: Nylon & Plastic Anchors, Hair Pin & E-Ring Retainers, Metric O-Rings, Rubber O-Rings, Anchors, Wall Grips, Toggle Bolts, Grease Fittings, Spring Pins, Roll Pins, Internal Retaining Rings, External Retaining Rings, Stainless Steel Tooth Lock Washers, Metric Oval Head Machine Screws & Nuts, Stainless Steel Small Hex & Stop Nuts, Flat & Lock Washers, Phillips Sheet Metal Screws, Wing Nuts (Please Inspect)
1886	(8) Sections of Small Parts Cabinets Consisting of 32-Drawers w/ Contents Including But Not Limited To: Socket Head Cap Screws, Stainless Steel Hex Socket Set Screws, Headless Set Screws, Universal Wire & Cable Clamps, Wire Connectors, Thermo Seal, Thermo Assortment, Nylon Insulation Thermo, Copper Gaskets, Pop Rivet Assortment, Tie Wrap Assortment, Assorted Heat Sink, Assorted Cotter Pins (Please Inspect)
1887	(2) Wall Mounted Cabinets w/ Contents Including: Assorted Tech Screws, Socket Head Cap Screws, Button Head Screws, Nuts & Flat Washers, Anti-Seize Copper Taps, (4) Single Door Storage Units, (2) Wood 2-Door Storage Cabinets w/ Contents Including: (1) Durodyne Hand Punch, Assorted Wrenches, Olec Spectramatch Lamps, Assorted Cans of Belt Dressing, Penetrate & Grease, Carburetor & Choke Cleaner, Multi-Purpose Solvent
1888	One Large Lot of Assorted V-Belts, Serpentine Belts, Assorted Stainless Steel Nipples, Stainless Steel Reducing Bushings, Stainless Steel Elbows, Copper Elbows, Copper T's, Copper Flanges, Copper Ball Valves, Bronze Flanges
1888A	(1) West Wind 125,000 RPM Air Bearing Spindle
1888B	(1) West Wind 125,000 RPM Air Bearing Spindle
1888C	(1) West Wind 100,000 RPM Air Bearing Spindle
1888D	(1) West Wind 100,000 RPM Air Bearing Spindle
1888E	(1) West Wind 100,000 RPM Air Bearing Spindle

This catalog is a guide. The Auctioneers do not warrant the accuracy, genuineness, authenticity, description, weight, count or measure of any of the lots specified herein.

CATALOG FOR PHOTOCIRCUITS

Lot	Description
1888F	(1) West Wind 100,000 RPM Air Bearing Spindle
1888G	(1) West Wind 100,000 RPM Air Bearing Spindle
1888H	(1) West Wind 100,000 RPM Air Bearing Spindle
1888I	(1) West Wind 100,000 RPM Air Bearing Spindle
1888J	(1) West Wind 100,000 RPM Air Bearing Spindle
1888K	(1) West Wind 100,000 RPM Air Bearing Spindle
1888L	(1) West Wind 100,000 RPM Air Bearing Spindle
1888M	(1) West Wind 100,000 RPM Air Bearing Spindle
1888N	(1) West Wind 100,000 RPM Air Bearing Spindle
1888O	(1) West Wind 100,000 RPM Air Bearing Spindle
1888P	(1) West Wind 100,000 RPM Air Bearing Spindle
1888Q	(1) West Wind 100,000 RPM Air Bearing Spindle
1888R	(1) West Wind 100,000 RPM Air Bearing Spindle
1888S	(1) West Wind 100,000 RPM Air Bearing Spindle
1888T	(1) West Wind 100,000 RPM Air Bearing Spindle
1888U	(1) West Wind 100,000 RPM Air Bearing Spindle
1888V	(2) West Wind 100,000 RPM Air Bearing Spindles
1888W	(2) West Wind 100,000 RPM Air Bearing Spindles
1888X	(2) West Wind 100,000 RPM Air Bearing Spindles
1888Y	(2) West Wind 100,000 RPM Air Bearing Spindles
1888Z	(2) West Wind 100,000 RPM Air Bearing Spindles
1889	Contents of (2) Office Including: Office Desks, Office Chairs, (7) 4-Door Vertical File Cabinets, H-P Laser Jet 5N Laser Printer, (1) Gateway Pentium Computer Monitor, Keyboard & Mouse, (1) Brother & Intellifax Model 1270 Plain Paper Fax
1890	(3) 2-Door Vertical Storage Cabinets w/ Applicable Contents, (1) 2-Step Aluminum Ladder
1891	Storage Cabinet w/ Contents and Small Step Ladder
1899	SALE NOW CONTINUES IN BUILDING 3 SUB LEVEL ARTWORK GENERATION (LOTS 1900 - 1979)
1900	(1) 2006 Orbotech Model LP-9008I US Laser Drum Photo Plotter, s/n LP-063004, Complete w/ Autoload & Unloading Film Box & Sun Blade 150 Computer Controls & UPS

This catalog is a guide. The Auctioneers do not warrant the accuracy, genuineness, authenticity, description, weight, count or measure of any of the lots specified herein.

CATALOG FOR PHOTOCIRCUITS

Lot	Description
1901	_____ (2) Stainless Steel Mobile Shelf Units w/ Kenmore & Moist Air Dehumidifiers
1902	_____ (1) Dell OptiPlex GX110 Pentium 3 Computer w/ Monitor, Work Station, (2) Chairs, (1) 2-Door Metal Storage Cabinet w/ Contents
1903	_____ Digital Model 500A Personal Work Station w/ Monitor, Keyboard & Mobile Stainless Steel Shelf, Horizontal Lion Artwork Cabinets
1904	_____ (1) Dayton Wet/Dry Vacuum & Shop Vac 2-HP Vacuum, (2) Rubbermaid Carts & (1) Justrite Flammable Cabinet
1905	_____ (1) Leedal Stainless Steel Image Film Processing Sink
1906	_____ (1) Carnfeldt Model EG751PCB Film Processor, s/n 02502307
1907	_____ Powerware FE Series UPS
1908	_____ One Lot of Stainless Steel Wire Shelf Units
1909	_____ (3) Easi File Artwork Storage Cabinets
1910	_____ (5) Easi File Artwork Storage Cabinets
1911	_____ (5) Easi File Artwork Storage Cabinets
1912	_____ (5) Easi File Artwork Storage Cabinets
1913	_____ (5) Easi File Artwork Storage Cabinets
1914	_____ (2) Multi-Drawer Artwork Storage Cabinets
1915	_____ (3) Roll Around Heavy Duty Artwork Storage Cabinets
1916	_____ Liebert #1 Room Conditioner
1917	_____ One Lot of Artwork Storage Cabinets
1918	_____ (3) Light Tables
1919	_____ (3) Light Tables
1920	_____ (1) Stainless Steel Work Bench w/ Artwork Trays
1921	_____ (1) Stainless Steel Work Bench w/ Artwork Trays
1923	_____ (1) Stainless Steel Work Bench w/ Artwork Trays
1924	_____ (1) Stainless Steel Work Bench w/ Artwork Trays
1925	_____ (1) Stainless Steel Work Bench
1926	_____ (1) Stainless Steel Work Bench
1927	_____ (1) Stainless Steel Work Bench w/ 5-Drawer Blueprint Cabinet
1928	_____ (1) Stainless Steel Work Bench

This catalog is a guide. The Auctioneers do not warrant the accuracy, genuineness, authenticity, description, weight, count or measure of any of the lots specified herein.

CATALOG FOR PHOTOCIRCUITS

Lot	Description
1929	_____ (1) Desk w/ Film Cutter
1930	_____ Macbeth Model TB904 Film Densitometer
1931	_____ Macbeth Model TB904 Film Densitometer
1932	_____ (1) Green Metal Desk w/ Chair & Computer Table
1933	_____ (1) Dell OptiPlex GX1 Pentium 3 Computer w/ Monitor & Keyboard
1934	_____ H-P Laser Jet 4050N Laser Printer
1935	_____ (3) Chart Recorders
1936	_____ 1998 Optec V Series Video Inspection & Measurement System Model V2600, s/n 463
1937	_____ (7) Swivel Based Adjustable Shop Stools & Table
1938	_____ Computer Lot Consisting of: Gateway GP6-350 & GP-333 Pentium 2 Computers w/ Monitors & Keyboards, (2) Panasonic Quiet KX-P2130 Dot Matrix Printers
1939	_____ (4) Mobile Stainless Steel Wire Carts
1940	_____ (1) Stainless Steel Work Bench
1941	_____ ORC Model HMW-201B-5K Dual Drawer Exposure Unit Printer, s/n 18503, Complete w/ Hepa Filtration Unit & Ionic Static Bar Mylar Frames
1942	_____ Stainless Steel Work Bench
1943	_____ Agfa Model Rapiline 72-3HT Film Processor
1944	_____ Agfa Model Rapiline 72-3HT Film Processor
1945	_____ Light Table Roll Around Cart & Leedal Stainless Steel Film Processing Sink
1946	_____ (1) Artwork Punch w/ Cart
1947	_____ (2) Stainless Steel Wire Roll Around Carts & Stationary Stainless Steel Shelf Units
1948	_____ (2) Stainless Steel Work Bench w/ Shop Stool
1949	_____ (1) Glenbrook Model TEM22-2WP Diazo Film Developer
1950	_____ (1) Gateway 2000 GP6-266 Pentium 2 Computer w/ Keyboard & Monitor
1951	_____ One Lot of (5) Steel Roll Around Industrial Carts w/ Light Table & Plastic Artwork Trays
1952	_____ Multiline Manual Post Image Artwork Punch, s/n FPS-0011
1953	_____ (1) Light Table
1954	_____ Camtek Model 2V50 AOI
1955	_____ 1997 Camtek Model 2V50 AOI, s/n 338
1956	_____ 1998 Camtek Model 2V50AR AOI, s/n 540

This catalog is a guide. The Auctioneers do not warrant the accuracy, genuineness, authenticity, description, weight, count or measure of any of the lots specified herein.

CATALOG FOR PHOTOCIRCUITS

Lot	Description
1957	_____ (2) Stainless Steel Work Tables w/ (2) Shop Stools & Light Table
1958	_____ (1) Kyowa Stereo Microscope
1959	_____ (1) Kyowa Stereo Microscope
1960	_____ (1) Kyowa Stereo Microscope
1961	_____ Liebert Challenger 2 Room Conditioner
1962	_____ (1) Automatic Glass Sliding Clean Room Door
1963	_____ (1) 2-Door Metal Storage Cabinet, Film Storage Rack & Step Stool
1964	_____ (1) Revolving Dark Room Door, Bench & Wall Mounted Locker Unit
1965	_____ (1) Orbotech Model LP-5008X Xpress Laser Drum Film Plotter, s/n P294
1966	_____ (1) Orbotech Power Line Conditioner
1967	_____ (1) 1998 Barco Gerber Systems Prism AMT Laser Drum Photo Plotter, s/n 100
1968	_____ (1) Powerware FE Series UPS
1969	_____ Nortec Conair Room Wall Mounted Dehumidifier
1970	_____ 1999 Blak-Ray Long Wave Ultraviolet Lamp Model ML-49
1971	_____ (3) Stainless Steel Wire Shelf Units
1972	_____ (3) Chart Recorders
1973	_____ (1) Clean Room Floor System
1974	_____ Kyowa Stereo Zoom Microscope
1975	_____ Max Levey Autograph Glass Substrate Calibration Artwork Tool
1976	_____ One Lot Consisting of: Gateway Pentium 2 Computer, Bench, First Aid Kit, Water Cooler, Glass Panel Display Cabinet, (2) Steel Roll Around Carts, Locker Units
1977	_____ One Lot Tennsco Locker Units, (3) Stainless Steel Wire Shelf Units
1978	_____ (1) Ring Compressor
1979	_____ (1) Square D Bolt-Dash Lock, 1200 Amp Switch Gear, 6Hz Frequency, 480 Volts
1979A	_____ SALE NOW CONTINUES BUILDING 4, 2ND & 3RD FLOORS (Lots 1980-2242)
1980	_____ (1) Camtek AOI Systems CRP Reference Processor w/ Associated Monitor, Keyboard & Mouse
1981	_____ (1) Camtek AOI Systems CRP Reference Processor w/ Associated Monitor, Keyboard & Mouse
1982	_____ One Lot of (2) Gateway Tower Computers Model E-4200 & GP6-350 Both w/ CD-ROM's, 3.5 Floppy's, Monitors, Keyboards & Mice

This catalog is a guide. The Auctioneers do not warrant the accuracy, genuineness, authenticity, description, weight, count or measure of any of the lots specified herein.

CATALOG FOR PHOTOCIRCUITS

Lot	Description
1983	_____ One Lot of (2) Dell OptiPlex Pentium 3 Tower Computers w/ CD-ROM's, 3.5 Floppy's, (1) Dell Monitor, Keyboard and Mouse
1984	_____ (1) H-P Design Jet Model 430 Blueprint Printer
1985	_____ (1) Dahle Model 130 Paper Cutter w/ Table
1986	_____ (1) H-P Model 4050N Laser Jet Printer
1987	_____ (1) Dell Pentium 4 Tower Computer w/ CD-Rom, 3.5 Floppy, Monitor, Keyboard & Mouse
1988	_____ (1) H-P Visualize Model C360 Work Station Computer w/ Monitor, Keyboard, Mouse, (1) Brother & Intellifax Model 2750 Fax Machine
1989	_____ One Lot of (2) H-P Visualize Work Station Computers, (1) Gateway Model GP6-350 Tower Computer Associated Monitors, (2) APC Un-Interruptable Battery Back-Up Supplies
1990	_____ (1) H-P Visualize Model C360 Computer Work Station w/ Monitor, Keyboard, Mouse, (1) Dell OptiPlex Model GX110 Tower Computer w/ CD-ROM, 3.5 Floppy, Monitor, Keyboard & Mouse, (1) APC UPS
1991	_____ One Lot of (4) Gateway, (1) Dell Tower Computers, All w/ CD-ROM's, 3.5 Floppy's, Monitors, Keyboards & Mice, (1) H-P Visualize Model C360 Computer Work Station w/ Monitor, Keyboard & Mouse
1992	_____ (1) Computer Servers Enclosed Cabinet w/ Cisco Systems Catalyst 3500 Series XL Hub, (1) Dell Power Connect Model 3048 Hub, (2) Black Box CAT 5B Management Systems, (1) 3 Com Super Stack II Switch, (1) 3 Com Link Builder Model ECS4, (1) APC Model 2200 Un-Interruptable Battery Back-Up Supply, (1) H-P Sure Store Optical Storage Box Model 200FX
1993	_____ (1) Gateway 2000 GP5-200 Tower Computer w/ CD-ROM, 3.5 Floppy, Dell Monitor, Keyboard, Mouse, (1) Printer Table, (1) Calcom Scan Plus III 400T Blueprint Scanner
1994	_____ Contents of Office Including: Desk, Work Station Tables w/ Build In Light Table, (1) Folding Table, (1) Credenza, (2) Bookcases, (1) Metro Cart, (1) H-P Visualize C360 Work Station w/ Monitor, Keyboard, Mouse, (4) Chairs
1995	_____ (2) Sentry Model 1170 Fire-Proof Safes, (2) Sentry Model 1150 Fire-Proof Safes
1996	_____ Remaining Contents of Office Including: (3) Desks, (1) Table, (1) Metal Bookcase, (3) Swivel Based Office Chairs, (1) Large Whiteboard, (2) Space Heaters, (1) Fan
1997	_____ Contents of Office Including: Desk w/ Left Return, Small Circular Conference Table, (6) Office Chairs, Metal Bookcase, 4-Drawer Vertical File Cabinet, Whiteboard, Corkboard

This catalog is a guide. The Auctioneers do not warrant the accuracy, genuineness, authenticity, description, weight, count or measure of any of the lots specified herein.

CATALOG FOR PHOTOCIRCUITS

Lot	Description
1998	_____ Large Lot of Office Furniture Located Throughout Engineering Department Including But Not Limited To: Associated Office Partitions, Minimum of (16) 4-Drawer Vertical File Cabinets, Associated 2-Door Metal Storage Cabinets, All Work Station Desks w/ Applicable Left & Right Returns, Lower Cabinetry, Bookcases, Coat Racks, Stationary & Pneumatic Swivel Based Office Chairs, (3) Folding Tables
1999	_____ (1) Metro Data-Vac 2 w/ Accessories & Case
2000	_____ (1) Adjustable Medical Bed, (1) 2-Door Storage Cabinet w/ Medical Supplies, (2) Metal Medical Storage Cabinets w/ Supplies, (1) Wheelchair
2001	_____ (1) Adjustable Medical Bed, (1) Stainless Steel Wash Sink, (1) Desk, (1) Mini Refrigerator
2002	_____ One Lot of (2) First Aid Kits, (1) Respiratory Pack, (2) Life Save Emergency Oxygen Canisters, (1) Chemetron Air/Oxygen Canister
2003	_____ (1) Turitan Bennett Model BP100 Renaissance Spirometry System w/ Associated Manuals, H-P Desk Jet Model 842C Printer Cart, Associated Oxygen Masks, (1) 3-Liter Calibration Syringe
2004	_____ (1) Stereo Optical Company Vision Screener w/ Vision Tester Control & Stand
2005	_____ (1) Industrial Acoustics Company, Controlled Acoustical Cabinet w/ Maico Model MA800 Controller
2006	_____ Contents of Office Area Including (4) Hon 5-Drawer Lateral File Cabinets, (2) Desks, (2) Swivel Based Chairs, (1) Stationary Chair, (1) 2-Door Metal Storage Cabinet w/ Contents, (1) GBC Model 80S Paper Shredder, (2) Gateway Tower Computers w/ CD-ROM's, 3.5 Floppy's, (1) w/ Zip, Associated Monitors, Keyboards & Mice
2007	_____ Contents of Office Area Including Desk w/ Left Return, Dell OptiPlex GX1 Pentium Computer w/ CD-ROM, 3.5 Floppy, Monitor, Keyboard, Mouse, (1) Paper Shredder, (1) 2-Drawer File Cabinet, (1) 4-Drawer Vertical File Cabinets, (1) 2-Drawer Lateral File Cabinet, (1) H-P Laser Jet Model 4000N Printer, (1) Brother & Intellifax Model 2750 Fax Machine, (1) Swivel Based Chair
2008	_____ (19) Upholstered & Hardened Plastic Stationary Chairs, (3) Small Circular Cafeteria Style Tables, (1) Water Cooler
2009	_____ (1) Ceilcote Air Pollution Control Model HRP105-48M Industrial Scrubber, s/n 30109, w/ Models CLMR36 Blower Unit & Associated Pumps
2010	_____ (1) Ceilcote Air Pollution Control Model HRP105-48M Industrial Scrubber, s/n 30109, w/ Models CLMR36 Blower Unit & Associated Pumps
2011	_____ (4) Industrial Shelving Units, (1) 2-Door Metal Storage Cabinet w/ Associated Contents Including But Not Limited To: IS & Pal Line 3 Parts, Motors, Pumps, Brushes, Filters, Hoses, Wires, Bearing, Bushings, Gears, Installation, Rollers, Employee Lockers

This catalog is a guide. The Auctioneers do not warrant the accuracy, genuineness, authenticity, description, weight, count or measure of any of the lots specified herein.

CATALOG FOR PHOTOCIRCUITS

Lot	Description
2012	_____ (1) Aquafine Ultraviolet Disinfection Unit w/ Associated Filters
2013	_____ H-P Laser Jet Model 4000N Laser Printer
2014	_____ (5) Offices Complete w/ (4) Computers, Monitors, Keyboards, Printers, Desks, Chairs & Cabinets
2015	_____ One Lot of Penco Locker Unit & (4) Cafeteria Round Tables w/ Chairs, Refrigerator & Microwave
2016	_____ One Lot of Square D Switch Gear 480 Volts, 60 Hz Power Logic Circuit Monitors (Late Delivery-60 Days)
2018	_____ Contents of Office Including: Assorted Spare Parts, Furniture, Cabinets, Computer & Fax Machine, Excluding Machine Manuals
2019	_____ Contents of (1) Office & Conference Room Including: H-P Color Laser Jet 45N Printer, H-P Laser Jet 4000N Printer, Computers, Fax Machines, File Cabinets, Desk, Conference Room Table, Chairs
2020	_____ (2) Light Stands & 55 Gallon Drum Barrel Cart
2021	_____ Perfectest Model 3T Tester, s/n 1520
2022	_____ Walk Behind Electric Over Hydraulic Power Cable Fed Die Lift Table
2023	_____ Presto Walk Behind Electric Battery Operated Rechargeable Die Lift Table
2024	_____ (2) Wesco Hydraulic Die Lift Carts
2025	_____ (2) Hydraulic Pallet Jacks & Utility Cart
2026	_____ 1998 IS Model MOD.ACIDO 24" Preclean Line, s/n 0162116 Complete w/ Exit Dryer
2027	_____ 1995 IS Model MODULO.ACIDO 24" Preclean Line, s/n 0162011, w/ Exit Drying
2028	_____ IS Model Pumex 24" Outer Layer Pumice Scrubber, s/n 8818172
2029	_____ Transworld Circuit Products 24" Microetch Preclean Line
2030	_____ IS 24" Model Pumex Outer Layer Pumice Scrubber
2031	_____ IS 24" Model Pumex Outer Layer Pumice Scrubber
2032	_____ ASI Ninety #25 Series 24" Preclean Line
2033	_____ IS 24" Pumaflex Inter Layer Pumice Scrubber
2034	_____ (1) Rich Model AG-50 Panel Accumulator, s/n 20906
2035	_____ (1) Amtech Model Accumulator
2036	_____ (1) 2000 Amtech Model APA-50-28 Accumulator, s/n 4071
2037	_____ (1) 1998 Amtech Model API-50-32 Accumulator, s/n 3101
2037A	_____ Descon International Polypropylene Plating Tank
2038	_____ (1) CMI Coating Thickness Measurement Gauge w/ Gateway Computers, H-P Laser Printer, Monitors, Light Table

This catalog is a guide. The Auctioneers do not warrant the accuracy, genuineness, authenticity, description, weight, count or measure of any of the lots specified herein.

CATALOG FOR PHOTOCIRCUITS

Lot	Description
2039	_____ Approximately (20) PCB Handling Carts
2040	_____ (5) Rubbermaid Style Utility Carts
2041	_____ (1) IS Model Pumaflex.SHD.A Pumice Scrubber, s/n 0103767, w/ Exit Drying, Amtech Automation Conveyor, Chemcut 547 Rinse & Dry Unit
2042	_____ (1) 1996 IS 30" Strip Etch Strip Line, s/n 0697531, Stainless Steel & Titanium Chambers, Cupric Etcher, IS Resist Strip Filters
2043	_____ (1) 1996 IS 24" & 30" Develop Etch Strip Line Consisting of IS Developer, IS Titanium Cupric Etcher, IS Strip Master, s/n 0697531 w/ Resist Filters, Stainless Steel & Titanium Chambers
2044	_____ (1) Eidschun Model E95 Accumulator
2045	_____ (1) IS-Hollmuller Develop Etch Strip Line Consisting of 1995 IS DevMaster, Hollmuller Triple Chamber Etcher, 1995 IS Strip Master w/ Resist Filters
2046	_____ (1) Amtech Accumulator
2047	_____ 1995 IS & Hollmuller Develop Etch Strip Line Consisting of IS 24" Devmaster, Hollmuller Triple Chamber Etcher, IS Stripmaster w/ Resist Filters
2048	_____ 1995 IS Model MODUL.ACIDO 24" Acid Preclean, s/n 0162010
2049	_____ 1995 IS Model Pumex-2000 24" Pumice Scrubber, s/n 0063860, w/ Filtrex 2000 High Pressure Rinse Pump & SHD Exit Drying
2050	_____ US Filter De-Ionization Water System
2051	_____ (2) 2-Door Metal Storage Cabinet w/ Contents & Punch
2052	_____ (2) Spencer Ring Compressors
2053	_____ One Lot of 2-Door Storage Cabinets, Flammable Storage Cabinets & Tool Box w/ Contents
2054	_____ (1) Contents of Room Including: Numerous Roller For Develop Etch Strip Lines & Spare Parts
2055	_____ (2) Box Cooling Fans, Light Table & Cart
2056	_____ (1) Techni-Quip Corp. Video Inspection System
2057	_____ (1) 1998 Circuit Automation Model DP1500-V3.1 Screen Coater, s/n DP-1500-80164
2058	_____ (1) 1997 Circuit Automation Model DP1000-2X Screen Coater, s/n DP1000-3.1-80114
2059	_____ (1) Circuit Automation LPI Pump
2060	_____ (1) Contents of Room Including: Assorted Shelves w/ Contents, Screen Frame Chases & Wash Out Tank
2061	_____ Ichinose Model SMT-200 OIC Screen Coater
2062	_____ Ichinose Model SMT-200 OIC Screen Coater

This catalog is a guide. The Auctioneers do not warrant the accuracy, genuineness, authenticity, description, weight, count or measure of any of the lots specified herein.

CATALOG FOR PHOTOCIRCUITS

Lot	Description
2063	_____ Amtech Automation Model IR-75-28 Loader w/ Conveyor
2064	_____ (1) Airflow Room Conditioner
2065	_____ One Lot of Aluminum & Stainless Carts, Screen Frame Chases, 2-Door Metal Storage Cabinet w/ Contents & Shelf Units w/ Contents In Screen Coding Room
2066	_____ (1) 1995 Precision Quincy Model CB1.5-4M Conveyorized Curing Oven, s/n 11507-1
2067	_____ (1) 1995 Precision Quincy Model CB1.5-4M Conveyorized Curing Oven, s/n 11507-2
2068	_____ One Lot of Aluminum Carts w/ Aluminum Frame/Fingers For Conveyorized Tunnel Ovens
2069	_____ (1) Amtech Conveyor
2070	_____ Olec Model AX28 Automatic Exposure System, s/n AX28-06
2071	_____ Western Magnum In-Line Tacky Roller
2072	_____ Lohr Herrmann 360 Degree Rotating Panel Feeder w/ (2) Carts
2073	_____ Amtech Conveyor
2074	_____ Lohr Herrmann Panel Unloader w/ (2) Carts
2075	_____ C-Frame Arbor Press, Film Cutter, Cabinets & Light Table
2076	_____ Amtech Accumulator
2077	_____ Amtech Conveyor
2078	_____ 1998 ORC Model HMW-680GW Double Drawer Exposure Unit Printer, s/n 35691, 7 KW, Mylar Framed, Digital Microprocessor, Operation Terminal & UV Integrators
2079	_____ Olec Model AP30 6000 Titan Double Drawer Exposure Unit Printer, s/n 308020, Closed Loop
2080	_____ One Lot of Amtech Automation Conveyors
2081	_____ Stainless Steel Cart
2082	_____ One Lot of Multi Tiered Stainless Steel Wire Shelves, Stainless Steel Cart, Workbenches
2083	_____ Olec Model AP30 Power Plus High Resolution Dual Drawer Exposure Unit Printer
2084	_____ Video Inspection and Xenon RC-250B UV Spot Curing Unit
2085	_____ ORC Model EXM1350 Automatic Exposure Unit Printer
2086	_____ Lohr Herrmann Panel Stacker/Unloader
2087	_____ Amtech Divert Conveyor
2088	_____ Western Magnum Double Magtac Inline Substrate Cleaner, Model DSC-24, s/n 132RL
2089	_____ Lohr Herrmann Panel Feeder w/ Cart
2090	_____ Adtec Model ACP610 SCT Full Automatic UV Exposure System, s/n 980209

This catalog is a guide. The Auctioneers do not warrant the accuracy, genuineness, authenticity, description, weight, count or measure of any of the lots specified herein.

CATALOG FOR PHOTOCIRCUITS

Lot	Description
2091	_____ Western Magnum Model DSC-24 Double Magtac Inline Substrate Cleaner, s/n 101LR
2092	_____ Lohr Herrmann Panel Feeder
2093	_____ Amtech Divert Panel Conveyor
2094	_____ Lohr Herrmann Panel Stacker w/ Cart
2095	_____ 2006 Orbotech Discovery 8 Reflective Automatic Optical Inspection System, s/n PI063001
2096	_____ 2006 Orbotech Verismart Verification System, s/n MV063076
2097	_____ 1998 Camtech Model 2V50 AOI, s/n 382
2098	_____ 1997 Micro Vu Model M456 Video Measuring System, s/n 9627 w/ Computer Controls
2099	_____ 1995 Hakuto Model HAP3510C Automatic Exposure System Printer, s/n EP-079
2100	_____ Lohr Herrmann Panel Stacker w/ Cart
2101	_____ Amtech Diverter Panel Conveyor
2102	_____ Western Magnum Double Magtac Inline Substrate Cleaner, Model DSC-24, s/n 127LR
2103	_____ Lohr Herrmann Panel Feeder w/ Cart
2104	_____ Hakuto Model HAP3510C Automatic Exposure System Printer
2105	_____ Magtac Double Magtac Inline Substrate Cleaner, Model DSC-24
2106	_____ Lohr Herrmann Panel Feeder w/ Cart
2107	_____ Amtech Diverter Panel Conveyor
2108	_____ Lohr Herrmann Panel Stacker w/ Cart
2109	_____ Air Flow Systems Room Conditioner
2110	_____ Nortec Room Dehumidifier
2111	_____ One Lot of Assorted Clean Room Polypropylene Storage Units
2112	_____ One Lot of Clean Room Panel Holders
2113	_____ 1997 Camtek Model 2V50 AOI, s/n 319
2114	_____ Amtech Accumulator and Conveyor
2115	_____ Desk w/ Dell Optiplex Pentium III Computer, HP Laser Printer
2116	_____ Amtech Model CON-36-28 Conveyor
2117	_____ Lohr Herrmann Rack Loading Cart
2117A	_____ Amtech Model CON-48-28 Conveyor, s/n 3172
2118	_____ Amtech Model CON-48-28 Conveyor, s/n 3214
2119	_____ One Lot of Board Holders

This catalog is a guide. The Auctioneers do not warrant the accuracy, genuineness, authenticity, description, weight, count or measure of any of the lots specified herein.

CATALOG FOR PHOTOCIRCUITS

Lot	Description
2120	_____ Lohr Herrmann Cart Rack
2121	_____ Liebert Room Conditioner w/ CDP Dehumidifier
2122	_____ Carrier Model 40RMS012-500GC Room Air Conditioner
2123	_____ Vacuum Frame Template w/ Gas Vacuum Pump and Stainless Steel Worktable
2124	_____ Ono-Sokki Model TN-890B Automated Exposure System w/ Ono-Sokki Model TN-117 Image Processor
2125	_____ Ono-Sokki Model TN-890B Automated Exposure System w/ Ono-Sokki Model TN-117 Image Processor
2126	_____ Western Magnum Double Magtac Inline Substrate Cleaner, Model DSC-24
2127	_____ Western Magnum Double Magtac Inline Substrate Cleaner, Model DSC-24
2128	_____ Lohr Herrmann Panel Feeder w/ Cart
2129	_____ Lohr Herrmann Panel Stacker w/ Cart
2130	_____ Contents of Room Including: Easy File Artwork Storage Cabinet, (2) Rigid Shop Vacs, Film Cutter, S.S. Storage Racks, Rubbermaid Cart, Artwork Templates
2131	_____ 1998 Asahi Model ACL-9100MV Automatic Dry Film Cut Sheet Laminator w/ Built In Pre Heaters
2132	_____ 1998 Asahi Model ACL-9100MV Automatic Dry Film Cut Sheet Laminator w/ Built In Pre Heaters
2133	_____ 1998 Asahi Model ACL-9100MV Automatic Dry Film Cut Sheet Laminator w/ Built In Pre Heaters
2134	_____ 1998 Asahi Model ACL-9100MV Automatic Dry Film Cut Sheet Laminator w/ Built In Pre Heaters
2135	_____ Western Magnum Double Magtac Inline Substrate Cleaner Model DSC-24
2136	_____ Western Magnum Double Magtac Inline Substrate Cleaner Model DSC-24
2137	_____ Western Magnum Double Magtac Inline Substrate Cleaner Model DSC-24
2138	_____ Western Magnum Double Magtac Inline Substrate Cleaner Model DSC-24
2139	_____ Amtech Cool Down Conveyor
2140	_____ Amtech Cool Down Conveyor
2141	_____ Amtech Cool Down Conveyor
2142	_____ Amtech Cool Down Conveyor
2143	_____ Lohr Herrmann Panel Stacker w/ Cart
2144	_____ Lohr Herrmann Panel Stacker w/ Cart
2145	_____ Lohr Herrmann Panel Stacker w/ Cart
2146	_____ Lohr Herrmann Panel Stacker w/ Cart
2147	_____ Amtech Divert Panel Conveyor
2148	_____ Amtech Divert Panel Conveyor

This catalog is a guide. The Auctioneers do not warrant the accuracy, genuineness, authenticity, description, weight, count or measure of any of the lots specified herein.

CATALOG FOR PHOTOCIRCUITS

Lot	Description
2149	Amtech Divert Panel Conveyor
2149A	Amtech Divert Panel Conveyor
2150	Lohr Herrmann Panel Automation Cart
2151	Movin Classic Plus 26 Portable Spot Cooling Unit, Rubbermaid Roll Around Tool Box w/ Contents and Aluminum Framed Film Cart
2152	Aluminum Framed Plexiglass Cleanroom Enclosure Including Walls and Door
2152A	Air Shower
2153	One Lot of Lockers, Foremans Desk, Lohr Herrmann Carts, Bench
2153A	Air Flow Room Conditioner
2154	Contents of Room Including Various Spare Parts, Shelves, Cabinets w/Parts for DES Line, Automatic Exposure Unit
2155	1994 IS Model Devmaster.MKII 24" LPI Developer, s/n 0752001 w/ Exit Drying and Uniop Microprocessor Controls
2156	1995 IS Model Devmaster LPI Developer, s/n 0757499 w/ Uniop Microprocessor Controls and Exit Drying
2157	Shiplely CDD Controllor
2158	Shiplely CDD Controllor
2159	1995 Precision Quincy Model CB1-04-2 Conveyorized Tunnel Curing Oven, s/n 11506-1
2160	1995 Precision Quincy Model CB1-04-2 Conveyorized Tunnel Curing Oven, s/n 11506-2
2161	Amtech Automation Tote Loader w/ Conveyor, Model IRHD-75-32, s/n 1158
2162	Amtech Conveyor
2163	Sea Sun Conveyorized UV Curing Oven
2164	Amtech Tote Loader, Amtech 90 Degree Diverter, Model IRHD-75-32, s/n 1157
2165	Amtech Conveyor
2166	(2) 2-Door Strong Hold Storage Cabinets w/ Contents
2167	US Filter DI Water Filtration System
2168	Soldermask Stripping Tank w/ Plenim Hood and Hoist
2169	One Lot of Shelves and Workbenches
2170	MSC Model 951230 1/2 HP Pedestal Drill Press
2171	Shimadzu Model AA-6800 Atomic Absorption Spectrophotometer Complete w/ Acer Computer Controls, Numerous Spare Lamps

This catalog is a guide. The Auctioneers do not warrant the accuracy, genuineness, authenticity, description, weight, count or measure of any of the lots specified herein.

CATALOG FOR PHOTOCIRCUITS

Lot	Description
2172	_____ ECI Qualiplate Model QP4000 Plating Bath Analysis System w/ Measuring Stand
2173	_____ One Lot of Assorted Lab Equipment Including Kocour Model A83 Stirrer, Gralab Timer, Accu-Lab V-600 Digital Gram Scale, Hot Plate
2174	_____ (2) Metrohm
2175	_____ Metrohm Ion Analysis Model CH-9101/736 GP Titrimo
2176	_____ (3) Pipette Stands
2177	_____ Fisher Scientific Thermolyne Hot Plate
2178	_____ One Lot of Assorted Lab Gear Including Assorted Pipettes
2179	_____ One Lot of Pipette Stands, Fisher Scientific Auto Mixers, Orion PH Meter
2180	_____ One Lot of Copper Cell Plates
2181	_____ Fisher Scientific Accu-Mat Model 25-PH-Ion Meter
2182	_____ Omega Model CDB-410 PH Meter
2183	_____ Fisher Scientific 500 Series Isotemp Laboratory Bench Oven
2184	_____ One Lot of Slate Top Metal Based Lab Furniture w/ Sink, Hamilton Fume Hood
2185	_____ Nuova Stir Plate
2186	_____ (2) RSE DC Power Supply Lab Rectifiers
2187	_____ Bausch & Lomb Spectronic Model 601
2188	_____ Mettler AE200 Digital Balance, Desiccator Cabinet
2189	_____ Shipley Electro-Posit Bath Analyzer
2190	_____ Hitachi Model U-2000 Spectrophotometer
2191	_____ Eagle 2-Door Chemical Storage Cabinet
2192	_____ One Lot of Locker Units
2193	_____ Delta Bench Model Drill Press
2194	_____ HP LaserJet Model 4000N Laser Printer
2195	_____ Dell Optiplex Model GX110 Pentium II Computer w/ Monitor, Keyboard
2196	_____ 2-Door Metal Storage Cabinet w/ Contents of Assorted Lab Supplies and File Cabinets
2197	_____ One Lot of Office Furniture w/ Swivel Chairs, Brother Fax Machine, Dell Optiplex GX1 Pentium III Computer and Monitor

This catalog is a guide. The Auctioneers do not warrant the accuracy, genuineness, authenticity, description, weight, count or measure of any of the lots specified herein.

CATALOG FOR PHOTOCIRCUITS

Lot	Description
2198	_____ Contents of Office Including Dell Optiplex GX1 Tower Computer w/ CD Rom, 3.5" Floppy, Monitor, Keyboard, Mouse, HP DeskJet 932C Printer, (2) Desks, (2) 4-Drawer Vertical File Cabinets, (1) 2-Drawer Vertical File Cabinet, (1) Swivel Based Pneumatic Office Chair, Wall Hung Air Conditioning Unit
2199	_____ Century Scrubber w/ Conveyor, Brush, Rinse, Blower and Dryer
2200	_____ Amtech Accumulator, (1) Amtech Conveyor Section
2201	_____ Century Stainless Steel Dryer, s/n 99066
2202	_____ Timesavers Approx. 30" Cap. Sander w/ Allen Bradley PanelView 550 Controller
2203	_____ Timesavers Approx. 30" Cap. Sander w/ Allen Bradley PanelView 550 Controller
2204	_____ Lot of (2) Amtech Automation Conveyor Sections
2205	_____ Dynachem Accumulator
2206	_____ Amtech Conveyor Section w/ Built In Tote Loader/Accumulator
2207	_____ 1993 IS 2000A Dryer, s/n 0046488 w/ Associated Control
2208	_____ Leco Model BG-30 Buffer/ Polishing Unit for Silicon, Zirconium, Aluminum
2209	_____ Manual Benchtype Punch Press w/ Bench
2210	_____ CMI Coating Measurement Instruments Thickness Tester w/ Associated Gateway Computer, Monitor, Keyboard, Mouse and Cabinet
2211	_____ Pedestal Based Floor Fan, Shipping/Receiving Desk, S.S. Organizing Rack, (3) Folding Ladders, (2) 2-Door Metal Storage Cabinets w/ Contents, Numerous Employee Lockers, (4) Craftsman Roll Around Tool Boxes, Applicable Contents, Pneumatic Hose Reel
2212	_____ Ingersoll Rand Model T30 2475N7.5 7.5 hp Vertical Air Compressor, s/n 30T-91275
2213	_____ Famco Approx. 36" 16-Gauge Cap. Foot Shear
2214	_____ O'Haus Adventurer Digital Gram Scale w/ Enclosed Case and Workbench
2215	_____ One Lot of (3) Stainless Steel Adjustable Tool Return Carts, (1) Metro Rack w/ Casters
2216	_____ One Lot of (3) Metro Racks w/ Casters Enclosed w/ Polypropylene
2217	_____ (3) Butcher Block Top Workbenches, (1) Metal Workbench, (3) Computers w/ (2) Monitors, Keyboards, Mice
2218	_____ One Lot of (5) Cylindrical Polypropylene Chemical Storage Tanks Ranging from Approx. 280 Gallon - 1,000 Gallon, Associated Diaphragm Pumps
2219	_____ One Lot of (2) Hi-Density Polypropylene Chemical Storage Tanks (1) 1600 Gallon, (1) 1900 Gallon, Associated Diaphragm Pumps

This catalog is a guide. The Auctioneers do not warrant the accuracy, genuineness, authenticity, description, weight, count or measure of any of the lots specified herein.

CATALOG FOR PHOTOCIRCUITS

Lot	Description
2220	_____ One Lot of (3) Cylindrical Polypropylene Chemical Storage Tanks Including 40 Gallon, 300 Gallon, 6,000 Gallon Cap. w/ Associated Diaphragm Pumps
2221	_____ SII Hi-Density Polypropylene Cylindrical Storage Tank 8,430 Gallon Cap. w/ Associated Pumps
2222	_____ Horizontal Stainless Steel 6,700 Gallon Cap. Vessel/Storage Tank Currently Used for Hydrogen Peroxide w/ Associated Diaphragm Pumps
2223	_____ Approx. (8) Stainless Steel Cement Wall Ladders, Each w/ 2' Platform
2225	_____ 482 Gallon Cap. Chemical Storage Tank, 6,000 Gallon Cap. Chemical Storage Tank, 2,000 Gallon Cap. Polypropylene Chemical Storage Tank, Stainless Steel Storage Tank, 500 Gallon Polypropylene Storage Tank, Associated Diaphragm Pump
2226	_____ Tank Farm Including (5) Large Cap. Vertical Storage Tanks, Sizes Including: 5,300 Gallon, (2) 10,000 Gallon, 8,000 Gallon, 4,000 Gallon, Associated Diaphragm Pumps
2227	_____ Harrington 1-Ton Cap. Electric Chain Hoist w/ 2,000 Lb. Cap. Beam, Associated Trolley, Moving Strap
2228	_____ Dayton Lockable Job Box w/ Contents
2229	_____ Dayton Lockable Job Box w/ Contents
2230	_____ Contents of Tank Farm Including Minimum of (8) Hi-Density Polypropylene Chemical Storage Tanks, Sizes Ranging from 300 Gallon - 4,100 Gallon, All Associated Diaphragm and Water Pumps, Located Within Cement Structure of Tank Farm
2231	_____ (8) Water Pumps, (1) Polypropylene Storage Tank, Approx. 400 Gallon Cap.
2232	_____ H2O Solutions Inc. Water Filtration System w/ (3) Polyethylene Composite Tanks w/ Associated Filter Units
2233	_____ IPS Manual Dip/Plating Line, Associated Tanks, Flight Bars, Process Heaters, Filters, Pumps, Associated Plumbing, Controls, Plating Baskets, Stainless Steel Operators Platform
2234	_____ (2) CM Valuestar 1/2 Ton Cap. Overhead Electric Chain Hoist w/ Associated Trolleys
2235	_____ Marseco Scrubber
2236	_____ Amtech Tote Unloader
2237	_____ 1996 IS Type Modulo-Acido Preclean Acid Wash, s/n 0162039
2238	_____ Cemco Alchemy Type C HASL Complete Hot Air Horizontal Soldering Line w/ Entrance Heating/Drying Unit, Used to Dry Acid Wash w/ Ventilation System, Leveling Machine w/ Associated Exit Conveyor, Allen Bradley PanelView 1400E Display
2239	_____ 1996 IS Type Devmaster Post Cleaner, s/n 0757555
2240	_____ American Door 10' Cap. Rolling Door

This catalog is a guide. The Auctioneers do not warrant the accuracy, genuineness, authenticity, description, weight, count or measure of any of the lots specified herein.

CATALOG FOR PHOTOCIRCUITS

Lot	Description
2241	(2) Ziamatic Corp. Self Containing Breathing Apparatus, Model MMWC-1 w/ Wall Hung Cabinets, (1) Sellscom Spill Control Wall Hung Station
2242	Ingersoll Rand Sierra-H200 Portable Rotary Screw Oil Free Air Compressor, 200 hp, 861 CFM, Rated Operating Pressure, 125 PSIG, Max. Discharge Pressure 138 PSG, Nominal Fan Motor, 10 hp, Total Package Amps 256, 460 Volts, 3-Phase, 60 Hz, Compactor Amp Rating 300, Assembly Amp Rating 520, Locked Rotor Amp Rating of Assy. 6600, s/n TS0695U97090, Approx. Hours 30,000 w/ Intellisys Microprocessor Control, Cuttler-Hammer Heavy Duty Safety Switch, 400 Amp, 600 Volt, Mounted on 1997 Aros Mfg. Dual Axle Trailer w/ Bearing Buddies, Lockable Job Box, Front Jack Stand, GAWR 4400, GVWR 9500, Model E66-10HTS, Tire Size 750-60LRD, Trailer ID# 1AXFF26C6DA007702 w/ Electric Brake Package, Workable Lights
2242A	SALE CONTINUES IN BUILDING 3 AND OUTSIDE AREAS (LOTS 2243 - 2272)
2243	1996 Atlas Copco Type ZR250 Air Compressor, s/n AIF-028553, NOTE: UNIT MISSING MAIN MOTOR
2244	Hankison Model PR1600 Air Dryer, s/n 0370-5-9610-8
2245	Vertical Air Storage Tank
2246	Hydr-O-Thrift Air Filtration and Pump Skid
2247	Custom Fabricated Cabinet w/ Contents, Industrial Workbench w/ Vise and Overhead Fume Hood
2248	Delta Pedestal Based Drill Press w/ Vise
2249	Wall Mounted Cantilever Style Rack w/ Contents
2250	(2) 2-Door Metal Storage Cabinets w/ Contents, Industrial Rack w/ Contents, (4) Workbenches w/ (2) Vices and Applicable Contents, Layup Cart, (2) Hose Reels
2251	Southbend Lathe w/ Toolpost Holder
2252	Lincoln Electric Model AC/DC 225/125 Arc Welder, s/n 8811-711
2253	Lincoln Electric Model AC/DC 225/125 Arc Welder, s/n 9221-621
2254	(2) Craftsman Roll Around Tool Boxes w/ Applicable Contents
2255	Wissot Model E-7W Double End Bench Grinder w/ Pedestal
2256	Baldor Class D Model 607W Double End Bench Grinder w/ Pedestal
2257	Lot of Fiberglass and Polypropylene Chemical Storage Tanks, Capacities 3,400 Gallon, 4,000 Gallon, 1,900 Gallon, 150 Gallon, and 200 Gallon
2258	Raymond Model 20I-R30TT 3,000 Lb. Cap. Electric Reach Forklift, s/n 020D-93-34613 w/ Hobart Model 250C II Battery Charger

This catalog is a guide. The Auctioneers do not warrant the accuracy, genuineness, authenticity, description, weight, count or measure of any of the lots specified herein.

CATALOG FOR PHOTOCIRCUITS

Lot	Description
2259	_____ CMI Coating Measurement Instruments Thickness Tester w/ Canon Model BJ-200EX Bubble Jet Printer, Associated Magnification Lamp, Bench, Gateway E-5200 Pentium Computer w/ CD Rom, 3.5" Floppy, Monitor, Keyboard, Mouse and Chair
2260	_____ Denso Spot Cool Model 30A2 Portable Air Conditioning Unit
2261	_____ (6) 4-Drawer Vertical File Cabinets, (2) Workbenches, (3) Computers w/ Associated Monitors, Keyboards, Mice, Cabinet
2262	_____ Benchtop Manual Punch Press
2263	_____ Century Renegade-400 4-Brush Scrubber w/ Associated Controls, (1) Amtech Conveyor Section
2264	_____ Complete 1997 Industrial Scrubber Unit w/ Associated Blower, Duct Work, Croll-Reynolds Carbon Absorber Vessels, Process Gas Flow, 9060 ACFM, @ 130 Degrees F., Regen Steam Flow, 2,500 Lb/HR @ 350 Degrees F @ 12 PSIG, Associated Controls
2264A	_____ (1) 8,500-Gallon Polypropylene Storage Tank w/ Storage Tank Level Indicator, LED Read Out, Goulds Pumps Model Aquavar Pump System
2265	_____ One Lot of (2) High Density Polypropylene Cylindrical Chemical Storage Tanks, 3,000 Gallon Cap., Associated Diaphragm Pumps
2266	_____ Carrier Model 30GT-025-C610 Liquid Chiller/Air Conditioning Unit, s/n 0595F31489
2267	_____ 2004 York Model YCAL0064EC46X CASXTXLXXRLXCXX44SXXXXXXXXWSAXXBXXXXXXXXHXXXXXX Chiller, s/n RBNM007569, Refrigerant Type 22
2268	_____ Evapco Inc. Model LSTA 8T-241 Cooling Tower s/n 951828m Belt # B-130 w/ (4) Process Cooling Fans, Associated HVAC Pumps, Square D Controls
2269	_____ Evapco Inc. Model ICT-4-79 Water Tower w/ (2) Associated Process Cooling Fans, s/n 5512271
2270	_____ Industrial Scrubber, #34 w/ Associated Fiberglass Storage Tank, Stainless Steel Scrubber Housing, Associated Temperature Probes, Low Level Switches, Pumps, Motors, NWL Transformers w/ Graphic Voltage Controller, Associated Signet Digital Controls, Foxborough 873 PH/ORP Analyzer, Associated Ductwork, Mezzanine Structure
2271	_____ Carrier Model 30GT-050-600KA Liquid Chiller, s/n 0993F36417
2272	_____ Hydr-O-thrift Model FCVY-4312-22 Water Tower w/ (4) Process Chilling Fans, s/n 472249-01
2299A	_____ SALE CONTINUES BUILDING 45A (LOTS 2300 - 2484)
2300	_____ Portable Heating Unit

This catalog is a guide. The Auctioneers do not warrant the accuracy, genuineness, authenticity, description, weight, count or measure of any of the lots specified herein.

CATALOG FOR PHOTOCIRCUITS

Lot	Description
2301	_____ Foote Cement Mixer
2302	_____ Knaack Job Box w/ Contents Including: Large Cap. Metal Lifting Cable
2302A	_____ (1) Knaack 2-Door Gang Box
2303	_____ Huski Job Box w/ (2) Greenlee Model 687 Screw Type Wheel Stand, (3) CMM Manual Chain Hoists, Rigging Hooks, Straps, Chains
2304	_____ Custom Job Box, Wooden Construction, w/ Contents Including: Machinery, Rollers, Riggers Jacks, Cables, Straps
2305	_____ Milwaukee 10" Concrete Boring Drill
2306	_____ Lot of Werner & Louisville Folding Ladders, Numerous Shovels and Brooms
2307	_____ Lot of Electrical Supplies Including Conduit, & Wire
2308	_____ Rigging Skate Set
2309	_____ Ready Heater Pro 110,000 BTU Kerosene Heater, (1) Master Model DLP 155 Propane Heater, Fostoria Electric Fan Blown Heater
2310	_____ One Lot of (3) Johnson Bars
2311	_____ Contents of Office Including (2) Desks, w/ Associated Overheads, (2) Wall Hung Cabinets, 4-Drawer Vertical File Cabinet, Custom Wooden Bookcase, 2-Drawer Vertical File Cabinet, (2) Swivel Based Chairs, Whiteboard, Corkboard, Dell Optiplex GX1 Pentium III Computer w/ CD Rom, 3.5" Floppy, Monitor, Keyboard, Mouse, HP Deskjet Model 697C Printer
2311A	_____ Panametrics-NTD Snake Eye II Infrared Meter
2311B	_____ Panametrics-NTD Model 37DL Plus Ultrasonic Thickness Gauge w/ Power Supply and Probe
2311C	_____ Alnor Series 6000P Volumeter Complete w/ Multiple Probes
2311D	_____ Veeco Model 12510-14 AU/EN/XX/XRF Thickness Standard
2312	_____ Craftsman Model 919-167241 Portable Air Compressor, 150 PSI Max, 3 HP 15-Gallon
2313	_____ Homak Roll Around Tool Box w/ Applicable Tools
2314	_____ Homak Roll Around Tool Box w/ Applicable Tools
2315	_____ Craftsman Roll Around Tool Box w/ Applicable Tools
2316	_____ Speedaire Model 1VW40 Portable Air Compressor, s/n L5/28/03-00136, 4-Gallon Cap.
2317	_____ Laramy Products Plastic Welding Torch w/ Case
2318	_____ Hilti Model DX350 Piston Drive Tool w/ Case
2319	_____ Hilti Model TE10 Electric Impact Drill w/ Case

This catalog is a guide. The Auctioneers do not warrant the accuracy, genuineness, authenticity, description, weight, count or measure of any of the lots specified herein.

CATALOG FOR PHOTOCIRCUITS

Lot	Description
2320	_____ Burndy Hydraulic Hy-Press w/ Associated Tooling and Case, Binks Portable Air Compressor
2321	_____ Partner Chain Saw
2322	_____ Echo Model PB-46HT Gas Powered Back Pack Air Blower
2323	_____ Ryobi Abrasive Cut Off Saw
2324	_____ Hydraulic Mfg. Co. Kinetic Water Lam w/ Case, (1) Mec-O-Matic Pump
2325	_____ Hilti Model TE74 Electric Impact/Concrete Drill w/ Associated Disk
2326	_____ Milwaukee Sawzall
2327	_____ Milwaukee Sawzall
2328	_____ Milwaukee 7-1/4" Circular Saw
2329	_____ GE Hotpoint Refrigerator & Tennsco Locker Units
2330	_____ Makita Model 2414 Abrasive Cutoff Saw w/ Stand
2331	_____ (3) Butcher Block Workbenches
2332	_____ Contents of Room Including Shelf Units, (5) Roll Around Carts, PVC Valves & Fittings
2333	_____ Contents of Room Including Assorted PVC Fittings, Square D, Kuttler Hammer, Switch Gear, Electrical Fitting Spare Parts, Tool Cabinet, Carts
2334	_____ Dayton Model 3Z293A 6" Belt/9" Disk Sander
2335	_____ Jet 16-Speed Pedestal Mounted Drill Press Model TT-18F, 230 RPM - 3200 RPM's, w/ Chuck & Drill Vise
2336	_____ Dayton Model 1Z853M 8" Pedestal Mounted Bench Grinder
2337	_____ One Lot of (2) Ridgid Wet Dry Shop Vacs
2339	_____ One Lot of (4) 6" PVC Butterfly Disk Valves, Max Pressure 150 Lbs Per Square Inch at 70 Degrees F.
2341	_____ Jet 10" Table Saw w/ Precision Fence Model JWTS-10CW2-LFR, w/ 1-1/2 HP Motor, s/n 90200243
2342	_____ Ridgid Model 141 2-1/2" - 4" Jam Proof Pipe Threader, w/ Ridgid Drive Shaft
2343	_____ Ridgid Manual Pipe Threading Set w/ (1) Die Handle, (1) 3/4" Threading Die, (1) 1" Threading Die, (1) 1-1/4" Threading Die, (1) 1-1/2" Threading Die, (2) 2" Threading Dies, (1) Pipe Cutter, (1) Pipe Reamer
2344	_____ Greenlee Hydraulic Pump
2345	_____ Greenlee Pipe Bending Set w/ Large Pipe Bending Dies w/ Roll Around Case
2346	_____ Greenlee Model 882 Flip Top Bender w/ Bending Dies
2347	_____ Ridgid Model 450 Tri-Stand Pipe Bender, 0-5" Pipes, w/ (1) Deadman
2348	_____ Ridgid Model 300 Electric Pipe Threader w/ Lubrication Recovery System
2349	_____ One Lot of (8) Various Manual Pipe Benders

This catalog is a guide. The Auctioneers do not warrant the accuracy, genuineness, authenticity, description, weight, count or measure of any of the lots specified herein.

CATALOG FOR PHOTOCIRCUITS

Lot	Description
2350	_____ Greenlee Model 884 1-1/4" - 4" Portable Hydraulic Pipe Bender w/ Roll Around Case
2351	_____ Greenlee Model 670 Portable Pipe Bending Kit w/ Roll Around Case
2352	_____ Greenlee Model 1731 1" Deep Throat Knock Out Punch Driver
2353	_____ Kent Pneumatic Jack Hammer
2354	_____ (1) 2-Door Storage Cabinet w/ Contents Including But Not Limited to: Miscellaneous Core Board, Diamond Drilling Bits for Jack Hammer, Anderson Portapower, Miscellaneous Knock Out Punch Dies
2355	_____ (4) Sections of Metal Shelving & Contents Including But Not Limited to: Miscellaneous Conduit, Connectors, Elbows, L's, T's, Fasteners, Bulk Metal and PVC, Box of Miscellaneous Wire
2357	_____ (2) 4-Wheel Roll Around Carts w/ Removal Shelves & Contents Including But Not Limited to: Miscellaneous Sized Fuses, Plugs, Switches, Kindorf Clamps
2358	_____ (2) 2-Door Storage Cabinets w/ Contents Including But Not Limited to: Miscellaneous Plastic Valves Various Sizes, Rack Valves Various Sizes, Ridgid Threading Dies, Miscellaneous Hilti Double Expansion Shield Fasteners
2359	_____ (1) Protectoseal 30-Gallon 2-Door Flammable Storage Cabinet
2360	_____ One Lot of (1) Metal Shelving Units & Contents Including But Not Limited to: Nuts, Bolts, Tubing, 4-5" Flanges, Various Sized and Shaped Copper Fittings, Brass Fittings, PVC Fittings & Metal Fittings, Metal Strapping, (3) 6" PVC Swing Valves, Various Other Plumbing Supplies
2361	_____ One Lot of (2) Stainless Steel Metro Racks w/ Contents Including But Not Limited to: Various Steel Fittings, T's, Elbows, Brass Ball Valves, Filters, Pipe Insulation, Various Copper Fittings & Straps, Small Parts Storage Cabinet, 7-Tier Storage Cabinet
2362	_____ Remaining Contents of Area Including But Not Limited to: (1) 8' x 30" Butcher Block Style Workbench w/ Lower Shelving, (2) 6' x 30" Butcher Block Top Workbench w/ Lower Shelving and Cabinetry, (2) Small Parts Storage Cabinets, (2) 2-Door Storage Cabinet & Contents Including But Limited to: Miscellaneous Bags, Screws, Nails & Assorted Fasteners
2363	_____ Miller Syncrowave 250 CC-AC-DC Welder, Model 903056, 200/230/460 Volts, 1 PH, 60 Hz
2364	_____ Miller Econotig CC-AC-DC Welding Power Source, Complete w/Arc Starter
2365	_____ Lincoln Wirematic-255 Constant Voltage DC Arc Welding Power Source Complete w/ Wire Feeder
2366	_____ MSC Milling and Drilling Machine, Model 9512906 Complete w/ 24" x 62" T-Slotted Table, Y, X, Axis, Misc. R8 Collet, Strapping Tools, (1) Bridgeport Milling 6" Vice Complete w/ Rotary Base
2367	_____ Milwaukee Model 5051 3/4 HP Pedestal Mounted 8" Bench Grinder w/ Deadman

This catalog is a guide. The Auctioneers do not warrant the accuracy, genuineness, authenticity, description, weight, count or measure of any of the lots specified herein.

CATALOG FOR PHOTOCIRCUITS

Lot	Description
2368	_____ Clausing 330 RPM - 4000 RPM Pedestal Mounted Drill Press w/ Adjustable Height Table, 4" Vice
2369	_____ Milwaukee Model 6480 8" Panel Saw Mounted in Sheet Cutting Frame
2370	_____ Hitachi 15" Miter Saw
2371	_____ Milwaukee Model 6175 14" Abrasive Cut Off Saw, s/n 97213168
2372	_____ EFAB Model PCM-500I Cutting Torch
2373	_____ Nexel Stainless Steel 4-Tier Roll Around Cart w/ Misc. Conveyor Chains
2374	_____ One Lot of Misc. Metals, (2) Carts, (1) Rietschle Model REL-3503-01 Blower Motor
2375	_____ (4) 2-Door Metal Storage Cabinets and Contents Including: Misc. Switches, Relays, Kindorf Clamps, Roller Chain, Belts, Spools of Wire, Servo Motors, Assorted Reliance Electric VS Drive Motors
2376	_____ One Lot of Misc. Electrical Supplies and Spare Parts Including: Switches, Relays, Reliance Electric VS Drive Starter, (2) Fostec Fiber Optic Light Sources, Springs, Rollers, Casters
2377	_____ 55-Gallon 2-Door Flammable Storage Cabinet, (1) 24-Gallon Single Door Flammable Storage Cabinet
2378	_____ 2-Door Storage Cabinet and Contents Including: Misc. Welding Rod
2379	_____ Approx. 72" x 30" Metal Workbench w/ Lower Shelving, (2) Vices, (2) Metal Storage Racks, Misc. Contents Including: Flow Meters, Wire, Switches, Relays, Cable Protectors, Various Other Metal Scrap
2380	_____ (3) Sections of Penco 6-Locker Locker Sets, 4-Drawer Vertical File Cabinet, 2-Drawer Vertical File Cabinet, Ebtech Water Cooler/Heater
2381	_____ Control Techniques Model Mentor II Drive Controller
2382	_____ Strong Hold 2-Door Storage Cabinet w/ Misc. Contents Including: Vaccon Vacuum Pumps, Vaccon ST Series Silencers, Switches, Probes
2383	_____ (2) Sections of Pallet Racking w/ (4) 8' Uprights, (12) 12' Long Crossmembers, Contents Including: Misc. Control Panels, Reliance Model SP500 VS Drives, Rollers, Blowers, Misc. Drive Motors, Work Area PC, Misc. Filters
2384	_____ Remaining Contents of Room Including: Panel Cart w/ Misc. Lexan Polypropylene Sheeting, Wooden Storage Rack w/ Misc. Laxan Polypropylene Sheeting, (2) Metal Storage Racks and Contents Including: Misc. PVC Fittings, Flanges, Plugs, Other Assorted Fittings, (1) 60" x 30" Butcher Block Top Workbench w/ Upper and Lower Shelving, Welbilt Refrigerator, Sanyo Microwave Oven
2385	_____ One Lot of (2) Approx. 250 Gallon Storage Vessels
2386	_____ Carmate Single Axle 2-Door Trailer w/ (1) Ring Compressor Blower, Carbtrol Corp. Approx. 100 Gallon Filtration Vessel

This catalog is a guide. The Auctioneers do not warrant the accuracy, genuineness, authenticity, description, weight, count or measure of any of the lots specified herein.

CATALOG FOR PHOTOCIRCUITS

Lot	Description
2387	1996 Atlas Copco Model VT145 200 hp Air Compressor, s/n AIF035056 w/ (1) Elektronikon Digital Control Panel
2388	1998 MTA Refrigerated Air Dryer Model DE114, 460 Volts, 3-Phase, 60 Hz, R-22 Refrigerant, s/n 1100806501, (1) 1500 Gallon Cap. Air Storage Tank
2389	Ingersoll Rand Model Sierra-H150, 150 HP Rotary Screw Air Compressor, Max. Cap. 696 CFM, Max Rated Operating Pressure, 125 PSI, Total Amps, 200, 460 Volts, 3-Phase, 60 Hz, s/n TS039U9534, MISSING CONTROL PANEL
2390	Hankison Model PR700 Refrigerated Air Dryer, s/n 0366-5-9211-1, 460Volts, 3-Phase, 60 Hz, R22 Refrigerant
2391	Approx. 1500 Gallon Cap. Air Storage Tank
2392	One Lot of (12) Sections of Adjustable Steel Pallet Racking Including (16) Uprights, (44) Cross Beams, Associated Wire Mesh Decking & Applicable Contents
2393	One Lot of (16) Sections of Adjustable Steel Pallet Racking Including (20) Uprights, (64) Cross Beams, Associated Wire Mesh Decking & Applicable Contents (Excluding Any Chemicals)
2394	One Lot of (13) Sections of Adjustable Steel Pallet Racking Including (17) Uprights, (52) Cross Beams, Associated Wire Mesh Decking & Applicable Contents (Excluding Any Chemicals)
2395	One Lot of (13) Eagle Model 1923 24-Gallon Capacity Single Door Flammable Storage Cabinets, (7) Sections of Industrial Racking
2395A	(1) Caldwell Extendable Forklift Jib, Model FB-80, Maximum 8,000 Lb. Capacity
2396	(3) Sections of Adjustable Steel Pallet Racking w/ (4) Uprights, (15) Cross Beams, Associated Metal Decking (Excluding Any Contents)
2397	Ono Sokki Company Model TN-890 Single Side Printer w/ Model TN-117 Image Processor, Please Inspect
2398	Ono Sokki Company Model TN-890 Single Side Printer w/ Model TN-117 Image Processor, Please Inspect
2399	Ono Sokki Company Model TN-890 Single Side Printer w/ Model TN-117 Image Processor, Please Inspect
2400	Ono Sokki Company Model TN-890 Single Side Printer w/ Model TN-117 Image Processor, Please Inspect
2401	(2) Ono Sokki Model TN-890 Single Sided Printers, Please Inspect
2402	One Lot of (2) Amtech Motorized ConveyORIZED Sections, (1) Amtech Incline Receiver Section
2403	One Lot of (4) Camtek Model TV50-HR Inspection AOI Systems
2404	Olec Double Sided Automatic Exposure Printer
2405	One Lot of (2) Spartanics Electro-Optical Registration Punch Presses
2406	Hakuto Mach 600 Cut Sheet Laminator, s/n 78-4 w/ (2) Lohr-Herrmann Conveyor Sections

This catalog is a guide. The Auctioneers do not warrant the accuracy, genuineness, authenticity, description, weight, count or measure of any of the lots specified herein.

CATALOG FOR PHOTOCIRCUITS

Lot	Description
2407	_____ One Lot of (2) PDA 4-Spindle Routers/Bevelers
2408	_____ Western Magnum Substrate Cleaner, Dynachem Hot Roll Pre-Heater Model 800
2409	_____ One Lot of (2) Lohr-Herrmann Vacuum Loaders - Please Inspect
2410	_____ One Lot of (2) Lohr-Herrmann Vacuum Loaders - Please Inspect
2411	_____ Jet Horizontal Continuous Band Saw
2412	_____ Delta Model 10 Deluxe Radio Arm Saw
2413	_____ One Lot of Werner & Louisville Folding & Extension Ladders
2414	_____ (3) Custom Fabricated Heavy Duty Industrial Racks, w/ Numerous Raw Materials Including But Not Limited to: PVC Pipe, Galvanized Roll Stock, Angle Iron, Steel, Aluminum & Wood
2415	_____ Olec Accu-Print Model AP30-6000, 6kw Titan High Resolution Exposure Printer, Please Inspect
2416	_____ Olec Accu-Print Model AP30-6000 6kw Titan High Resolution Exposure Printer, Please Inspect
2417	_____ Les Techniques DE L'Automation Automa-Tech Automatic Exposure Printer
2418	_____ One Lot of (4) 2-Door Metal Storage Cabinets
2419	_____ Pallet Banding Cart w/ Crimping Tool & Industrial Cart
2420	_____ (1) 8-Step Rolling Staircase
2421	_____ One Lot of (2) Dayton Pedestal Based Floor Fans
2422	_____ (30) Sections of Adjustable Steel Pallet Racking Including, (39) Uprights, (116) Cross Beams without Decking
2423	_____ (26) Sections of Adjustable Steel Pallet Racking Including, (35) Uprights, (96) Cross Beams without Decking
2424	_____ One Lot of (11) Industrial Work Benches, Some w/ Butcher Block Tops, Some w/ Formica, Associated Lower Cabinetry & Chairs
2425	_____ Contents of Office Area Including (2) Gateway Pentium Tower Computers w/ CD ROM, 3-1/2 Floppy, Monitors, Keyboards, Mice, (1) Dell Optiplex Model GX110 Tower Computer w/ CD ROM, 3-1/2 Floppy, Monitor, Keyboard, Mouse, (1) Brother IntelliFax Model 770 Fax Machine, (1) HP Model 4050TN Laser Jet Printer, (1) Brother Model ML100 Electric Typewriter, (1) ULine Model 10100 Scale, (4) Desks, (1) Table, (3) Industrial Racks w/ Casters, (3) 4-Drawer Vertical File Cabinets, (1) Rubbermaid Industrial Shelving Unit, (1) 2-Door Metal Storage Cabinet w/ Contents, (1) Metal Desk, (2) Swivel Based Chairs, (1) Computer Work Station
2426	_____ Bramac Lifter Model HL10M 2200 Lb. Capacity Hydraulic Pallet Jack
2427	_____ 3M-Matic Case Sealer w/ STD Taping Head, Type 39600
2428	_____ Easy-Taper Case Sealer, s/n SB230

This catalog is a guide. The Auctioneers do not warrant the accuracy, genuineness, authenticity, description, weight, count or measure of any of the lots specified herein.

CATALOG FOR PHOTOCIRCUITS

Lot	Description
2429	Easy-Taper Case Sealer, s/n SB231
2430	One Lot of (3) Nesta Flex Model 175 Flexible Adjustable Gravity Fed Roller Conveyor Sections, (3) Approx. 24" x 5' Gravity Fed Roller Sections
2431	2000 Eastey Model EM16TK Packaging Machine w/ Shrink Tunnel, Layup Station, s/n 132416TPPIPK
2432	2000 Eastey Model ET1610-36 Shrink Tunnel, s/n 66218TLMB
2433	Conflex Packaging Station w/ Layup Station, Impulse Sealer, Conveyor Section & Control
2434	Intermec Easy Coating Model 4420 Thermal Label Printer w/ Gateway Desk Top Computer, Monitor, Keyboard, Mouse, Tensco Industrial Workbench w/ Lower Cabinet & Overhead
2435	One Lot of (2) Intermec Model 4400 Thermal Label Printers Both w/ Gateway Computer, Monitor, Keyboard, Mouse, Associated Tensco Industrial Workbench w/ Lower Cabinet & Overhead
2436	Intermec Model 4400 Thermal Label Printer
2437	One Lot (3) ULine Model 10100 100 Lb. Cap. Scales, (1) Pelouze Model 4010 150 Lb. Cap. Benchtop Digital Scale
2438	One Lot (7) Workbenches, (1) Industrial Cart, (12) Sections of Adjustable Shelving w/ Dividers
2439	(3) Sections of Adjustable Steel Pallet Racking Including (4) Uprights, (6) Cross Beams without Decking, (3) 6-Step Roll Around Staircases, (1) Dayton Model 4TR19B Wet/Dry Vacuum, (1) Flexible Gravity Fed Roller Conveyor Section
2440	Industrial Power Washer w/ Briggs & Stratton Gas Power Motor
2441	Husky 1800 PSI Power Washer
2442	Sumner Model 715 750 Lb. Cap. Manual Winch Type Walk Behind Die Lift, s/n 715-1695
2443	Rol-Lift 2500 Lb. Cap. Electric Walk Behind Fork Truck
2444	Presto Hydraulic Die Lift Truck
2445	Die Lift Table
2446	Large Quantity of Black Plastic Totes, Numerous Pallets of Corrugated, Pallet of 3M Case Sealer Tape, Numerous Shop Carts, (2) Workbenches, (1) Gateway Pentium Computer w/ CD ROM, 3-1/2 Floppy, Monitor, Keyboard, Mouse
2447	Lohr-Herrmann Vacuum Loader
2448	Bench Type Manual Punch Press w/ Bench
2449	One Lot of (4) Amtech Conveyor Sections, (1) Nesta Flex Model 175 Flexible Gravity Fed Roller Conveyor Section, (1) Lohr-Herrmann Accumulator

This catalog is a guide. The Auctioneers do not warrant the accuracy, genuineness, authenticity, description, weight, count or measure of any of the lots specified herein.

CATALOG FOR PHOTOCIRCUITS

Lot	Description
2450	_____ Bishamon Model BS-55H 5500 Lb. Cap. Pallet Jack
2451	_____ Wesco 2,000 Lb. Cap. Pallet Jack
2452	_____ (8) Sections of Medium Duty Pallet Racking w/ Approx. (5) 12' Uprights, (2) 10' Uprights, (10) 8' Uprights, (59) Crossmembers, Associated Decking
2453	_____ (22) Sections of Light Duty Pallet Racking w/ Approx. (31) Uprights, (180) Crossmembers, Associated Decking
2454	_____ (17) Sections of Medium Duty Pallet Racking w/ Approx. (19) 12' Uprights, (92) Crossmembers, Associated Decking
2455	_____ PW Platforms Approx. 10' Tall 11-Step Roll Around Staircase, (1) 8-Step 6' Tall Roll Around Staircase w/ Storage Platform
2456	_____ Scissor Style Roll Around Battery Load/Unload w/ Scissor Style Cart
2457	_____ (1) Section of Tennco 6-Section Lockers, (14) 4-Drawer Vertical File Cabinets, (2) Metro Stainless Steel Roll Around Carts
2458	_____ (3) Lohr Herrmann Feeders
2459	_____ 1998 IS Model Pumex 2000 Pumice Scrubber, s/n 61063 FOR PARTS
2460	_____ Seria Screen Printer, For Parts
2461	_____ Instron Tensile Strength Tester
2462	_____ (4) Lohr Herrmann Vacuum Loaders
2463	_____ One Lot of (3) Trace Custom Board Testers, (1) Excellon Amtech Incline Receiver, (1) Camtech AOI Parts Machine
2464	_____ Lot of (4) Lohr Herrmann Feeders, (1) Lohr Herrmann Vacuum Loader
2465	_____ (3) Coates ASI Ninety Series 25 Acid Preclean Lines w/ Associated Controls, Motors
2465A	_____ Ishi Hyoki (2) Brush Scrubber Complete With Dryer and Control Panels
2466	_____ One Lot of (2) Intertape Model USA 2024-4 Case Sealers
2467	_____ One Lot of (2) Camtek 2V50 AOI Systems
2468	_____ Lohr Herrmann Feeder
2468A	_____ Lohr Herrmann Feeder In Crate
2469	_____ PDA 3-Spindle Router/Beveler, s/n PDA 501150 w/ Turbo Cam Control

This catalog is a guide. The Auctioneers do not warrant the accuracy, genuineness, authenticity, description, weight, count or measure of any of the lots specified herein.

CATALOG FOR PHOTOCIRCUITS

Lot	Description
2469A	Lot of (2) Cooling Water Circulators, (2) Orion Silent Dry Pump Boxes, (2) Board Feed Conveyors, IS Dryer 2000/A, s/n 46480, 1999, S.Steel Housing Only, 4-Part, (3) Cedal Loading Station Complete w/ (3) Scissor Lifts
2470	Lot of (4) Sections of Medium Duty Pallet Racking w/ (6) 8' Uprights, (16) Crossmembers, Associated Contents Including: (5) Ring Blowers, Misc. Fittings, Dayton Industrial Fan, Other Metals Materials
2471	Trane Voyager Model YCH060C3LBBF
2472	Large Qty of Corrugated Boxes, Various Sizes, Please Inspect
2473	Lot of (2) Stanley Bostitch Model FC95EC Box Staplers
2474	Lot of Misc. Steel Shelving in Pieces
2475	Crown 5,000 Lab. Cap. Pallet Jack
2476	Werner Model 6212 12' Folding Fiberglass Ladder, 300 Lb. Cap.
2477	Wesco 5,000 Lb. Cap. Pallet Jack
2478	Wesco 2,000 Lb. Cap. Pallet Jack
2479	Packall Model L Sealer, Complete w/ Shrink Tunnel and 6' Long Gravity Fed Conveyor
2480	(2) Trace Bare Board Testers, (1) Lohr Herrmann Vacuum Loader
2481	(8) Trace Bare Board Testers, (1) ECT OZ Automated Repair Center, Model 200V Power Probe II
2482	(6) Epsco Model PS-1000-55 Filtered DC Power Supplies, (1) 3-Tier SS Roll Around Metro Cart
2483	Remaining Contents of Room Including: (2) 5-Tier Metal Shelving Units and Contents Including Heat Plate, Acopian Regulated Power Supplies, Cables, Teknek Adhesive Rolls, 60" x 30" 7-Drawer Desk, Skid of Totes, (2) Modular Workbenches w/ Overhead Lighting, 5-Tier Hon Bookcase, (3) Hypot Testers
2484	Gillette Century Probe Complete w/ (1) Power Solutions Inc. Model 5.7, s/n 5.7L-7629, 5.7 Liter Natural Gas Generator w/ Gillette Sentinel III Digital Readout, (1) Eaton-Cutler Hammer Transfer Switch, Model APC-400
2499	SALE CONTINUES WITH ROLLING STOCK & VEHICLES (LOTS 2500 - 2540)
2499B	Wildcat Model Snorkel SL20 Scissor Lift
2500	E-Z-Go Electric Golf Cart w/ Charger, (2) Bench w/ Canvas Enclosure (Late Delivery - August 31st or Earlier)
2501	E-Z-Go Electric Golf Cart, Single Bench w/ Tool Bin (Late Delivery - August 31st or Earlier)
2502	E-Z-Go Electric Golf Cart, Single Bench w/ Tool Bin (Late Delivery - August 31st or Earlier)
2503	E-Z-Go Electric Golf Cart, Single Bench w/ Tool Bin
2504	E-Z-Go Electric Golf Cart, Single Bench w/ Tool Bin (Late Delivery - August 31st or Earlier)
2505	E-Z-Go Electric Golf Cart, Single Bench w/ Tool Bin (Late Delivery - August 31st or Earlier)

This catalog is a guide. The Auctioneers do not warrant the accuracy, genuineness, authenticity, description, weight, count or measure of any of the lots specified herein.

CATALOG FOR PHOTOCIRCUITS

Lot	Description
2506	_____ E-Z-Go Electric Golf Cart, Single Bench w/ Tool Bin (Late Delivery - August 31st or Earlier)
2507	_____ E-Z-Go Electric Golf Cart, Single Bench w/ Back Rack (In Need of Repair)
2508	_____ E-Z-Go Electric Golf Cart, Single Bench w/ Back Rack (In Need of Repair)
2509	_____ E-Z-Go Electric Golf Cart, Single Bench w/ Back Rack (In Need of Repair)
2510	_____ E-Z-Go Electric Golf Cart, Single Bench w/ Back Rack (In Need of Repair)
2511	_____ E-Z-Go Electric Golf Cart, Single Bench w/ Back Rack (In Need of Repair)
2512	_____ 1996 GMC 1500 Van, Red in Color, VIN #1GTFG15W5T1035365, Automatic Transmission, Mileage 72,846
2512A	_____ 2003 Chevrolet Silverado Z-71 4x4 Extended Cab, 29,000 Miles, Cloth Interior, Automatic, Bed Liner, A/C, Power Windows
2513	_____ 1996 Chrysler Plymouth Voyager Passenger Van, Light Blue In Color, VIN #2P4SP253XTR658449, Mileage 63,096, Automatic Transmission
2514	_____ 1998 Ford Explorer, Blue In Color, VIN #1FMZU34E9WUD44331, Automatic Transmission, Mileage 93,653
2515	_____ 1996 Pontiac Trans Sport SE Passenger Van, Blue in Color, Automatic Transmission, VIN #1GMDU06E6TT210514, Mileage 145,778
2516	_____ 1982 Chevy 3500 Cheyenne 6-Wheel Mason Dump w/ Meyer Plow, Fuel Reservoir w/ 15-Gallon Per Minute, 12 Volt DC Pump, VIN #3JV34W6KF33731, Automatic Transmission, Mileage 24,170 (Truck in Need of Repair)
2517	_____ 1998 Ford Windstar 3.0 Liter, Currently Not Drivable (In Need of Repair)
2518	_____ 1987 Chevy 4-Wheel Drive Pick Up Truck, Custom Deluxe 20, w/ Meyer Plow, Automatic Transmission, Mileage 73,630
2519	_____ 1990 Chevy 3500 4-Sheel Drive Pick Up Truck, VIN #1GCGK34N8LE168847, Automatic Transmission, Mileage 118,263 w/ Plow Frame (In Need of Repair)
2520	_____ One Lot of (3) Snow Plows
2521	_____ 1994 Plymouth Voyager Passenger Van, VIN #2P4GH45R6RR804422, Automatic Transmission, Green in Color, Mileage 107,424 (In Need of Repair)
2522	_____ Yale Model ERRS30TFN36SE078, 36 Volt Electric 3-Wheel Fork Truck, Tripe Stage Mast, 3000 Lb. Cap. w/ Side Shift
2523	_____ Yale Model GLP050TC--084 LPG Triple Stage Mast Fork Lift, 5000 Lb. Cap., s/n E177B20596, (Late Delivery August 31st or Earlier)

This catalog is a guide. The Auctioneers do not warrant the accuracy, genuineness, authenticity, description, weight, count or measure of any of the lots specified herein.

CATALOG FOR PHOTOCIRCUITS

Lot	Description
2524	_____ Yale Model GLP030A21UAE084 LPG Triple Stage Mast Fork Lift, 3000 Lb. Cap. Pneumatic Tires (Late Delivery August 31st or Earlier)
2525	_____ Yale Model GLP080LFNSBE088, 8000 Lb. Cap. Fork Lift, Triple Stage Mast, s/n D870418, LPG w/ Pneumatic Tires (Late Delivery August 31st or Earlier)
2526	_____ Raymond Model DSS350 36 Volt Electric Standup Fork Truck, s/n DSS-03-05604, 3500 Lb. Cap.
2527	_____ Genie Model GS-2032 Sky Jack, (Late Delivery August 31st or Earlier)
2528	_____ Raymond Model 20I-R30TT, 2000 Lb. Cap. 24 Volt Electric Upright Reach Fork Truck, s/n 020D-93-34612
2529	_____ Raymond Model EASI-R35TT, 3500 Lb. Cap. 24 Volt Electric Upright Reach Fork Truck, s/n ES-C-98-06413
2530	_____ Raymond Model DSS 350TT, 36 volt Electric Upright Forklift, 3500 Lb. Cap., s/n S350-00600-96
2531	_____ Raymond Electric Walk Behind Pallet Truck
2532	_____ Industrial Energy 24 Volt Battery Charger
2533	_____ Hertner 36 Volt Battery Charger
2534	_____ Hobart Battery-Mate 36 Volt Battery Charger
2535	_____ Big Joe Model PBI-20-A6 2000 Lb. Capacity, 24 Volt Electric Walk Behind Die Lift/Pallet Truck, s/n 358143
2536	_____ Clark Model CGC25 4500 Lb. Cap. LPG Fork Truck, s/n C365L-0720-9393FB, w/ Side Shift, Triple Stage Mast, Missing LPG Tank
2537	_____ Clark Model GPS20MB 3500 Lb. Cap. LPG Fork Lift, s/n GP138MB-0059-6645FA, Triple Stage Mast, w/ Pneumatic Tires, Missing LPG Tank
2538	_____ Hyster Model 40 4000 Lb. Capacity LPG Fork Truck, Triple Stage Mast, Pneumatic Tires, (Missing LPG Tank in Need of Brakes)
2539	_____ Yale Model GLP050TFNUAE084 5000 Lb. Cap. LPG Fork Lift, Triple Stage Mast, Pneumatic Tires, w/ Side Shift, (Missing LPG Tank)
2540	_____ Clark Model C500-YS60 3800 Lb. Cap. LPG Fork Lift, s/n Y355-691-4321, (In Need of Repair)
2849	_____ SALE CONTINUES WITH BUILDING 45A TOOL ROOM (LOTS 2850-2997)
2850	_____ Makita 14" Abrasive Cut Off Saw w/ Bench
2851	_____ Bridgeport Series 1 2-HP Vertical Milling Machine, s/n BR279714, 9" x 42" Power Feed Table, Acu-Rite 2-Axis Digital Read Out, 1-Shot Lubrication Power Knee
2852	_____ Bridgeport Series 1 2-HP Vertical Milling Machine, s/n 248422, 9" x 42" Power Feed Table, Sony 2-Axis Digital Read Out, 1-Shot Lubrication

This catalog is a guide. The Auctioneers do not warrant the accuracy, genuineness, authenticity, description, weight, count or measure of any of the lots specified herein.

CATALOG FOR PHOTOCIRCUITS

Lot	Description
2853	Bridgeport Series J Travadial, 2-HP Vertical Milling Machine, s/n 178988, 9" x 42" Power Feed Table, Acu-Rite 2-Axis Digital Read Out, 1-Shot Lubrication
2854	Jet 3-HP Vertical Milling Machine Model JTM-1054, s/n 408020, Newall DP7 2-Axis Digital Read Out, 70-4200 RPM Spindle Speeds, Power Feed Table & Power Knee, 1-Shot Lubrication
2855	Bridgeport Series 2 4-HP Vertical Milling Machine, s/n 902, 50-3500 RPM Spindle Speeds, Mitutoyo 2-Axis Digital Read Out, Power Feed Table & Knee
2856	VSR2 Vertical Milling Machine, Lam Morey Maximum 3360 RPM Spindle Speeds
2857	Kempsmith Master-Mill Horizontal Milling Machine Model KMB12806, #2 Plain, 25-1500 RPM Spindle Speeds w/ Cabinet of Associated Tooling & Arbors
2858	Grob Model 4V-36, 36" Vertical Metal Cutting Band Saw, s/n 1146, w/ 36" Throat, Grinding & Butt Weld Attachment & Spare Band Saw Blades
2859	Hardinge Model HLB-H High Speed Precision Tool Room Lathe, s/n HLBH13481T, 125-3000 RPM Spindle Speeds
2860	Hardinge Model HLV-H High Speed Precision Tool Room Lathe, s/n HLVH-46910-P
2861	Clausing Colchester 15" Tool Room Lathe, s/n 6/0055/35971DD, 25-2000 RPM Spindle Speeds, 3-Jaw Chuck w/ Threading, Induction Hardened Bed Ways
2862	Strand Model MP.54 Pedestal Drill Press
2863	Clausing Triple Head Production Heavy Duty Drill Press Model 1666, 3-Heads, s/n 51699594, 93
2864	Peerless Valuematic Horizontal Metal Cutting Band Saw Model 1100, s/n 66-805, 12" Throat
2865	Rockwell Model 31-550 Vertical 6" Continuous Belt Sander
2866	Rockwell Model 31-550 Vertical 6" Continuous Belt Sander
2867	Dayton Model 2Z341J Double End Pedestal Grinder
2868	Hammond Carbide Tool Grinder
2869	K.P. Huppert Tool Room Furnace Model 11BMPC, s/n 652, w/ Digital Temperature Controller
2870	McDonough Manufacturing Company Tool & Cutter Grinder
2871	Harig Model 618 Precision Hand Feed Surface Grinder, 6" x 18" Magnetic Chuck, s/n 6648
2872	One Lot of Assorted Grinding Wheels
2873	(2) Friedrich Wall Unit Air Conditioners
2874	(2) Cabinets w/ Contents of Assorted Tooling, 12" x 18" Granite Surface Plate & Challenge Precision Knee
2875	Thermal Dynamics Cut Master Model 80XL Air Plasma Cutter

This catalog is a guide. The Auctioneers do not warrant the accuracy, genuineness, authenticity, description, weight, count or measure of any of the lots specified herein.

CATALOG FOR PHOTOCIRCUITS

Lot	Description
2876	_____ Miller Syncrowave 300 AC/DC Gas Tungsten-Arc or Shielded Metal Arc Welder, s/n HK331484
2877	_____ Lincoln Model Idealarc Model SP-250 Constant Voltage DC Arc Welder
2878	_____ One Lot of Assorted Welding Supplies, Masks, Cabinets & Welding Rod
2879	_____ (2) Steel Precision Layout Tables
2880	_____ (1) Steel Welding Table w/ Curtain & Hood
2881	_____ (1) Acetylene Touch Cart w/ Gauges & Hoses
2882	_____ (1) Work Bench w/ Vise & Table w/ Vise
2883	_____ Craftsman Jig Saw, Hitachi Disc Grinder, Master Mechanic Drill, Black and Decker 1/2" Drill
2884	_____ One Lot of Assorted Welding Wire
2885	_____ One Lot of Regulators & Flow Meters
2886	_____ Winner 4-Ton Capacity Body/Frame Repair Kit
2887	_____ One Lot of Assorted C-Clamps
2888	_____ One Lot of Assorted Vise Grip Clamps
2889	_____ One Lot of Assorted Bar Clamps
2890	_____ (2) Pneumatic Sander & Hand Grinder
2891	_____ (2) Pneumatic Rivet Guns & Disc Grinder
2892	_____ (2) Pneumatic Power Tools
2893	_____ (1) National Model U4812 4' Manual Curtain Apron Bending Break, 12 Gauge Capacity, s/n 771-995
2894	_____ Famco Model 1472 5' Power Squaring Shear, s/n S-04833954, 14 Gauge Mild Steel Capacity w/ Adjustable Back Gauge
2895	_____ (1) Diacro Corner Notcher
2896	_____ (1) J.F. Helmold & Brothers Incorporated Cutting & Creasing Rule, Butcher Block Work Bench w/ Vise
2897	_____ (1) Wilton Bench Vise
2898	_____ (1) 24" Manual Bench Model Finger Bending Break
2899	_____ (1) Roper Whitney Punch LS Starrett Bench Vise & Butcher Block Work Bench
2900	_____ (1) Heinrich Hand Nibbler Shear #4
2901	_____ (1) J.F. Helmold Cutting & Creasing Rule w/ Bench
2902	_____ (1) MSC 1" x 42" Continuous Vertical Belt Sander
2903	_____ Greenard #3 Arbor Press
2904	_____ (1) Anderson 12-Ton Hydraulic C-Frame Punch w/ Enterpac Power Unit

This catalog is a guide. The Auctioneers do not warrant the accuracy, genuineness, authenticity, description, weight, count or measure of any of the lots specified herein.

CATALOG FOR PHOTOCIRCUITS

Lot	Description
2905	_____ (1) Milling Vise Swivel Base
2906	_____ (1) Bridgeport Milling Machine Vise
2907	_____ (1) Bridgeport Milling Machine Vise
2908	_____ (1) Bridgeport Milling Machine Vise
2909	_____ Kurt Milling Machine Vise
2910	_____ Kurt Milling Machine Vise
2911	_____ Kurt Milling Machine Vise
2912	_____ Kurt Milling Machine Vise
2913	_____ (1) Swivel Based Milling Machine Vise
2914	_____ (1) Milling Machine Vise
2915	_____ Universal Milling Machine Vise
2916	_____ (1) Milling Machine Vise
2917	_____ (2) Adjustable Milling Vises
2918	_____ (2) Milling Machine Vises
2919	_____ (1) 6" Rotary Table
2920	_____ (1) Tool Importers Dividing Head
2921	_____ (2) Bridgeport Quills
2922	_____ Bridgeport Right Angle Milling Head
2923	_____ (1) 5C Collet Holder Speed Chuck
2924	_____ (1) 5C Collet Closer & Indexer
2925	_____ (1) Versa Tapper Tapping Head
2926	_____ (2) Tapping Heads
2927	_____ One Lot of Assorted Hold Down & Strapping Tools
2928	_____ (5) Assorted Milling Machine Strapping Tool Sets
2929	_____ One Lot of Assorted Flex Collets
2930	_____ One Lot of Assorted R8 Collets
2931	_____ One Lot of Assorted Chucks w/ R8 Collets
2932	_____ One Lot of Assorted Morse Taper Chucks
2933	_____ One Lot of R8 Tool Holders
2934	_____ One Lot of Assorted Tool Holders

This catalog is a guide. The Auctioneers do not warrant the accuracy, genuineness, authenticity, description, weight, count or measure of any of the lots specified herein.

CATALOG FOR PHOTOCIRCUITS

Lot	Description
2935	_____ One Lot of Assorted Tool Holders
2936	_____ (1) R8 Spindle Off Set Boring Head
2937	_____ (1) Bridgeport Off Set Boring Head
2938	_____ One Lot of Assorted Aloris Tool Post Holders
2939	_____ (2) Small 3-Jaw Chucks
2940	_____ (2) Small 3-Jaw Chucks
2941	_____ (1) Small 4-Jaw Chuck & Face Plate
2942	_____ (1) Steady Rest
2943	_____ One Lot of Hardinge 5C Collets
2944	_____ One Lot of Hardinge 5C Collets
2945	_____ One Lot of 5C Flex Collets
2946	_____ One Lot of Nerling Tools & Centers
2947	_____ (1) 3-Jaw Chuck
2948	_____ Buck 4-Jaw Chuck
2949	_____ Aloris Tool Post Holder
2950	_____ One Lot of Assorted Tool Holders & Nerling Tools
2951	_____ One Lot of Assorted Cutting Tools
2952	_____ One Lot of Large Capacity & Assorted Size Drills
2953	_____ (1) End Mill Sharpening Fixture
2954	_____ One Lot of Assorted Reamers
2955	_____ (2) Threading Attachments
2956	_____ (3) Tubs of Assorted Horizontal Milling Cutters
2957	_____ One Lot of Threading Heads
2958	_____ One Lot of Threading Dies
2959	_____ (1) Little Giant Tap & Die Set
2960	_____ (1) Hassay-Savage Keyway & Groach Cutter Set
2961	_____ (1) Tool Makers Scope
2962	_____ One Lot of Assorted Micrometers
2963	_____ (5) Butcher Block Benches & Formica Top Work Bench
2964	_____ (1) 2-Door Cabinet w/ Contents of Assorted Tooling

This catalog is a guide. The Auctioneers do not warrant the accuracy, genuineness, authenticity, description, weight, count or measure of any of the lots specified herein.

CATALOG FOR PHOTOCIRCUITS

Lot	Description
2965	_____ (1) 2-Door Cabinet w/ Contents of Assorted Tooling
2966	_____ (1) Manual Bench Top Shear
2967	_____ Starrett 26" Height Gauge & Etalon 22" Height Gauge
2968	_____ Starrett Model 1175 Snap Gauge w/ Simonds Gauge
2969	_____ (1) Manex Set
2970	_____ Starrett Precision Level
2971	_____ One Lot of Precision Drills
2972	_____ (1) Kennedy Tool Chest w/ Contents & Butcher Block Top
2973	_____ One Lot of Assorted Drills w/ Cabinet
2974	_____ (1) Kennedy Tool Chest w/ Contents of Assorted Drills
2975	_____ (2) 2-Door Storage Cabinets w/ Contents
2976	_____ (1) Gateway Pentium Computer w/ Monitor, Keyboard, H-P Desk Jet Printer & H-P Scan Jet Scanner, Desk & Shelf
2977	_____ (1) Refrigerator, (2) Microwaves, Cabinet, Toaster & Water Cooler
2978	_____ Butterfly Model D Die Filer
2979	_____ (1) 24" x 36" Granite Surface Plate
2980	_____ One Lot of Assorted Work Benches
2981	_____ (2) 2-Door Metal Storage Cabinets w/ Contents of Assorted Tooling
2982	_____ (1) Ridgid Table Saw
2983	_____ One Lot of Assorted Square Stock Round Stock Both Steel & Aluminum w/ Racks & Cantilever Racks
2984	_____ (1) Cantilever Raw Material Rack w/ Assorted Round Stock Material
2985	_____ (1) 2-Door Metal Storage Cabinet w/ Contents
2986	_____ (1) 2-Door Metal Storage Cabinet w/ Contents
2987	_____ (1) 2-Door Metal Storage Cabinet w/ Contents
2988	_____ (1) 2-Door Metal Storage Cabinet w/ Contents
2989	_____ (1) 2-Door Metal Storage Cabinet w/ Contents
2990	_____ (1) 2-Door Metal Storage Cabinet w/ Contents
2991	_____ (1) 2-Door Metal Storage Cabinet w/ Contents
2992	_____ (2) 2-Door Metal Storage Cabinet w/ Contents

This catalog is a guide. The Auctioneers do not warrant the accuracy, genuineness, authenticity, description, weight, count or measure of any of the lots specified herein.

CATALOG FOR PHOTOCIRCUITS

Lot	Description
2993	One Lot of Assorted Raw Material Including Copper, Brass, Steel, Flat Stock, Round Stock, Square Stock, Angle Iron & Plastic w/ Heavy Duty Storage Rack
2994	One Lot of Assorted Raw Material Including Plastic, Polypropylene, Tool Steel, Round Stock & Aluminum
2995	(2) Heavy Duty Tooling Cabinets w/ Contents of Assorted Reamers & Drills, (9) Fastener Cabinets w/ Contents of Assorted Fasteners
2996	(4) 2-Door Storage Cabinets w/ Contents of Assorted Fasteners & Tooling
2997	One Lot of Assorted Raw Material Including Sheet Stock, Square Stock, Aluminum, Steel & Plastic
3399	SALE CONTINUES IN BUILDING 45A SUPPLIES CRIB (LOTS 3400 - 3432)
3400	(1) Crown RC3000 Series 3200 Lb. Capacity, 36 Volt Stand Up Forklift Model RC3020-35, s/n 1A202936, w/ Crown CA Sideshifter Model 55F-SS-A062 w/ (1) Yuasa 36 Volt Battery Charger Model SGW-18-775, w/ Model 7000 Plus Digital Control Panel
3401	(1) Crown RR5000 Series, Model RR5010-35, 3500 Lb. Capacity 36 Volt Electric Standup Forklift, s/n 1A207418 w/ 3-Tier Mast & Sideshift, (1) Hertner Power Pack Battery Charger
3402	Raymond 24 Volt Walk Behind Electric Pallet Jack, 5000 Lb. Capacity, w/ Deka Battery
3403	Yale Model MPB070ACN24C1848 24 Volt, 4000 Lb. Capacity Electric Walk Behind Pallet Jack, s/n A827N16602V w/ Battery Pack
3404	(1) LTD Products 24 Volt Battery Charger
3405	Bishamon 5500 Lb. Capacity Pallet Jack
3406	Wesco 27" x 48" 5000 Lb. Capacity Pallet Jack
3407	(1) 5000 Lb. Capacity Pallet Jack
3408	(1) 5000 Lb. Capacity Pallet Jack
3409	(1) Liftrite 5000 Lb. Capacity Pallet Jack
3410	(1) Garlin 8-Step 6' Roll Around Staircase, (1) P.W. Platforms 6-Step 5' Roll Around Aluminum Staircase, (1) 4-Step 3' Roll Around Staircase
3411	Contents of Shipping Area Including But Not Limited to: (1) Approx. 10' x 30" Wide Butcher Block Style Workbench, (2) 60" x 30" Desk, (2) 8' x 30" Butcher Block Top Workbench w/ Lower Shelving, (1) 5-Drawer Lateral File Cabinet, (1) 4-Drawer Vertical File Cabinet, (1) 4-Shelf Steel Bookcase, (1) Gateway Model GP6-350 Pentium II 350 MHz PC w/ CD ROM, 3-1/2 Floppy, Keyboard, Mouse, (1) Gateway 2000 Model EV700 17" Monitor, (1) Canon Pixma Model MP103 Color Ink Jet Printer, (1) AirKing 24" High Velocity Industrial Fan

This catalog is a guide. The Auctioneers do not warrant the accuracy, genuineness, authenticity, description, weight, count or measure of any of the lots specified herein.

CATALOG FOR PHOTOCIRCUITS

Lot	Description
3412	_____ (9) Sections of Pallet Racking
3413	_____ (10) Sections of Pallet Racking
3414	_____ (14) Sections of Pallet Racking
3415	_____ (14) Sections of Pallet Racking
3416	_____ (14) Sections of Pallet Racking
3417	_____ (18) Sections of Pallet Racking
3418	_____ (14) Stainless Steel Wire Shelves w/ Tubs
3419	_____ One Lot of Metal Shelving w/ Contents of Assorted Office Supplies & Cafeteria Supplies Including Cups, Plastic Utensils
3420	_____ Kennedy Tool Storage Cabinet w/ Contents of Assorted Drill Bits, (4) 2-Door Metal Storage Cabinets w/ Contents, Locker Unit, Security Cage & Metro Shelf Unit, Refrigerator & Microwave
3421	_____ Tensco 2-Door Metal Storage Cabinet w/ Contents of Assorted Gold Bare Board Testing Pins
3422	_____ (7) Tensco 2-Door Metal Storage Cabinets w/ Contents of Assorted Toner Supplies
3423	_____ (9) 2-Door Metal Storage Cabinets w/ Contents of Various Office Supplies
3424	_____ Flammable 2-Door Metal Storage Cabinet w/ Contents of Aerosol Lubricant
3425	_____ (2) Skids of Magtak Adhesive Substrate Inline Tacky Roller Replacements for Western Magnums
3426	_____ Contents of Pallet Racking of Assorted Consumables Including But Not Limited to: Lexan Slip Sheet Paper, Cardboard Cornering
3427	_____ Contents of Pallet Racking of Assorted Consumables Including But Not Limited to: Various Office Paper, Roll Paper, Slip Sheets, 45-Gallon Plastic Bags
3428	_____ Contents of Pallet Racking of Various Consumables Including But Not Limited to: Soap, Stripper, Napkins, Supplies
3429	_____ Contents of Pallet Racking of Various Consumables Including But Not Limited to: Filters, Office Supplies
3430	_____ Contents of Pallet Racking of Various Consumable Including But Not Limited to: Filter Bags, Shoe Covers, Tyvek Suits
3431	_____ Contents of Pallet Racking of Various Consumable Including But Not Limited to: Envelopes, Safety Glasses, Masks, 3M Safety Masks
3432	_____ (2) Skids of Kyocerz PCB Drill Bits
3449	_____ SALE CONTINUES IN STORAGE AREA OUTSIDE OF BUILDING 2 (LOTS 3450 - 3467)
3450	_____ (1) Cassone Stainless Steel Refrigerated Storage Trailer Located Outside of Waste Treatment

This catalog is a guide. The Auctioneers do not warrant the accuracy, genuineness, authenticity, description, weight, count or measure of any of the lots specified herein.

CATALOG FOR PHOTOCIRCUITS

Lot	Description
3451	One Lot of Emergency Response Equipment Including But Not Limited To: (5) Scot Air Packs w/ Extra Oxygen Cylinders, (3) Eye Wash Stations, Gloves, Sleeve Protectors, Face Shields, Mercury Kits, Pneumatic Vacuum Heads, Hazmat Suits, Shovels, Brooms, (2) Polypropylene Poly Over Pack Salvage Drums, (1) Wilden Diaphragm Pump w/ Stainless Steel Roll About Cart
3452	Raymond Model EASI R40TT, s/n ES-C-98-06844, 4,000 Lb Capacity Riding Forklift w/ Fork Extenders & Side Shaft, Double Staged Mast
3453	(2) Sections of Heavy Duty Pallet Racking Consisting of (3) Uprights, (10) Cross Members w/ Contents Including: Assorted Electric Machinery, Electric Motors, Sulfuric Acid Tank w/ GF Signet LED Read Out Controller
3454	(7) Sections of Heavy Duty Pallet Racking Consisting of (8) Uprights, (42) Cross Members Approximately 15' High w/ Kjeltech System Model 1026 Distilling Unit & (3) Water Metering Units
3455	(6) Sections of Heavy Duty Pallet Racking Consisting of (7) Uprights, (36) Cross Members
3456	Contents of Office Including: (1) Gateway 2000 Tower Computer w/ Gateway Model EV700 Color Monitor, Keyboard & Mouse, (1) Office Desk, (1) H-P Desk Jet 695C Color Ink Jet Printer, (1) H-P Fax Model 900 Plain Paper Fax, (1) Aluminum Cafeteria Style Bench, (1) Set of Employee Lockers
3457	One Set of (3) Double Tiered Employee Lockers, Contents of (2) Offices Including But Not Limited To: (1) Dell OptiPlex Model GX1 Pentium 3 Computer w/ Gateway Model VX700 Color Monitor, Keyboard & Mouse, (1) HP Desk Jet Model 694C Color Ink Jet Printer, (1) Metal & Wood Office Desk, (1) Wood Office Table, (2) 4-Drawer Vertical File Cabinets, (3) Office Chairs, (1) Gateway 2000 Computer w/ CD-ROM, 3.5 Floppy (1) HP Desk Jet 697C Color Ink Jet Printer, (1) NEC Model Multisync Model E700 15" Color Monitor, Keyboard & Mouse, (1) Brother & Intellifax Model 1270 Plain Paper Fax, (1) 4-Drawer Vertical File Cabinet, (1) Office Desk, (1) Metal & Wood 6-Drawer Office Desk, (3) Upholstered Swivel Chairs
3458	(1) 10" Table Saw Model 315.228410, s/n P9284 3292, w/ Align A Rip 24/24 Fence, (1) Dewalt 3-HP Radial Arm Saw 12" Dia. Blade
3459	(2) Kennedy Multi-Drawer Mechanics Roll Around Tool Carts
3460	(1) 6" Double Ended Bench Grinder Model 090912162, 0.33-HP, (1) Single Ended Table Top Grinder w/ Baldor Motor
3461	Balance of Contents In Room Including But Not Limited To: Assorted Small Parts, Bins, Associated Electrical Wire, (2) Heavy Duty Work Benches, Hanging 2-Door Sliding Cabinet w/ Contents, (1) Aluminum Hand Truck, (1) Wilton 6" Heavy Duty Bench Vise, (1) #1 Arbor Press, (1) Werner Fiber Glass 6' Step Ladder

This catalog is a guide. The Auctioneers do not warrant the accuracy, genuineness, authenticity, description, weight, count or measure of any of the lots specified herein.

CATALOG FOR PHOTOCIRCUITS

Lot	Description
3462	(1) Jet 1-Ton Arbor Press Model MAP1, (1) Werner Fiber Glass 6' Folding Step Ladder, (1) Magliner Magnesium & Aluminum Hand Truck, (1) Butcher Block Work Bench w/ Record 3" Vise
3463	(1) 20,000 Gallon #2 Fuel Oil Storage Tank
3464	(1) 8,000 Gallon Ammonia Storage Tank
3466	(1) Hydraulic Pallet Jack
3467	(1) Wesco 5,000 Lb. Hydraulic Pallet Jack
3499	SALE CONTINUES IN BUILDING 45A TOWER OFFICES & BUSINESS MACHINES (LOTS 3500 - 3683)
3500	One Large Lot Of Office Cubicles And Contents Including But Not Limited To: Assorted Size Desks, Chairs, 4-Drawer Vertical Filing Cabinets, 2-Drawer Vertical Filing Cabinets, Steel Bookcases, 2-Drawer Lateral Filing Cabinets, and Associated Partitioning
3501	Contents of Hallway Including But Not Limited To: (13) 4-Drawer Vertical Filing Cabinets, (1) Section of Partitioning, (1) 2-Door 2-Shelf Roll Around Cart, (1) Chefmate Toaster, (1) Water Cooler
3502	Furniture Contents of Document File Room Including But Not Limited To: (3) 2-Door Metal Storage Cabinets, (2) Right 5-Tier Hanging File Cabinets, (1) Inmac 4-Tier Hanging File Cabinet, (1) Shredex Model 2100 Cross Cut Shredder, (5) Sections of 3-Tier Metal Shelving, Quantity of 4-Tier Wood Shelving
3503	(1) Tri-Arc 6-Step 5' Roll Around Staircase, (3) 2-Tier Stainless Steel Roll Around Metro Carts, (2) 3-Tier Stainless Steel Roll Around Metro Carts
3504	(1) Formax AutoSeal Auto Folder/Sealer Model FD-2050, s/n 981000496 (Note: Late Delivery, Removal Date TBD)
3504A	(1) Hewlett-Packard Laser Jet 8100N Laser Printer Complete w/ (2) Paper Trays & (1) Hewlett-Packard Laser Jet 8000N Laser Jet Printer Complete w/ (2) Paper Trays (Note: Late Delivery, Removal Date TBD)
3504B	(1) Hewlett-Packard Laser Jet 5N Laser Printer Complete w/ Third Load Tray (Note: Late Delivery, Removal Date TBD)

This catalog is a guide. The Auctioneers do not warrant the accuracy, genuineness, authenticity, description, weight, count or measure of any of the lots specified herein.

CATALOG FOR PHOTOCIRCUITS

Lot	Description
3504C	Remaining Contents of Payroll Office Including But Not Limited To: (1) Modular Work Station Complete w/ Left & Right Return & Associated Upper & Lower Cabinetry, (1) 4-Drawer Vertical File Cabinet, (1) 2-Drawer Lateral File Cabinet, (1) 16" x 32" 7-Drawer Steel Case Desk, (1) 60" x 30" 5-Drawer Steel Case Desk, (1) 48" x 24" Table, (1) 3-Shelf Bookcase, (1) Dorm Style Refrigerator, (1) 72" x 30" Work Bench w/ Lower Shelf, (2) Right Line Hanging File Folder Storage Cabinets, (1) 2-Door Metal Storage Cabinet, (2) Pneumatically Adjustable Swivel Based Chairs, (1) Swivel Based Chair, (1) Dell OptiPlex 270 Model DHM Pentium 4 Computer Complete w/ CD-ROM, 3.5 Floppy, Keyboard, Mouse & Dell 17" Monitor (Late Delivery, Removal Date TBD)
3506	(1) Brother & Intellifax Model 2750 Plain Paper Laser Fax Machine
3507	Remaining Contents of Room Including But Not Limited To: (1) Gateway 2000 Pentium Computer Complete w/ CD-ROM, 3.5 Floppy, Keyboard, Mouse, Dell 15" Monitor & Hand Held Scanner, (1) 4-Drawer Lateral Filing Cabinet, (1) 3-Drawer Lateral Filing Cabinet, (3) 4-Drawer Vertical Filing Cabinet, (1) 3-Drawer Roll Around Storage Cart
3508	Remaining Contents of Supplies Cabinet Including But Not Limited To: Kyocera Meta Toner, Envelopes, Binders, Inter-Office Envelopes, Adding Machine, High Lighters, Stamps, Ink, Binder Clips, 3-Hole Punch, Space Heater & Other Miscellaneous Assorted Office Supplies, (1) 2-Door Combination Safe, (1) Sentry Safe, (1) 2-Tier Stainless Steel Metro Cart
3509	Remaining Contents of Reception Area Including But Not Limited To: (1) Modular Work Station Complete w/ Left & Right Returns, (1) 2-Drawer Stainless Steel Lateral File Cabinet, (1) 2-Drawer Wooden Lateral File Cabinet, (1) 2-Drawer Roll Around Cart, (1) Pneumatic Adjustable Swivel Based Chair, (1) Reception Table Complete w/ (2) Seats, (1) Coat Rack, (1) Plant, (1) Picture
3510	(1) Dell OptiPlex Model GX270 Pentium 4 Computer Model DHM, s/n 6Z1NN31, Date of Manufacturer 10/20/03, Complete w/ CD-ROM, 3.5 Floppy, Keyboard, Mouse, (1) Dell 15" Monitor
3511	(1) Hewlett-Packard Laser Jet 4000N Laser Printer
3512	(1) Pioneer Stereo Receiver Model SX-780, AM/FM Receiver/Amplifier Complete w/ (2) Bose Speakers Complete w/ Direct Energy Controllers & (2) Pioneer Speaker Boxes
3513	(2) Hewlett-Packard Laser Jet 5N Laser Printers, (1) Netgear 54Mbps Wireless Router Model WGR614v6 & (2) 3 Comm Super Stack II Dual Speed 12-Port Hubs Model 3C16610

This catalog is a guide. The Auctioneers do not warrant the accuracy, genuineness, authenticity, description, weight, count or measure of any of the lots specified herein.

CATALOG FOR PHOTOCIRCUITS

Lot	Description
3514	Remaining Contents of Room Including But Not Limited To: (1) 8' x 3' Conference Table, (1) Leather Swivel Based Chair, (2) Leather Rolling Chairs, (1) Pneumatic Swivel Based Chair, (4) Stacking Chairs, (1) 2-Drawer Vertical File Cabinet & (1) Cherry Computer Work Station Complete w/ Pull Out Drawer
3515	Furniture Contents of Room Including But Not Limited To: (1) Modular Work Station Complete w/ Left & Right Returns, (1) 60" x 30" Table, (1) 2-Drawer Lateral Wood File Cabinet, (1) 4-Drawer Vertical File Cabinet, (4) 2-Drawer Vertical File Cabinets, (1) 2-Shelf Bookcase, (1) Pneumatically Adjustable Chair, (2) Stationary Chairs
3516	(1) Dell OptiPlex Model GX110 Pentium 3 Computer, Service Tag #6XXP901, Complete w/ CD-ROM, 3.5 Floppy, Keyboard, Mouse, (1) Gem 17" Monitor, (1) Sony Mavica 1.6 Mega Pixel Digital Camera Complete w/ Carry Case & Battery Charger
3517	(1) Dell OptiPlex Model GX270 Model DHM Pentium 4 Computer, s/n 963DW41, Manufacturers Date 05/11/04, Complete w/ CD-ROM, Keyboard, Mouse, (1) Envision 17" Monitor
3518	One Lot of (3) Dell OptiPlex Model 110 Pentium 3 Computer Complete w/ CD-ROM, 3.5 Floppy, (2) Dell 17" Monitors, (1) Gateway Diamondtron 17" Monitor, (2) Keyboards, (3) Mice
3519	Remaining Contents of Office Including But Not Limited To: (2) 16" x 30" 5-Drawer Desks, (1) Computer Work Station, (3) 4-Drawer Vertical File Cabinets, (2) 2-Drawer Vertical File Cabinet, (1) 2-Drawer Lateral File Cabinet, (1) 3-Shelf Wooden Bookcase, (2) Pneumatically Adjustable Swivel Based Chairs
3520	(1) OptiPlex Model GX1 Pentium 3 Computer Complete w/ CD-ROM, 3.5 Floppy, Keyboard, Mouse, (1) Dell 17" Monitor, (1) Hewlett-Packard Laser Jet Model 4050TN Laser Printer
3521	Remaining Contents of Office Including But Not Limited To: (1) Modular Work Station Complete w/ Left & Right Returns & Associated Overhead Cabinetry, (1) 1-Drawer 2-Bay Roll Around Storage Cart, (1) Pneumatically Adjustable Swivel Based Chair, (1) Swivel Based Chair, (1) Stationary Chair
3522	Remaining Contents of Office Including But Not Limited To: (1) 72" x 36" C-Shaped Desk Complete w/ 36" x 24" Left Return & 72" x 24" Rear Return, (1) 2-Drawer Lateral File Cabinet, (1) 2-Drawer Vertical File Cabinet, (1) Executive Machines Model EPS-1501X 15-Sheet Cross Cut Shredder, (3) Pneumatically Adjustable Swivel Based Chairs, (1) 3-Shelf Metal Bookcase
3523	(1) Dell OptiPlex Model 270 Model DHM Pentium 4 Computer Complete w/ CD-ROM, Keyboard, Mouse, (1) Gateway 2000 Model EV700 17" Monitor

This catalog is a guide. The Auctioneers do not warrant the accuracy, genuineness, authenticity, description, weight, count or measure of any of the lots specified herein.

CATALOG FOR PHOTOCIRCUITS

Lot	Description
3524	Remaining Contents of Office Including But Not Limited To: (1) 60" x 30" 5-Drawer Desk, (1) Pneumatically Adjustable Swivel Based Chair, (1) 3-Drawer Lateral File Cabinet, (2) Stacking Stationary Chairs, (1) Folding Table, (1) Dell OptiPlex Model GX Pentium 3 Computer Complete w/ CD-ROM, 3.5 Floppy, Keyboard, Mouse, (1) Dell Trinitron 17" Monitor
3525	Contents of Office Including But Not Limited To: (1) Dell OptiPlex Model GX110 Pentium 3 Computer Complete w/ CD-ROM, 3.5 Floppy, Keyboard, Mouse, (1) Dell 15" Monitor, Speakers, (1) 3 Com Super Stack II Dual Speed 12-Port Hub 500 Model 3C16610, (1) Modular Desk Complete w/ Left Return, (1) 60" x 30" Table, (1) 2-Drawer Lateral File Cabinet, (1) 2-Shelf Bookcase, (3) Pneumatically Adjustable Swivel Based Chairs
3526	Remaining Contents of Office Including But Not Limited To: (1) 72" x 36" C-Shaped Desk Complete w/ 36" x 24" Left Return & 72" x 24" Rear Return, (1) 2-Drawer Lateral File Cabinet, (1) 2-Drawer Vertical File Cabinet, (1) Pneumatically Adjustable Swivel Based Chairs, (1) 3-Shelf Metal Bookcase, (1) 4-Drawer Vertical File Cabinet, (2) Stationary Chairs, (1) Dell OptiPlex Model GX1 Pentium 3 Computer Complete w/ CD-ROM, 3.5 Floppy, Keyboard, Mouse, (1) Dell 17" Monitor
3527	(1) Dell OptiPlex GX270 Model DHM Computer, s/n DS30W41, Date of Manufacturers 05/11/04, Complete w/ CD-ROM, Keyboard, Mouse, (1) Gateway VX1100 21" Monitor, (1) Hewlett-Packard Scanjet Model 5P Flat Bed Scanner, (1) Hewlett-Packard Laser Jet Model 6P Laser Printer
3528	Remaining Contents of Room Including But Not Limited To: (1) 72" x 36" C-Shaped Desk Complete w/ Left Return & (1) 32" x 34" Rear Return, (2) 2-Drawer Lateral File Cabinets, (1) 3-Tier Bookcase, (1) Swivel Based Leather Chair, (2) Stacking Stationary Chairs
3529	(1) Neopost Model IJ65 Postage Meter Complete w/ (1) Neopost Model SE37IJ, 0-5 Lb Scale, (1) Ascom Hasler Model 400 Automatic Letter Opener
3530	(1) Hewlett-Packard Laser Jet 8000N Complete w/ (2) Paper Trays, (1) Hewlett-Packard Laser Jet Model 4050N Laser Printer
3531	One Large Lot of Line Printers Including But Not Limited To: (1) Genicom Model 481E 24" Line Printer, (1) IBM Model 4234 24" Line Printer, (1) IBM Model 5262 24" Line Printer, (1) IBM Model 5360 Process Control Mainframe Complete w/ 2-Slot Diskette Drive & Operators Terminal, (1) Gateway Model P5-120 Pentium Computer Complete w/ (1) Dell 15" Monitor

This catalog is a guide. The Auctioneers do not warrant the accuracy, genuineness, authenticity, description, weight, count or measure of any of the lots specified herein.

CATALOG FOR PHOTOCIRCUITS

Lot	Description
3532	Remaining Contents of Room Including But Not Limited To: (3) Right Multi-Tier Storage Cabinets Complete w/ Roll Up Doors, (1) 5-Shelf Steel Storage Rack, (18) 4-Drawer Vertical File Cabinets, (1) 2-Drawer Lateral File Cabinet, (1) 60" x 30" Table, (1) 60" x 24" Steel Case Credenza, (1) 60" x 30" Steel Case Desk, (1) 2-Drawer Vertical File Cabinet, (1) Roll Around Computer Work Station
3533	Contents of Conference Room Including But Not Limited To: Approximately 9' x 3' Oval Conference Table Complete w/ (9) Swivel Based Chairs, (1) Stationary Chair, (1) 2-Door Cherry Storage Cabinet, (1) 3 Com Super Stack Model 3C16610 Dual Speed Hub #500, (1) Easel
3534	One Lot of (5) 48" Round Tables Complete w/ (25) Stacking Chairs, (1) Folding Cafeteria Table Complete w/ (4) Bench Seats, (1) Folding Table, (1) Sharp Carousel Style Microwave Oven, (1) Panasonic Microwave Oven, (1) Black and Decker Toaster Oven, (1) Trash Can, (1) Water Cooler/Heater
3535	Contents of Office Including But Not Limited To: (1) C-Shaped Modular Desk, (1) 5-Drawer Vertical File Cabinet, (1) Rubbermaid Computer Workstation w/ Pull Out Drawer, (1) Pneumatically Adjusted Swivel Based Chair, (1) Stationary Chair
3536	HP Color LaserJet 2500N Color Laser Printer
3537	Brother Intellifax Model 2750 Plain Paper Laser Fax Machine, (1) HP Model Scanjet ADF Flatbed Scanner
3538	Olympus Model SZ30 0.9-4X Stereo Zoom Microscope Complete w/ X, Y, Axis Base, (1) Kyowa Model SZM Stereo Zoom Microscope, Zoom Range 0.6X - 3X Complete w/ (2) Kyowa 10X/20 Eye Pieces, (2) Eye Pieces
3539	Machida Model FBA-4-60 Closed Circuit Microscope Complete w/ (1) Machida Model RH-150A Light Source
3540	Remaining Contents of Room Including: (3) Modular Workstations Complete w/ Associated Upper and Lower Cabinetry, Partitioning, (4) Pneumatic Swivel Based Chairs, Pneumatic Swivel Lab Chair, (3) Stationary Chairs, 2-Door Storage Cabinet, (2) 2-Door Storage Cabinets, (2) 4-Drawer Vertical File Cabinets, Sharp Carousel Microwave Oven, 60" x 30" Wooden Desk, 2-Drawer Vertical File Cabinet, (1) Folding Table
3542	Furniture Contents of Training Room Including: (5) 72 x 18" Training Tables, (6) 16" x 30" Folding Tables, (8) Pneumatic Swivel Based Chairs w/ Arm Rests, (19) Stacking Stationary Chairs, (1) Folding Chair, (1) Bookcase, (2) Sorters, (1) Whiteboard, (1) Friedrich Air Conditioner
3543	Bretford AV Cart Complete w/ Sharp 27" TV, Brother Intellifax Model 1270 Plain Paper Fax Machine
3544	Dell Optiplex GC260 Model DHM, s/n 6X3WQ11, (8/2002) Pentium IV PC Complete w/ CD Rom, Floppy, Mouse, Keyboard, Gateway Model EV700 17" Monitor
3545	Dell Optiplex GC260 Model GX270, s/n JCVVZ41, (6/2004) Pentium IV PC Complete w/ CDRW, CD Rom, Floppy, Mouse, Keyboard, Dell 17" Monitor

This catalog is a guide. The Auctioneers do not warrant the accuracy, genuineness, authenticity, description, weight, count or measure of any of the lots specified herein.

CATALOG FOR PHOTOCIRCUITS

Lot	Description
3546	HP LaserJet Model 4050TN Printer
3547	Contents of Office Including: (2) 60" x 30" Desks, (3) 60" x 30" Folding Tables, 2-Door Storage Cabinet, 2-Door Vertical File Cabinet, (5) Pneumatic Swivel Based Chairs, (1) Stationary Chair
3548	Contents of (2) Offices Including: (1) 60" x 30" Desk w/ Left Return, (1) 48" x 20" Table, 5-Drawer Vertical File Cabinet, (5) Pneumatic Swivel Based Chairs, Bookcase, (5) Pneumatic Swivel Chairs, 3-Drawer Roll Around Cabinet, 2-Shelf Stainless Steel Metro Cart, (1) 60" x 30" Desk w/ Keyboard Tray, (2) (1) 60" x 30" Tables, (1) 60" x 30" Desk, (3) Sections of Metal Storage Racking
3549	(1) PictureTel Video Conferencing System Complete w/ (1) PictureTel Turret Mounted Video Camera Complete w/ (4) Channel Microphone Receiver Model APTZ-1N, (1)PictureTel Server Model S4000, s/n 87268, Complete w/ S-Video Input, Input Jacks, Output Jacks & Multiple Channel Audio Mixer, (1) PeroVideo Model VID-D 6-Channel Video Distribution Unit, (1) Adtran Model TSU-120E IS-DN Transmitter/Receiver, (1) Ascend Multiband Model VSX Surge Suppression Unit, (1) IR Keyboard & Mouse, (1) PictureTel Model IR KEYPAD-1, (1) Cannon Video Conference Overhead Style Document Projector, (1) Zenith VCR
3550	One Lot of (3) PictureTel Model LAMB-1 Look-At-Me-Button, Part #520-0769-01, Unused In Boxes
3551	One Lot of (2) PictureTel Model LAMB-1 Look-At-Me-Button, Part #520-0769-01, Unused In Boxes
3552	One Lot of (5) PictureTel Model LAMB-1 Look-At-Me-Button, Part #520-0769-01, (1) PictureTel Model IR12 Infrared Receiver Complete w/ S-Video Hook Ups
3555	(1) Gentner 4-Channel Mixing Board Complete w/ Telephone Support
3556	(1) Gentner 4-Channel Mixing Board Complete w/ Telephone Support
3557	(1) Gentner Model AP10 Transmit & Receive Box Complete Telephone Hook Ups & Infrared Remote Control Support
3558	(1) Gentner Model AP10 Transmit & Receive Box Complete Telephone Hook Ups & Infrared Remote Control Support
3559	(1) Shure Model T4N-CE Diversity Receiver Complete w/ (1) Shure Wireless Microphone Set
3560	(1) Peavey Architectural Acoustics Model UMA150TII 4-Channel Mixer/Amplifier
3561	(1) Peavey Architectural Acoustics Model UMA150TII 4-Channel Mixer/Amplifier
3562	(1) Communications Specialties Scan Do Pro Computer To Video Scan Converter
3563	(1) Pro Video Model VID-D 6-Channel Video Distribution Unit, (2) Extron Model SVDA 6 MX S-Video Distribution Amplifier

This catalog is a guide. The Auctioneers do not warrant the accuracy, genuineness, authenticity, description, weight, count or measure of any of the lots specified herein.

CATALOG FOR PHOTOCIRCUITS

Lot	Description
3564	(1) Shure Model AMS8000 8-Channel Automatic Microphone System Mixer Complete w/ (5) Shure Model AMS22 Microphones
3565	(1) Shure Model AMS400 4-Channel Automatic Microphone System Mixer Complete w/ (2) Shure Model AMS22 Microphones
3566	(1) Box of Miscellaneous Microphones & Microphones Stands Complete w/ Associated Cabling
3567	(1) Radio Shack Unidirectional Dynamic Microphone Complete w/ Miscellaneous Cables, Cabling Lengths & Cables
3568	(4) JBL Wall Mounted Approximately 6" Speakers
3569	One Lot of (19) Audio-Tecnicos Model AT935QMRx Gooseneck Microphones Complete w/ Base
3570	(1) Sony Trinitron 36" TV Complete w/ Remote Control
3571	(1) Sony Trinitron 36" TV Complete w/ Remote Control
3572	(1) Sony Trinitron 36" TV Complete w/ Remote Control
3573	(1) Da-Lite Model Versatel Overhead Projection Screen Complete w/ Tripod Style w/ Easel
3574	(1) Approximately 20' Long Modular Octagonal Centerless Table
3575	One Lot of (21) Pneumatically Adjusted Swivel Based Office Chairs Complete w/ Arm Rests
3576	One Lot of (8) Stationary Office Chairs Complete w/ Arm Rests
3577	One Lot of (15) Stacking Office Style Chairs
3578	Remaining Contents of Room Including But Not Limited To: (1) Approximately 8' x 30" Audio Visual Bench Complete w/ Lower Cabinetry, (1) 48" x 30" Cherry Table, (2) Folding Tables, (1) TV Stand & Trash Cans
3579	(1) Dell PowerEdge 4600 Pentium 4 Xeon 1.8 GHz Processor Complete w/ (8) 7310K RPM Ultra SCSI HD's, (2) 36 GB 10K RPM Ultra SCSI HD, Service Tag # 60RKO
3580	(1) Dell PowerEdge 750 Pentium 4 2.8-GHz Processor 1U Server Complete w/ 40 GB Serial ATA 7.2K HD, 512-MB of RAM, Floppy & CD Drive
3583	(1) Dell PowerEdge Model 1650 Dual Pentium 2 1.1-GHz Processor, 1-GB of RAM, 18-Gig HD
3585	(1) Dell PowerEdge Model 1650 Pentium 3 1.2-GHz 1U Server Complete w/ 512-MB of RAM, (2) 146-GB Ultra Scsi HD, (1) 73-Gig Ultra Scsi HD
3586	(1) Dell PowerEdge Model 1650 Pentium 3 1.1-GHz 1U Server Complete w/ 2-GB of RAM, (2) 36-GB Ultra Scsi HD
3587	(1) Dell PowerEdge Model 1650 Pentium 3 1.1-GHz 1U Server Complete w/ 1-GB of RAM, (3) 36-GB Ultra Scsi HD

This catalog is a guide. The Auctioneers do not warrant the accuracy, genuineness, authenticity, description, weight, count or measure of any of the lots specified herein.

CATALOG FOR PHOTOCIRCUITS

Lot	Description
3588	(1) Dell PowerEdge Model 1650 Pentium 3 1.1-GHz 1U Server Complete w/ 4-GB of RAM, (2) 73-GB Ultra Scsi HD
3589	(1) Dell PowerEdge Model 1650 Pentium 3 1.2-GHz 1U Server Complete w/ 512-MB of RAM, (1) 36-GB Ultra Scsi HD
3590	(1) Dell PowerEdge Model 2650 Pentium 4 Xeon 1.8-GHz Processor 3U Server Complete w/ 1-GB of RAM, (5) 73-Gig Ultra Scsi HD's
3591	(1) Dell PowerEdge Model 350 Pentium 3 1-GHz 1U Server Complete w/ 512-MB of RAM, (1) 20-Gig Ultra Scsi HD's
3592	(1) Dell PowerEdge Model 1650 Pentium 3 1.1-GHz 1U Server Complete w/ 1-GB of RAM, (2) 73-Gig 10K Ultra Scsi HD's
3593	(1) Dell PowerEdge Model 1650 Pentium 3 1.1-GHz 1U Server Complete w/ 1-GB of RAM, (1) 36-GB 10K Ultra Scsi HD's
3594	(1) Dell PowerEdge Model 1650 Pentium 3 1.1-GHz 1U Server Complete w/ 1-GB of RAM, (2) 36-GB 10K Ultra Scsi HD's
3596	(1) Dell PowerEdge Model 1650 Pentium 3 1.1-GHz 1U Server Complete w/ 1-GB of RAM, (2) 18-GB 10K Ultra Scsi HD's
3597	(1) Dell PowerEdge Model 1650 Pentium 3 1.1-GHz 1U Server Complete w/ 512-MB of RAM, (2) 36-Gig 10K Ultra Scsi HD's
3598	(1) Dell PowerEdge Model 2650 Pentium 4 Xeon 1.8-GHz Processor Complete w/ 1-GB of RAM, (2) 36-Gig 10K Ultra Scsi HD's
3601	(1) Dell PowerEdge Model 6300 5U Server Complete w/ (4) Pentium 3 Xeon 500-MHz Processors, 4-GB of RAM, (6) 9-Gig Scsi HD's
3602	(1) Dell PowerEdge Model 6300 5U Server Complete w/ (4) Pentium 3 Xeon 550-MHz Processors, 4-GB of RAM, (6) 9-Gig Scsi HD's
3603	(1) Dell PowerEdge Model 6300 5U Server Complete w/ (4) Pentium 3 Xeon 500-MHz Processors, 4-GB of RAM, (8) 18-Gig Ultra 10K Scsi HD's & (2) 36-Gig Ultra 10K Scsi HD's
3604	(1) Dell PowerVault Complete (7) 146-GB 10K Ultra Scsi HD's
3606	(1) Ultrium 2 200/400-GB Tape Back-Up
3607	(1) Certance Ultrium LTO1 100/200-GB Tape Back-Up
3608	(1) Ultrium LTO1 100/200-GB Tape Back-Up

This catalog is a guide. The Auctioneers do not warrant the accuracy, genuineness, authenticity, description, weight, count or measure of any of the lots specified herein.

CATALOG FOR PHOTOCIRCUITS

Lot	Description
3610	(1) Dell 42U 19" Server Cabinet Complete w/ 1 APC Smart-UPS 5000 Battery Back-Up, (1) Black Box Serve Switch 8-Channel KVM Switch
3611	OUT OF SALE
3612	(1) HP K9000 Complete w/ K580 Back, (4) 240-MHz Processors, 1.5-GB RAM, (3) Seagate Model ST318404LC 18-GB HD's, (23) Seagate Model ST3917WC Wide Scsi HD's, (1) DVD Round Drive, (1) GLT4 40/80-GB External Tape Back-Up Drive Complete w/ Hot Swap Expansion Bays & Operators Terminal
3613	(1) HP K9000 Complete w/ (4) 100-MHz Risc Processors, 2-GB RAM, (20) 18-Gig HD's, (1) Seagate 23.4-Gig HD, (1) Overland Data TLT4 800/400-GB, 10-Loader System Complete w/ Associated Storage Expansion Bays & Operator Control Terminal
3614	(1) HP E55 9000 Complete w/ 96-MHz Risc Processor, 128-MB RAM Complete w/ (2) 4-Gig Scsi HD's, (5) 2-Gig Scsi HD's, 1-Gig Scsi HD Complete w/ (1) H-P Power Trust Battery Back-Up & User Control Interface
3615	(1) Gateway ALR 7200 Pentium 2 Server Complete w/ CD, Floppy, Keyboard, Mouse & (1) H-P Model A4575A Monitor
3616	(1) H-P Visualize Model C360 Work Station
3617	(1) H-P Visualize Model C360 Work Station
3618	(1) H-P Visualize Model C360 Work Station Complete w/ CD-ROM
3619	(1) Quantum TLT IV 40/80-GB Tape Back-Up, (1) H-P SureStore Tape 5000, (1) H-P Expansion Bay
3620	(1) MTI 19U Expansion Bay Complete w/ (1) Winchester Systems Flash Disk, Scsi Expansion Box Complete w/ (8) 146-Gig HD's, (1) MDI 3U Scsi Expansion Box Complete w/ (8) 9-Gig Scsi HD's, (1) APC Smart UPS 5000 Battery Back-Up
3623	Remaining Contents of Room Including But Not Limited To: (2) Hayes 33.6 BPS External Modems, (1) 3 Com 12-Port Hub, (1) Comfort-Aire Dehumidifier, (2) Friedrich QuietMaster Air Conditioners, (1) Pneumatically Adjustable Swivel Based Chair, (1) Computer Desk
3624	IT Contents of Cubicle Including But Not Limited To: (38) Dell OptiPlex Model G Series Pentium 3 Computers, Speeds Range from 350MHz-733MHz, Various Memory & HD Sizes, (13) Various Size Monitors & Miscellaneous Keyboards & Mice (Please Inspect)
3625	Contents of Room Including But Not Limited To: Quantity of Computers, Printers, Fax Machines, All-In-One Fax Machines/Printers/Copiers, (3) 48" x 30" Tables, (1) 4-Shelf Bookcase, (1) 2-Drawer Vertical File Cabinet, Please Inspect

This catalog is a guide. The Auctioneers do not warrant the accuracy, genuineness, authenticity, description, weight, count or measure of any of the lots specified herein.

CATALOG FOR PHOTOCIRCUITS

Lot	Description
3626	One Large Lot of Miscellaneous Furniture & Partitioning Including But Not Limited To: (29) Sections of Partitioning, (4) C-Shaped Desks, (2) 60" x 30" Desks w/ Left Returns, (5) Steel Bookcases, (9) Pneumatically Adjusted Swivel Based Chairs, (9) Stationary Chairs, (2) Lounge Chairs, (1) End Table, (1) 30" x 36" Table, (1) 2-Door Storage Cabinet, (1) 4-Drawer Vertical File Cabinet, (1) Quasar Microwave, (1) Toaster Oven
3627	(1) 2-Door Rubbermaid Cabinet & Contents Including But Not Limited To: Miscellaneous Dell Parts, Video Cards, Network Cards, Modems, Hard Drives, Cables, Keyboards, Mice, Miscellaneous Dell Docking Stations, (3) H-P Flat Bed Scanners, (3) Gateway PC's, (2) 4-Shelf Nexel Stainless Steel Racks, (2) Metro 2-Shelf Roll Around Carts
3628	(1) Dell Pentium 4 1.8-GHz Computer Complete w/ 512MB RAM, 20-Gig HD Complete w/ CD, Floppy, Keyboard, Mouse
3629	Remaining Contents of Room Including But Not Limited To: (1) C-Shaped Cherry Desk Complete w/ Upper & Lower Cabinetry, (1) 60" x 30" Cherry Table, (1) 4-Shelf Steel Bookcase, (1) Swivel Based Chair, (1) Stationary Chair, (1) HP 4-Plus Laser Printer Complete w/ Lower Paper Tray
3630	Remaining Contents of Room Including But Not Limited To: (1) Dell PowerEdge 4300 Pentium 3 Server Complete w/ (10) Scsi HD's, (1) Gateway Model ALR 8200 Pentium 2 Server Complete w/ CD, Floppy (1) HP Laser Jet 4100N, (3) HP Laser Jet 5N, (1) HP Laser Jet 6P, Box of 90 Hard Drives, (1) Brother Model MFC 4350 Plain Paper Laser Fax, (5) Pentium Laptops In Various Conditions, (1) Intel Play 60x, 200x Wide Stand Microscope Complete w/ USB Connection, (2) 4-Tier Nexel Stainless Steel Racks
3631	(1) HP Color Jet Model 4550N, (1) HP Color Jet Model 4500N, (1) Epson Model DFX-5000 & 24" Line Printer
3632	(1) Dell OptiPlex Model GX260 Pentium 4 Computer w/ CD-ROM, 3.5 Floppy, Keyboard, Mouse, (1) HP Model AF331D Monitor
3633	Dell Optiplex GX270 Pentium IV PC Complete w/ (2) DVDRW Drives, Floppy, External DVDRW Drive, Keyboard, Mouse, (1) Gateway Model VX1100 21" Monitor
3634	One Lot of (2) Dell and (3) Gateway Pentium II and Pentium III PC's Complete w/ CD's, Floppy's, Keyboard's, Mice, (1) Gateway Model VX1100 Monitor, (2) Dell 17" Monitors
3635	Remaining Contents of Area Including: (1) Approx. 12' x 4' Oval Wooden Conference Table w/ Upper Cabinetry, (1) 2-Door Storage Cabinet w/ Contents Including: Misc. Printer Maintenance Parts, (1) Data Card ImageCard Express Card Printer, (1) 72" x 36" Complete w/ Lower Cabinetry, (1) Ebtech Hot Water Heater/Cooler, (2) Pneumatic Swivel Based Chairs

This catalog is a guide. The Auctioneers do not warrant the accuracy, genuineness, authenticity, description, weight, count or measure of any of the lots specified herein.

CATALOG FOR PHOTOCIRCUITS

Lot	Description
3636	_____ One Lot of (1) Genicom Model 4840E and (1) Genicom Model 4810E 24" Pedestal Mounted Line Printers
3637	_____ Data Max I-Class Label Maker, Model DMX-I-4208
3638	_____ Data Max I-Class Label Maker, Model DMX-I-4208
3639	_____ Intermec Easy Coder Model 4420 Precision Print Thermal Label Printer
3640	_____ Intermec Model 4400 Thermal Label Printer
3641	_____ Intermec Model 4400 Thermal Label Printer
3642	_____ One Lot of (3) Welch Allyn Model Scan Team 5770, Item #5700STD-A Wireless Battery Operated Hand Held Scanner, (1) Welch Allyn Wireless Receiver, (1) Symbol Hot Shots Hand Held Scanners, (1) Quick Scan Hand Held Scanner
3643	_____ HP DesignJet 750C Plus 36" Inkjet Plotter
3643A	_____ Model C4709B HP LaserJet Model 4050 Laser Printer, (1) Brother Intellifax Model 2800 Plain Paper Fax Machine
3644	_____ Dell Model PP01L 750 MHz Laptop Complete w/ 120 MB Ram, 48 GB Hard Drive, w/ Carrying Case, Power Cord, CD, Battery
3645	_____ Dell Latitude CSx Model PMP Pentium III PC w/ Carrying Case, External Floppy/DVD, CDRW, Battery, (1) Xircom Modem/Ethernet Card
3646	_____ Dell Latitude CSx Model PMP Pentium III PC w/ Carrying Case, CD, Battery, (1) Xircom Modem/Ethernet Card
3647	_____ Dell Latitude PCi Model PPL Pentium II 366 MHz, 256 MB Ram, 4 GB Hard Drive, PC w/ Power Supply, CD
3648	_____ Dell Latitude PCi Model PPL Pentium II 366 MHz, 128 MB Ram, 4 GB Hard Drive, PC w/ Power Supply, CD
3649	_____ Dell Latitude PCi Model PPL Pentium II 260 MHz, 128 MB Ram, 4 GB Hard Drive, PC w/ Power Supply, CD
3650	_____ Dell Latitude PCi Model PPL Pentium II 366 MHz, 128 MB Ram, 4 GB Hard Drive, PC w/ Power Supply, CD, w/ Carrying Case
3651	_____ Dell Latitude PCi Model PPL Pentium II 366 MHz, 128 MB Ram, 4 GB Hard Drive, PC w/ Power Supply, CD, w/ Carrying Case
3652	_____ Dell Inspiron Pentium II 300 MHz, 64 MB Ram, 4 GB Hard Drive, PC CD, Floppy, Power Supply, Carrying Case
3653	_____ Infocus Model LP335 Projection Unit Complete w/ Carrying Case, Cable
3654	_____ One Lot of (5) 4-Tier Steel Bookcases w/ (1) 36" x 30" Printing Table

This catalog is a guide. The Auctioneers do not warrant the accuracy, genuineness, authenticity, description, weight, count or measure of any of the lots specified herein.

CATALOG FOR PHOTOCIRCUITS

Lot	Description
3655	_____ Contents of Office Including: (1) C-Shaped Cherry Desk w/ Upper and Lower Cabinetry, (2) Swivel Based Pneumatic Chairs, (3) Stationary Chairs, (1) 3' Round Table
3656	_____ Dell Precision 360 Pentium III PC Complete w/ CD Rom Model DHM, Service Tag # HPXNP51
3657	_____ Dell Precision 360 Pentium III PC Complete w/ CD Rom Model DHM, Service Tag # 4K9M451
3658	_____ Dell Precision 360 Pentium III PC Complete w/ CD Rom Model DHM, Service Tag # 7QXMP51
3659	_____ Dell Optiplex GX270 Pentium IV PC Complete w/ CDRW, Floppy, Service Tag # GJ03F51
3660	_____ Pentium IV PC Complete w/ 2.6 CPU, 256 MB Ram, 40 GB Hard Drive, CD, Floppy, Service Tag # 5YLRB41
3661	_____ Dell Optiplex Model GX260 Pentium IV PC Complete w/ CD, Floppy, Service Tag # 4L4FN11
3662	_____ Remaining Contents of Room Including: V-Shaped Desk w/ Upper and Lower Cabinetry, 4-Drawer Vertical File Cabinet, (2) Steel Bookcases, 8' x 24" Folding Table, Pneumatic Swivel Chair, (2) Stationary Chairs, 2-Door Storage Cabinet, Misc. Computer Hardware
3663	_____ Dell Optiplex GX270 Model DHM Pentium IV PC Complete w/ DVD, Floppy, Keyboard, Mouse, Service Tag# F7B1D31 w/ Dell 15" Monitor
3664	_____ Contents of Room Including: C-Shaped Desk w/ Overhead Cabinetry, Lower Drawers, 48" x 30" Table, Pneumatic Swivel Based Chair, (2) Stationary Chairs
3665	_____ Dell Optiplex Model GX26 2.4 GHz PC w/ (2) 40 GB Hard Drives, DVD/CDRW Floppy, (2) Keyboards, (2) Mice, (1) Gateway Model DX900 Monitor, Dell 17" Monitor, (1) 3Com Super Stack Model 3C16610 12-Port Hub, Misc. APC Surge Protectors, Service Tax # GSR4N21
3666	_____ Contents of Office Including (1) C-Shaped Desk Complete w/ Upper Cabinetry and Lower Drawers, (1) 3-Shelf Steel Bookcase, (1) 4-Shelf Steel Bookcase, (1) Pneumatic Swivel Based Chair, (3) Stationary Chairs
3667	_____ One Lot of (7) Cubicles & Contents Including But Not Limited to: (7) Modular C-Shaped Desks w/ Overhead Cabinetry, (6) Pneumatic Swivel Base Chairs, (6) Stationary Chairs, (5) 4-Drawer Vertical File Cabinets, (1) 3-Shelf Bookcase, (1) Folding Table, (1) 2-Drawer Lateral File Cabinet, (2) Water Coolers, (1) Computer Operator Station, (1) 4-Shelf Bookcase, (1) Haier Dorm Style Refrigerator, (1) Printer Stand, (2) 2-Drawer Vertical File Cabinet w/ Associated Partitions
3668	_____ HP Office Jet Pro 1170Cse Ink Jet Printer/Copier, HP Laser Jet 4050N, Brother IntelliFax Model 2900 Plain Paper Laser Fax Machine
3669	_____ Contents of Back Room Including But Not Limited to: (9) 4-Drawer Vertical File Cabinets, (4) 2-Drawer Vertical File Cabinets, (1) 4-Shelf Bookcase, (1) Folding Table

This catalog is a guide. The Auctioneers do not warrant the accuracy, genuineness, authenticity, description, weight, count or measure of any of the lots specified herein.

CATALOG FOR PHOTOCIRCUITS

Lot	Description
3670	_____ (8) Sections of Office Cubicles, Including But Not Limited to: (9) C-Shaped Modular Desks w/ Upper & Lower Cabinetry, (8) Stationary Chairs, (13) Swivel Base Chairs, (7) 4-Drawer Vertical File Cabinets, (3) 2-Drawer Vertical File Cabinet, (6) Pentium II Computers w/ CD ROM, 3-1/2 Floppy Drive, Monitors, (8) Vertical File Cabinets, (2) 2-Drawer Lateral File Cabinets
3671	_____ (1) HP Color Laser Jet 4600DN Color Laser Printer, (1) HP Laser Jet Model 4050N Laser Jet Printer
3672	_____ (1) HP Color Laser Jet 4650N Color Laser Printer, (1) Brother IntelliFax Model 1270 Plain Paper Fax Machine
3673	_____ (2) Fastback Thermal Report Binders
3674	_____ Contents of (3) Office Including But Not Limited to: (2) C-Shaped Modular Desks w/ Upper & Lower Cabinetry, (14) 4-Drawer Vertical File Cabinet, (1) Folding Table, (12) Swivel Base Chairs, (5) Stationary Chairs, (1) 4-Shelf Bookcase, (2) Pentium III PC's, (2) Monitors,
3675	_____ Dell Optiplex Model GX270 2.8 GHz PC w/ 512 Mg Ram, 48 Hard Drive, CDRW, Service Tag #8S3DW41
3676	_____ (6) Cisco Systems Catalyst 3500 Series XL 48 Port Switches, (1) Cisco Systems Pix Firewall Series Switch, (2) Cisco Systems 2600 Series Switches, (1) Intel Shiva LanRover, (1) Saint Bernard Software ePrism Mail Filter Model M1000, (2) Adtran Model TSU-120E IS-DN Transmitter/Receiver, (1) 3Com Super Stack II Model 3C16610 Dual Speed Hub, (1) Smart-UPS 2200 XL, (2) Cisco Systems Catalyst 3500 Series XL84 Fiber Hubs, (Late Delivery, Removal Date TBD)
3677	_____ Cisco Systems PIX Series Firewall Model PIX-515
3678	_____ Brady Globemark Monocolor Industrial Label Maker Model MGL Complete with Keyboard and Mouse
3678A	_____ Contents of Safety Office Including But Not Limited To: (3) Miller MiniLite Model FL11-3 Fall Limiters, Lanyards, Carabiners, (2) Miller Beam Clamps, (2) Miller MightEvac Model MR50/50' Emergency Self Retracting Life Line, Roof Anchors, Safety Respirators and Filters
3678B	_____ Dell Optiplex GX270 P4 PC Service Tag # 3YLRB41, Complete with CD, Keyboard, Mouse, Dell 15" Monitor, and Hewlett Packard Inkjet Printer
3678C	_____ LaserJet 3700n Color Laser Printer, (1) Brother Intellifax 2750 Laser Plain Paper Fax Machine
3678E	_____ Hewlett Packard Design Jet 750C Plus Ink Jet Plotter
3678F	_____ Misc Safety Test and Measurement Devices Including But Not Limited To: (3) Quest Model Q-200 Noise Dosimeters, (1) Lidbury Ltd. Model FM200 CO2-Halon Liquid Level Indicator, (1) RAE Systems, MultiRAE Plus multi Gas Monitor Model PGM-50, (5) Gastec Manual Gas Sampling Pump, (1) Giliam Air Sampling System, (1) Thermo Model 580 SII Organic Vapor Meter, (2) Buck Primary Gas Flow Calibrations

This catalog is a guide. The Auctioneers do not warrant the accuracy, genuineness, authenticity, description, weight, count or measure of any of the lots specified herein.

CATALOG FOR PHOTOCIRCUITS

Lot	Description
3678G	_____ Remaining Contents of 3rd Floor Including But Not Limited to: (10) Desk Complete with Associated Returns, (8) 5-Drawer Lateral Filing Cabinets, (4) 4-Drawer Lateral Filing Cabinets, Approximately (12) 2-Drawer Vertical Filing Cabinets, (3) Artwork Filing Cabinets, Approximately (20) Pneumatically Adjustable Swivel Based Chairs, Approximately (20) Stationary Chairs
3679	_____ Security Camera System w/ Dedicated Micros 16-Channel Video Switch, (1) Gyr Time Lapse Video Cassette Recorder, (1) Sony Closed Circuit Camera Display, Associated Video Cameras Located Throughout Building 45A
3680	_____ Remaining Contents of Room Including: (3) HP Color Jet 4500 Laser Printers, (3) APC Smart-UPS Model 220XL Battery Backups, APC Smart-UPS 750 Battery Backup, (1) Canon Model PC745 Desktop Copier, Box of Keyboards, (5) Monitors
3681	_____ Skid of Computers, Various Mfgs and Speeds in Various Conditions, Please Inspect
3682	_____ Skid of HP Laser Printers Including: LaserJet 4100N, LaserJet 4000 Plus, LaserJet 5N, LaserJet 2100 TN, (2) LaserJet 4050N, LaserJet 4000N, LaserJet 5M
3683	_____ Skid of (4) Brother Plain Paper Laser Fax Machines, (6) HP Inkjet Printers, (3) Monitors